

2

8

0 300 600 1,200 Feet

# Official Zoning Map

Map prepared by Worcester County Department of Development Review and Permitting, November 3, 2009.  
Source: Worcester County Commissioners.

	A1		RP		R2		I1		C1		V1
	A2		E1		R3		I2		C2		MUN
	CA		R1		R4		CM		C3		

# Tax Map 1

1

3

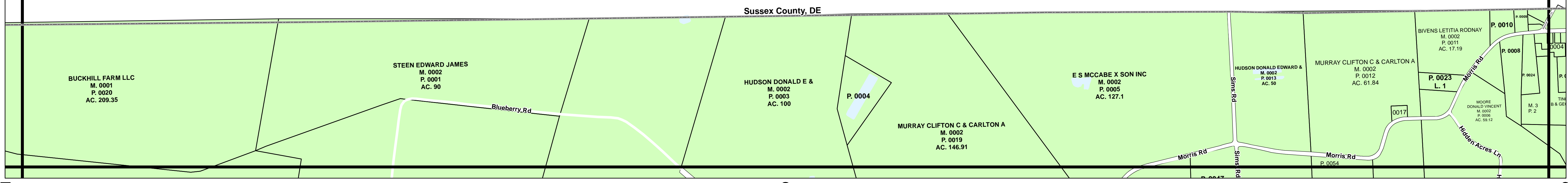

7 8 9



# Official Zoning Map

Map prepared by Worcester County Department of Development Review and Permitting, November 3, 2009.  
 Source: Worcester County Commissioners.

	A1		RP		R2		I1		C1		V1
	A2		E1		R3		I2		C2		MUN
	CA		R1		R4		CM		C3		

# Tax Map 2

2

4

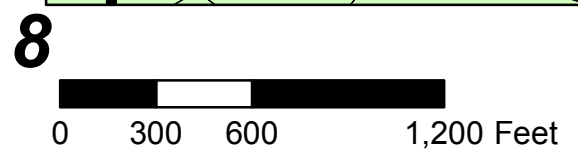
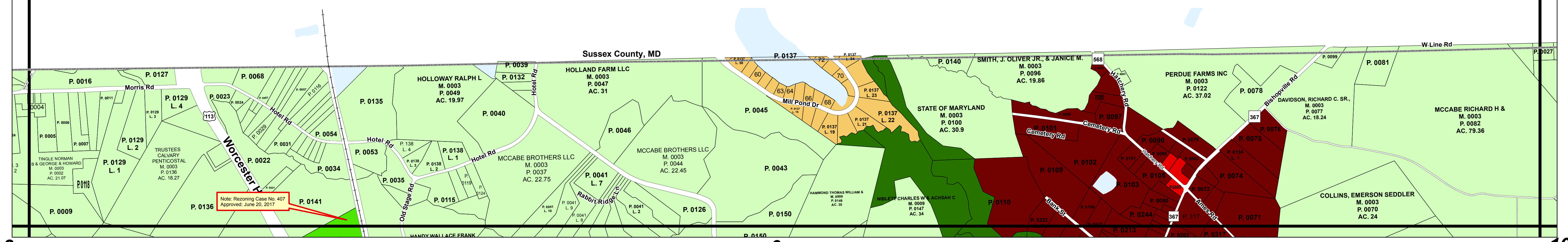

# Official Zoning Map

Map prepared by Worcester County Department of Development Review and Permitting, November 3, 2009.  
 Source: Worcester County Commissioners; UPDATED: Resolution No. 17-02.  
 NOTE: Resolution 17-02 references Map 9, Parcels 301,370 and 379 - Units 1-6 and Map 3, Case No. 407, effective 6/20/17.

A1	RP	R2	I1	C1	V1
A2	E1	R3	I2	C2	MUN
CA	R1	R4	CM	C3	

# Tax Map 3

8

9

10



4

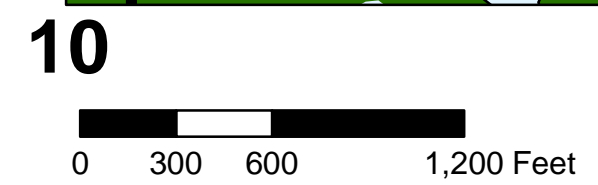
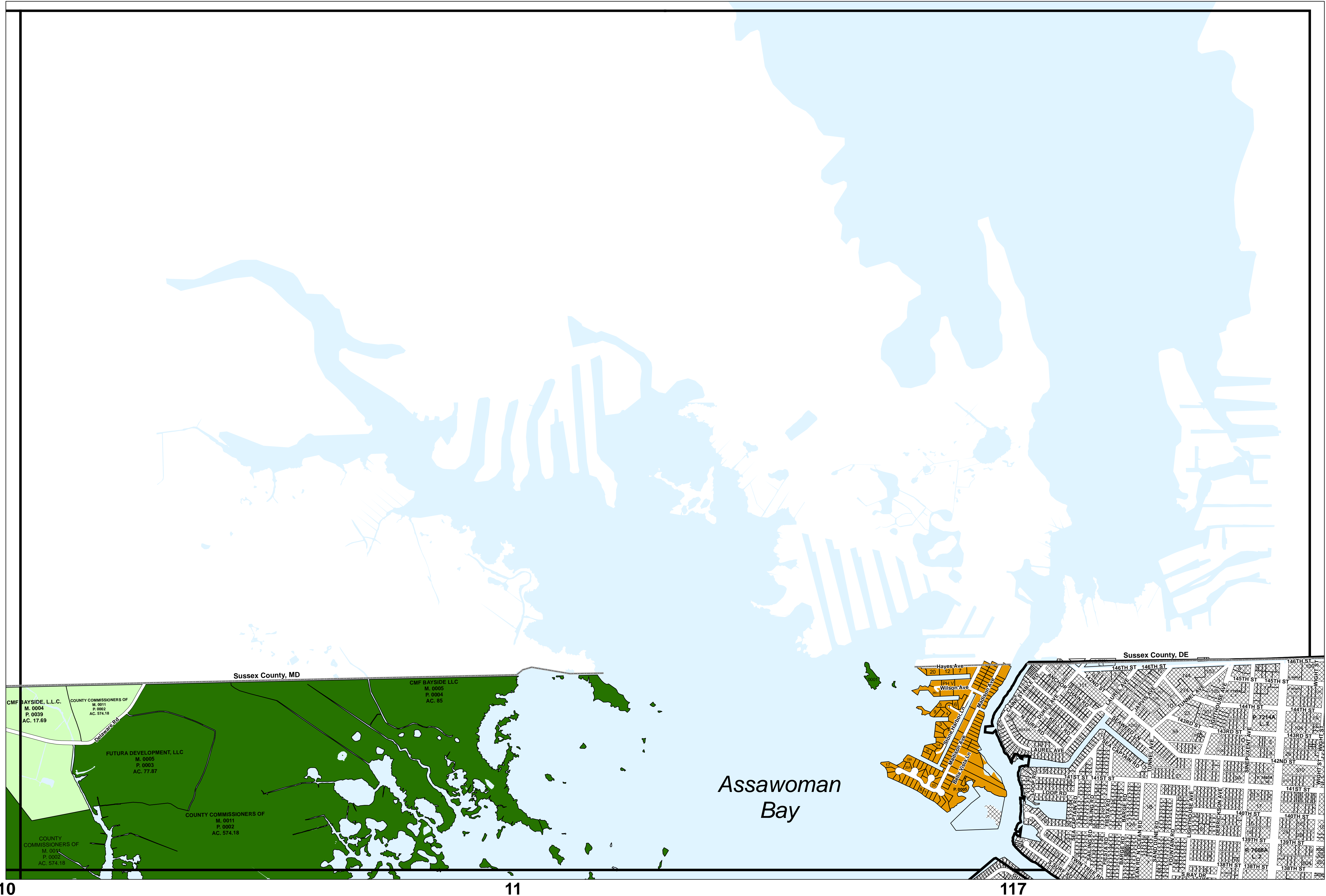

# Official Zoning Map

Map prepared by Worcester County Department of Development Review and Permitting, November 3, 2009.  
 Source: Worcester County Commissioners.

A1	RP	R2	I1	C1	V1
A2	E1	R3	I2	C2	MUN
CA	R1	R4	CM	C3	

# Tax Map 5

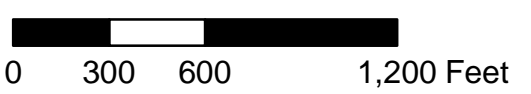
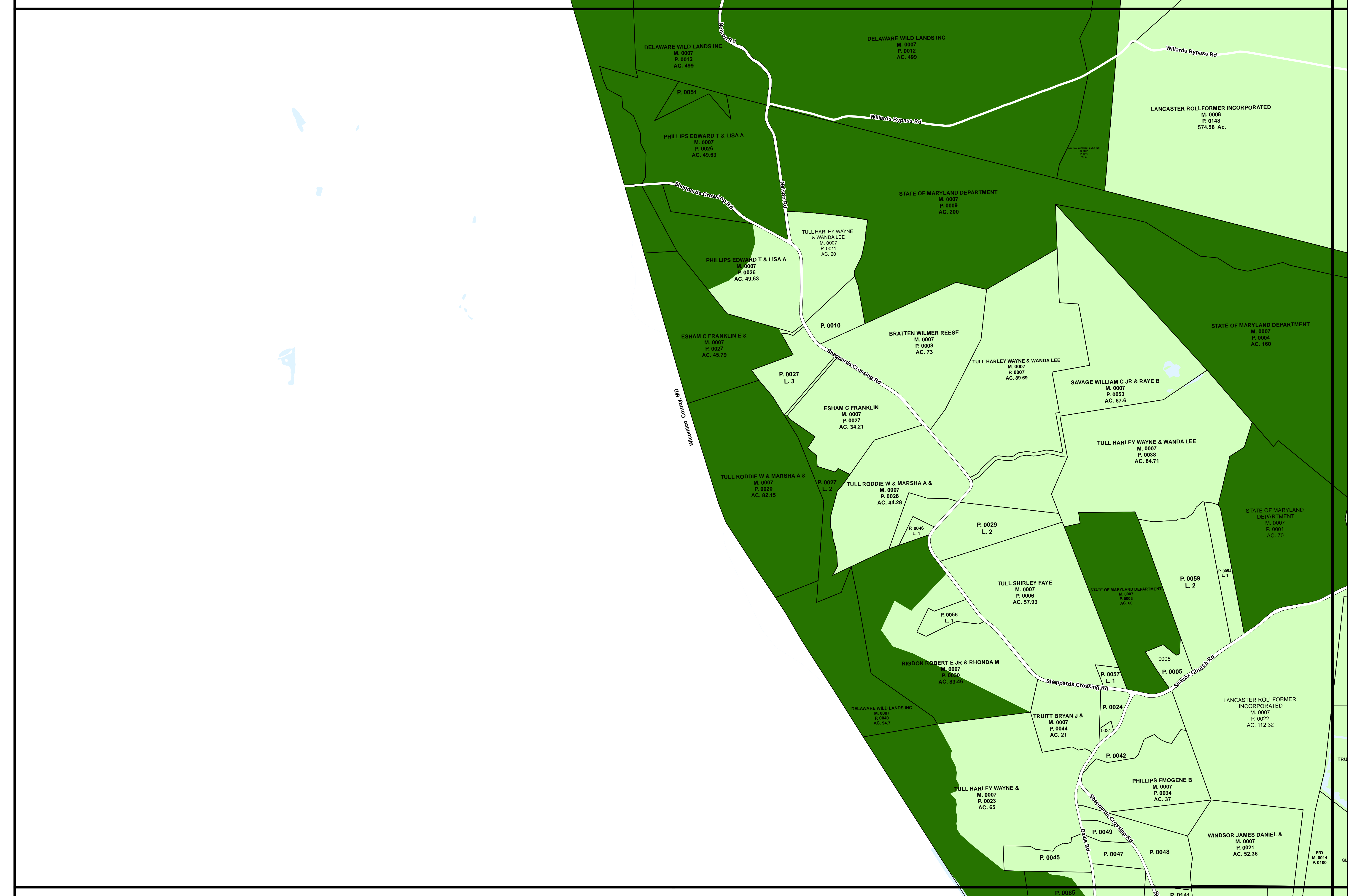

# Official Zoning Map

Map prepared by Worcester County Department of Development Review and Permitting, November 3, 2009.  
 Source: Worcester County Commissioners.

	A1		RP		R2		I1		C1		V1
	A2		E1		R3		I2		C2		MUN
	CA		R1		R4		CM		C3		

# Tax Map 7

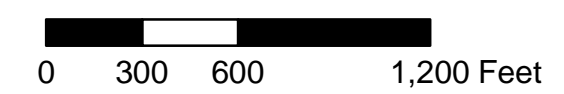
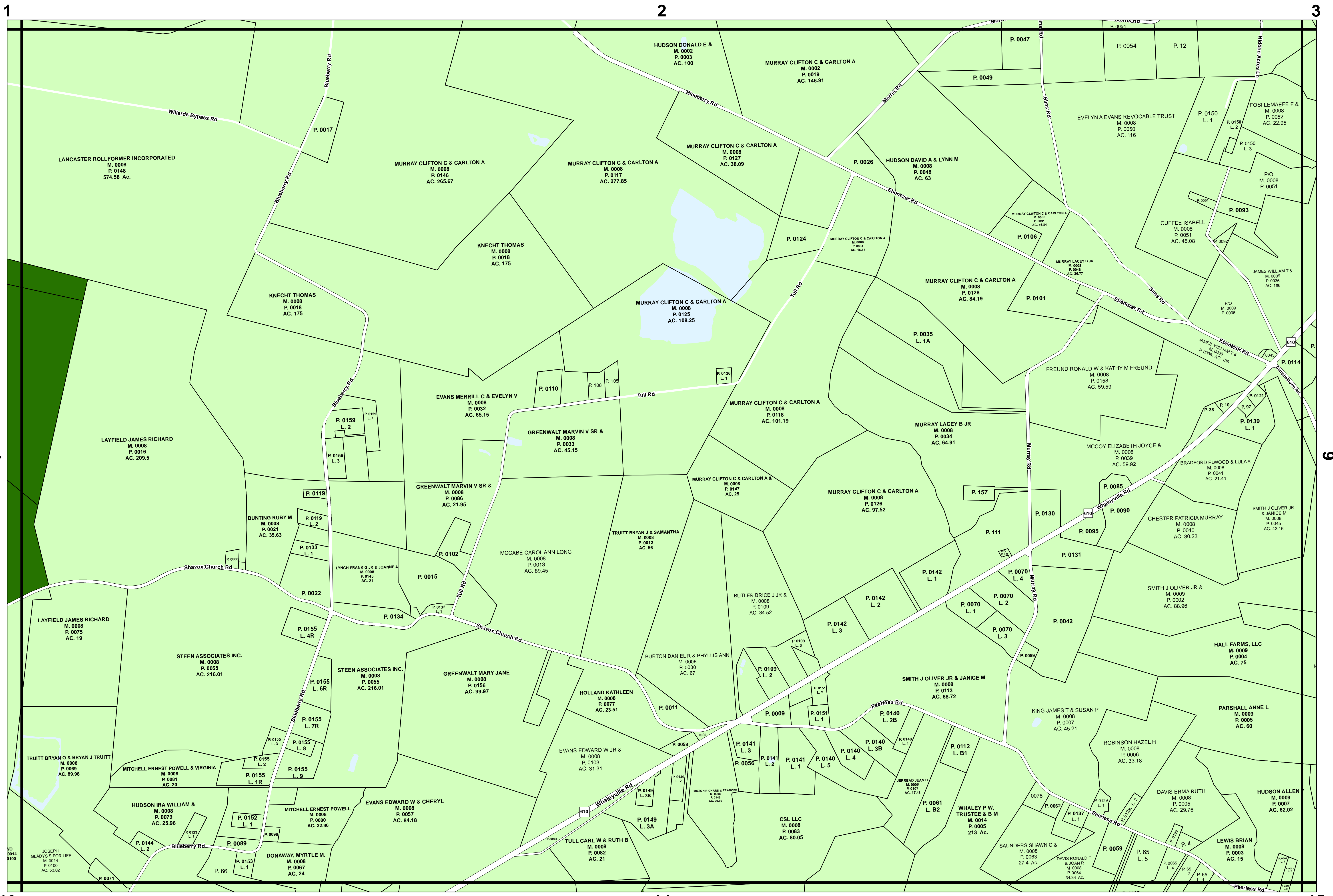

# Official Zoning Map

Map prepared by Worcester County Department of Development Review and Permitting, November 3, 2009.  
 Source: Worcester County Commissioners.

	A1		RP		R2		I1		C1		V1
	A2		E1		R3		I2		C2		MUN
	CA		R1		R4		CM		C3		

# Tax Map 8

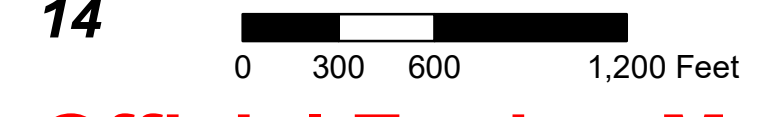
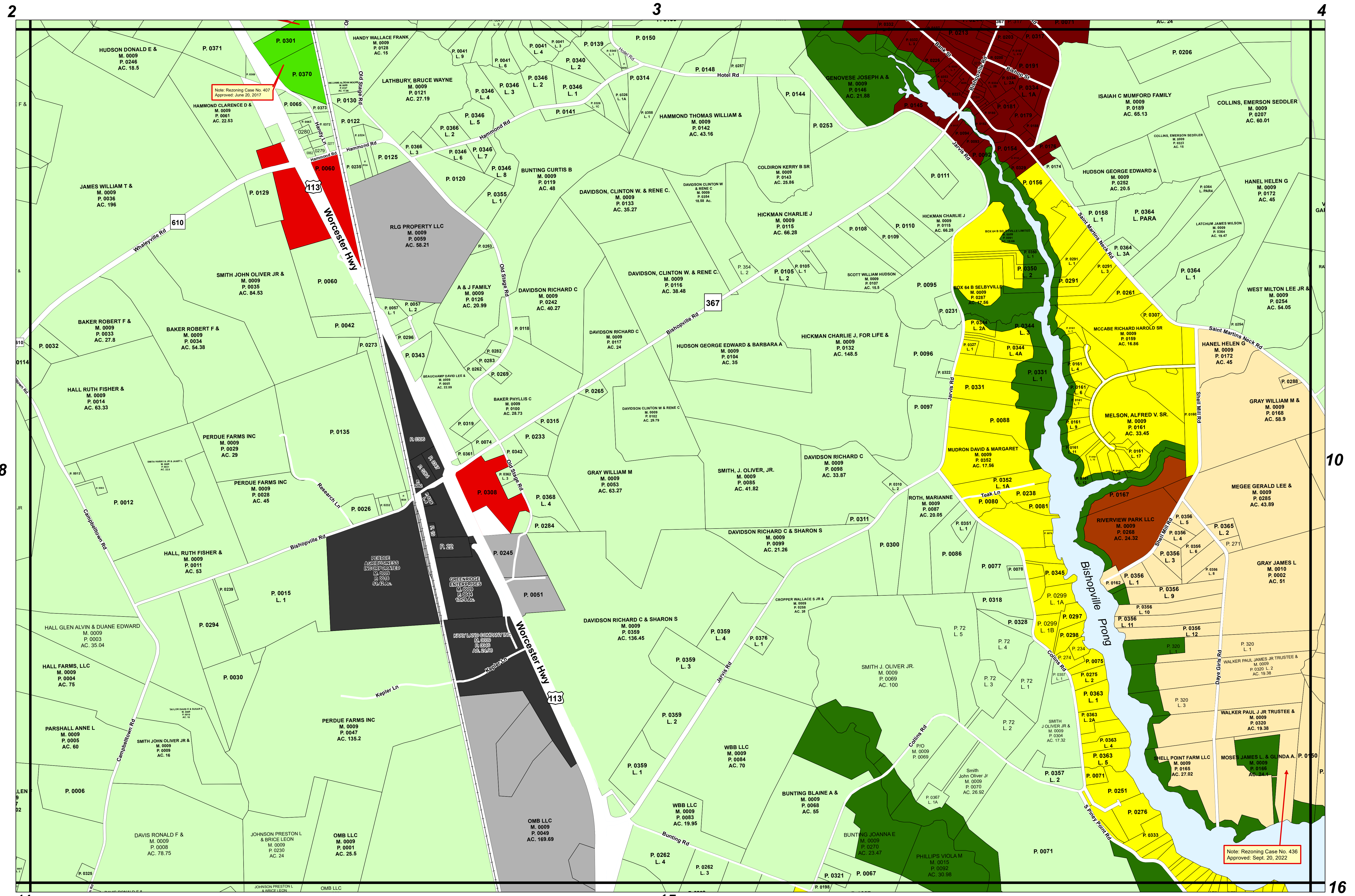

**Official Zoning Map**

Map prepared by Worcester County Department of Development Review and Permitting, November 3, 2009.  
 Source: Worcester County Commissioners; UPDATED: Resolution No. 17-02 and Resolution No. 22-4.  
 NOTE: Resolution 17-02 references Map 9, Parcels 301,370 and 379 - Units 1-6 and Map 3, Case No. 407, effective 6/20/17.  
 Resolution No. 22-4 references Map 9 Parcel 166, Case No. 436, effective 9/20/22.

A1	RP	R2	I1	C1	V1
A2	E1	R3	I2	C2	MUN
CA	R1	R4	CM	C3	

**Tax Map 9**



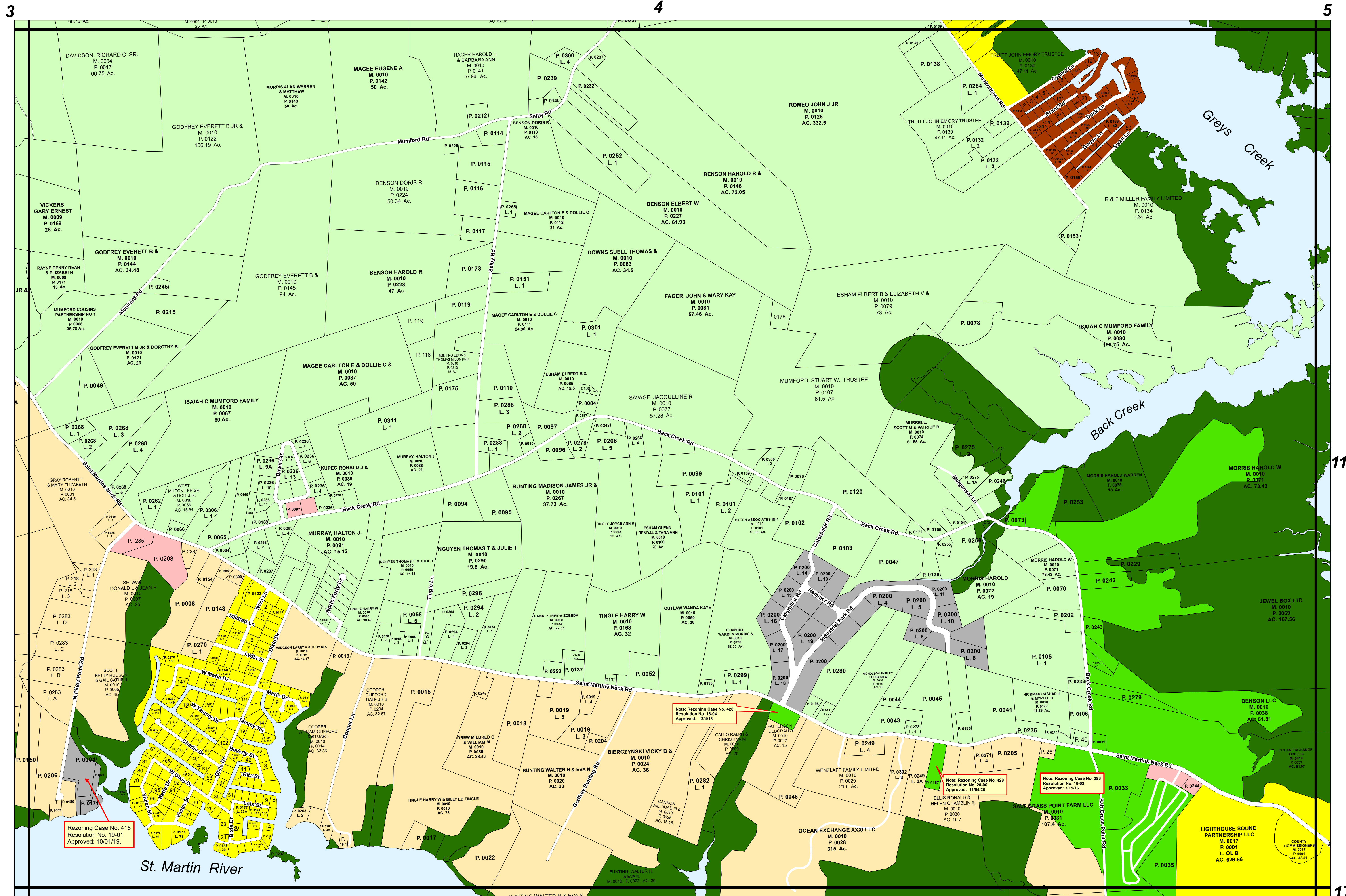

0 300 600 1,200 Feet

# Official Zoning Map

Map prepared by Worcester County Department of Development Review and Permitting, November 3, 2009.  
 Source: Worcester County Commissioners;  
 UPDATED: Resolution No. 16-03, Effective 3/15/16, Case No. 398, Parcel 33;  
 Resolution No. 18-04, Effective 12/04/18, Case No. 420, Parcel 27;  
 Resolution No. 19-01, Effective 10/01/19, Case No. 418, Parcel 4;  
 Resolution No. 20-06, Effective 11/04/20, Case No. 428, Parcel 167.

A1	RP	R2	I1	C1	V1
A2	E1	R3	I2	C2	MUN
CA	R1	R4	CM	C3	

# Tax Map 10