



DEPARTMENT OF
ENVIRONMENTAL PROGRAMS

Worcester County

GOVERNMENT CENTER
ONE WEST MARKET STREET, ROOM 1306
SNOW HILL, MARYLAND 21863
TEL: 410.632.1220 / FAX: 410.632.2012

LAND PRESERVATION PROGRAM
STORMWATER MANAGEMENT
SEDIMENT AND EROSION CONTROL
SHORELINE CONSTRUCTION
AGRICULTURAL PRESERVATION
ADVISORY BOARD

WELL & SEPTIC
WATER & SEWER PLANNING
PLUMBING & GAS
CRITICAL AREAS/FORESTRY
COMMUNITY HYGIENE

May 19, 2022

This notification is to advise you that the Department has received and is presently reviewing the following request for a shoreline construction project:

Linda & Lawrence Prus - Request No. 2022-050 – Request to install 5'x 30' pier, one piling PWC lift, four pilings for future boat lift and four pilings for future dual PWC lift. Maximum channelward extension of 30'. This project is located at 78 Lookout Point, Ocean Pines, also known as Tax Map 16, Parcel 41, Sec 4, Lot 89. Third Tax District of Worcester County, Maryland.

The Department in considering this application will make specific findings of fact with regard to the environmental impact, navigational impact, recreational potential, commercial benefit to Worcester County, impact of the proposed construction upon the surrounding neighborhood and upon property values therein, and any other pertinent issues. Approval from the Department does not guarantee approval from any other applicable regulatory agencies.

If you have an interest which may be adversely affected by the issuance of this permit, you are requested to notify this Department in writing within fifteen (15) calendar days which will end on June 3, 2022.

Sincerely,

Brandy Whitlock
Environmental Inspector

cc: Interested Parties
David Bradford, Deputy Director
File



WORCESTER COUNTY
SHORELINE CONSTRUCTION
APPLICATION

Request No.: 2022-050
Submission Date: 5-19-22

Major Construction (\$300.00) Minor Construction (\$150.00)

Written Description of Proposed Improvement (include channelward distance):

Install 5' x 30' pier - Install 1 piling PWC lift - Install 4 pilings for future boat lift - Install 4 pilings for future dual PWC lift Max Chnl 30'

Property Description:

Map: 0016 Parcel: 0041 Lot: 89 Section: 4 Block: Tax District:

Street Address: 78 Lookout Point Ocean Pines MD 21811

Subdivision: 0004

Dwelling on lot: Dwelling under construction: Vacant: Commercial:

Owner: Linda and Lawrence Prus

Phone No. 860-302-1874

Mailing Address: 78 Lookout Point Ocean Pines MD 21811

E-Mail Address: cindy.lou7809@gmail.com

Contractor: Ocean City Boat Lifts

Phone No.: 410-352-5095

Mailing Address: 12010 Industrial Park Road Unit 11 Bishopville MD 21813

E-Mail Address: oceancitylifts@aol.com

Recorded Adjacent Property Owner: Albert C Blondo Revocable Trust & Patricia H Blondo Revocable Trust

Property Address: 80 Lookout Point Ocean Pines MD 21811

Tax Map: 0016 Parcel: 0041 Lot: 88 Section: 4 Block:

Recorded Adjacent Property Owner: Carey L Cox Recovable Trust

Property Address: 76 Lookout Point Ocean Pines MD 21811

Tax Map: 0016 Parcel: 0041 Lot: 90 Section: 4 Block:

As the applicant, I attest that the information presented on this application, site plan and any written documentation attached hereto is known to be accurate. I understand that the proposed shoreline improvement will be constructed to meet or exceed minimum design standards adopted by the Department. Any deviation from these standards will require construction plans sealed by an engineer registered in the State of Maryland. I acknowledge that any falsification of information presented may result in revocation of this approval and of the subsequent Shoreline Construction Permit.

Linda Prus
Owner/Applicant's Signature

05-10-2022
Date

DEPT. USE ONLY:

Notification Distribution Date: 5-19-22 Public Comment Deadline: 6-3-22 (15 calendar days)

Department Approval Date: Expiration:

No Known SAV
 Apx. 2,800 ft to opposing
 shoreline
 North Arrow

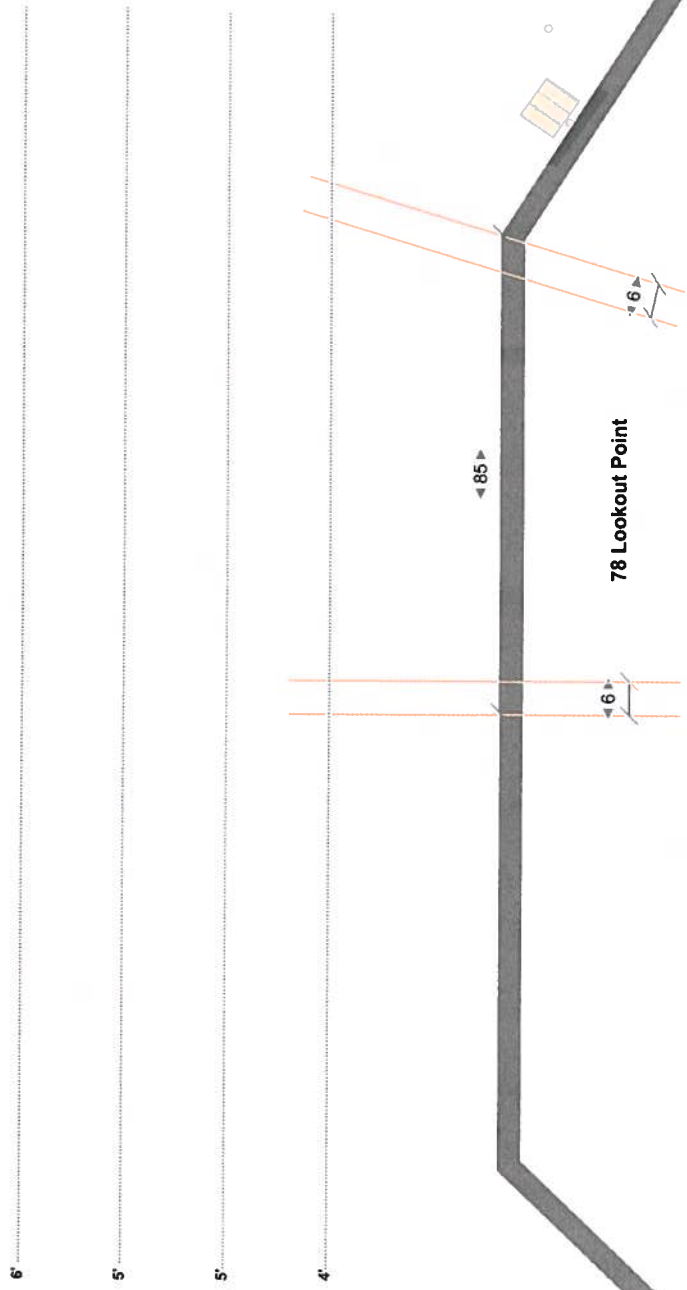

Site: **78 Lookout Point Ocean Pines**
 Work: Install 5' x 30' Pier - Install PWC Lift -
 Install 4 pilings for future boat lift -
 Install 4 piling for future dual PWC lift

Customer:
Prus
 Scale:
1/32" = 1'0"

Project:
Existing
 Date:
05/10/2022

Drawn:
K. Short
 Page:
1 of 3

443-614-8477
 Pristine
 Permitting
 @AOL.com

Pristine Permitting
 12010 Industrial Park RD
 Unit 11
 Bishopville MD 21813

No Known SAV
 Apx. 2,800 ft to opposing
 shoreline
 North Arrow

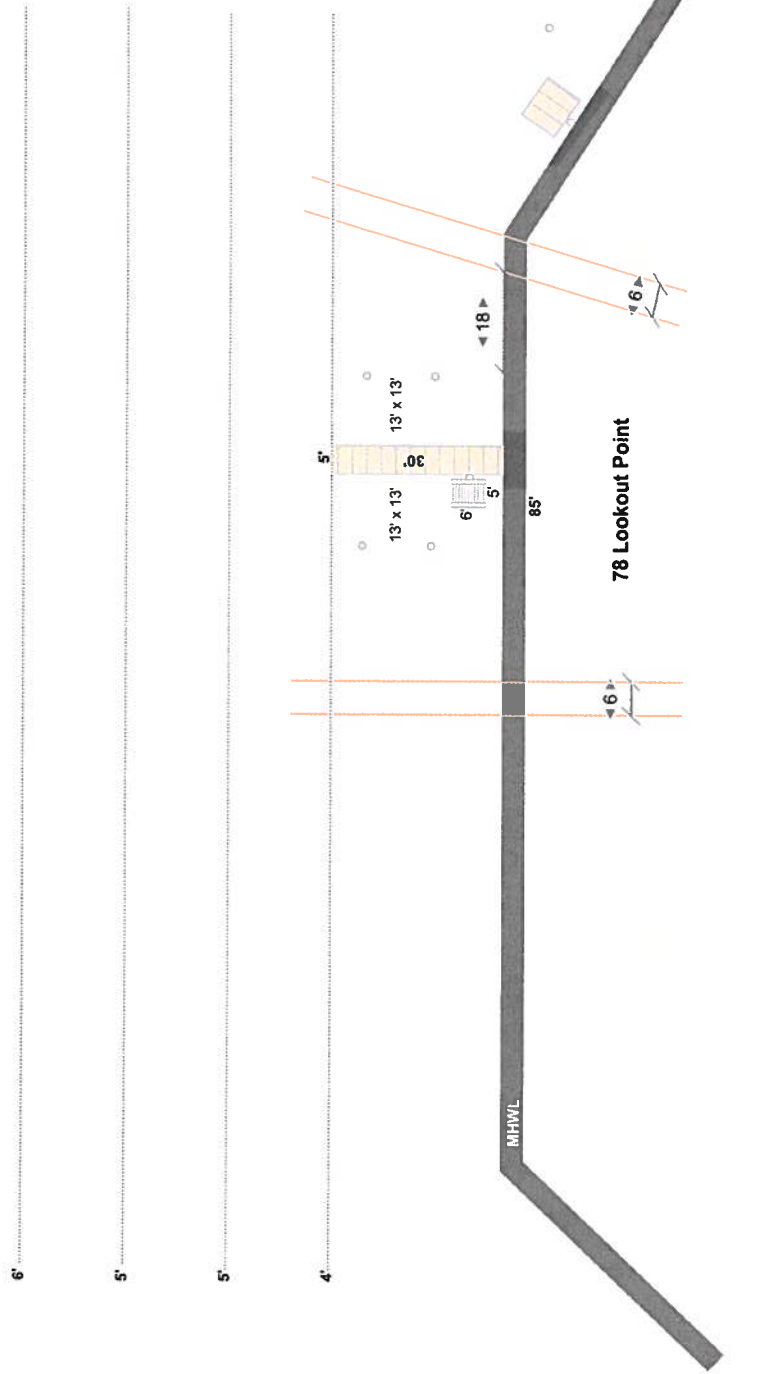

<p>Site: 78 Lookout Point Ocean Pines</p> <p>Work: Install 5' x 30' Pier - Install PWC Lift - Install 4 pilings for future boat lift - Install 4 piling for future dual PWC lift</p>	<p>Customer: Prus</p> <p>Scale: 1/32" : 1'0"</p>	<p>Project: Proposed</p> <p>Date: 05/10/2022</p>	<p>Drawn: K. Short</p> <p>Page: 2 of 3</p>	<p>443-614-8477 Pristine Permitting @AOL.com</p>	<p>Pristine Permitting 12010 Industrial Park RD Unit 11 Bishopville MD 21813</p>
---	--	--	--	--	---

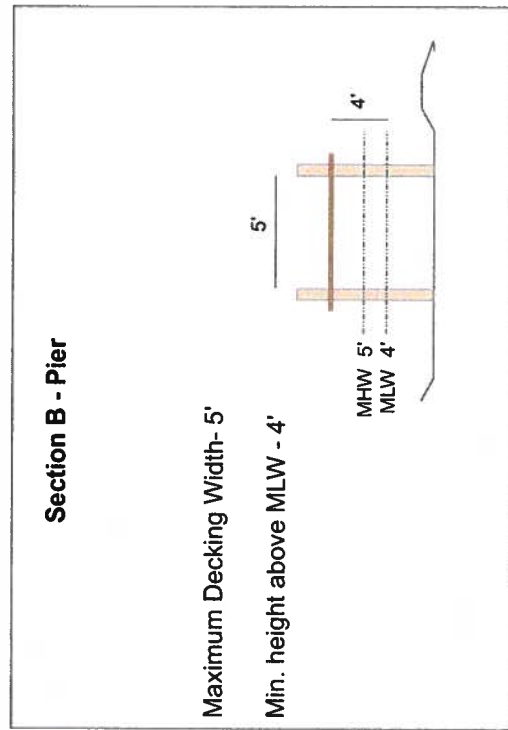
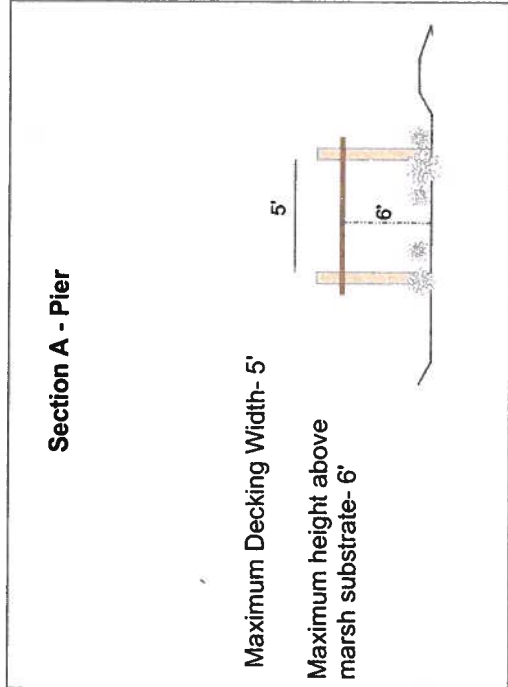
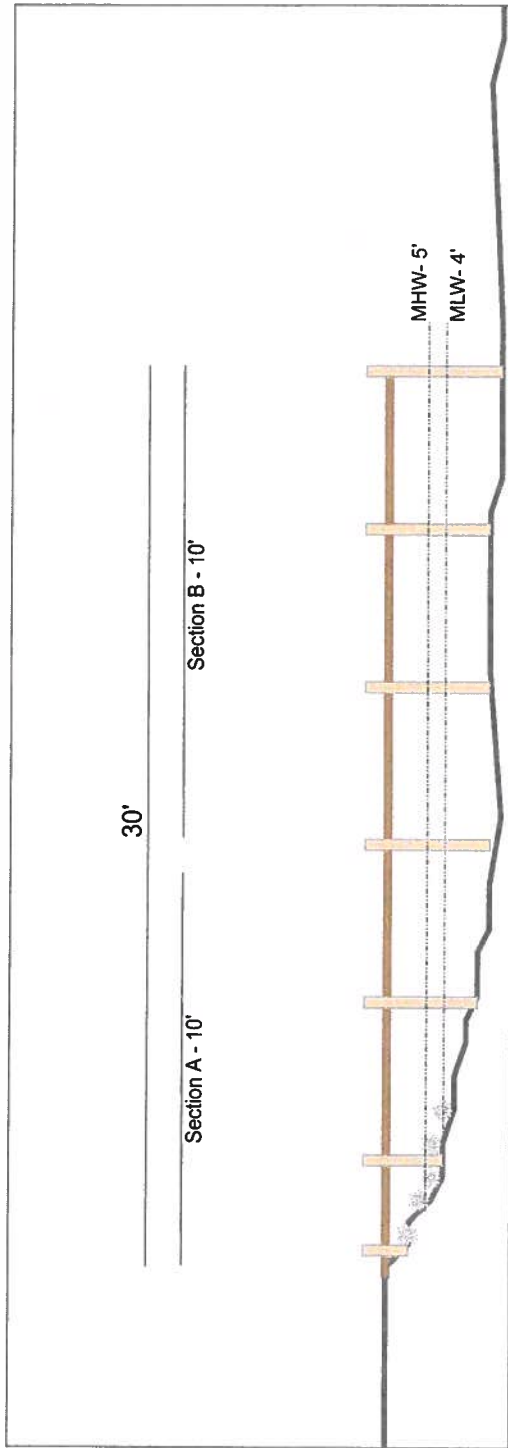

Site:	78 Lookout Point Ocean Pines MD	Drawing:		Project:	Cross Section	Drawn:	K. Short	Contact:	Pristine Permitting 12010 Industrial Park Road Unit 11, Bishopville MD 21813
Title:	Prus	Scale:		Date:	05/10/2022	Page:	3	pristinepermitting@aol.com	



