



DEPARTMENT OF  
ENVIRONMENTAL PROGRAMS

**Worcester County**

GOVERNMENT CENTER  
ONE WEST MARKET STREET, ROOM 1306  
SNOW HILL, MARYLAND 21863  
TEL: 410.632.1220 / FAX: 410.632.2012

LAND PRESERVATION PROGRAM  
STORMWATER MANAGEMENT  
SEDIMENT AND EROSION CONTROL  
SHORELINE CONSTRUCTION  
AGRICULTURAL PRESERVATION  
ADVISORY BOARD

WELL & SEPTIC  
WATER & SEWER PLANNING  
PLUMBING & GAS  
CRITICAL AREAS/FORESTRY  
COMMUNITY HYGIENE

March 12, 2024

This notification is to advise you that the Department has received and is presently reviewing the following request for a shoreline construction project:

Dave Gordon– Request No. 2024-022 - Request to install two – 27' stone sills. Fill behind the sills with clean sand and plant appropriate marsh grasses. Maximum channelward distance not to exceed 12'. This project is located at 12377 Hidden Bay Dr, Berlin, also known as Tax map 33, Parcel 281, Lot 45. Tenth Tax District of Worcester County, Maryland.

The Department in considering this application will make specific findings of fact with regard to the environmental impact, navigational impact, recreational potential, commercial benefit to Worcester County, impact of the proposed construction upon the surrounding neighborhood and upon property values therein, and any other pertinent issues. Approval from the Department does not guarantee approval from any other applicable regulatory agencies.

**If you have an interest which may be adversely affected by the issuance of this permit, you are requested to notify this Department in writing within fifteen (15) calendar days which will end on March 27, 2024.**

Sincerely,

Brandy Whitlock  
Environmental Inspector

cc: Interested Parties  
David Bradford, Deputy Director  
File



WORCESTER COUNTY  
SHORELINE CONSTRUCTION  
APPLICATION

Request No.: 2024 - 022  
Submission Date: 3-12-24

☒ Major Construction (\$300.00)

☐ Minor Construction (\$150.00)

**Written Description of Proposed Improvement (include channelward distance):**

Install two (2) 27' Stone sills. Fill behind the sills with clean sand and plant appropriate marsh grasses. Maximim channel ward extension of 12'.

Map: 0033 Parcel: 0281 Lot: 45 Section: \_\_\_\_\_ Block: \_\_\_\_\_ Tax District: \_\_\_\_\_  
Street Address: 12377 Hidden Bay Drive, Berlin, MD 21811  
Subdivision: \_\_\_\_\_  
Dwelling on lot: ☒ 3027 Dwelling under construction: \_\_\_\_\_ Vacant: \_\_\_\_\_ Commercial: \_\_\_\_\_

Owner: Dave Gordon Phone No. 301-748-1336  
Mailing Address: 12377 Hidden Bay Drive, Berlin, MD 21811  
E-Mail Address: dg1336@outloo.com

Contractor: Newport Bay Marine Construction Phone No.: 724-372-3201  
Mailing Address: South Main St., Berlin, MD 21811  
E-Mail Address: info@newportconstruction.com

Recorded Adjacent Property Owner: Stephen Pawlowski  
Property Address: 12375 Hidden Bay Drive, Berlin, MD 21811 - 132 Greentree Farm Dr  
Tax Map: 0033 Parcel: 3027 Lot: 44 Section: \_\_\_\_\_ Block: \_\_\_\_\_ Dickerson, MD 20842

Recorded Adjacent Property Owner: Ron Gorfinkel  
Property Address: 12379 Hidden Bay Drive, Berlin, MD 21811  
Tax Map: 0033 Parcel: 3027 Lot: 46 Section: \_\_\_\_\_ Block: \_\_\_\_\_

As the applicant, I attest that the information presented on this application, site plan and any written documentation attached hereto is known to be accurate. I understand that the proposed shoreline improvement will be constructed to meet or exceed minimum design standards adopted by the Department. Any deviation from these standards will require construction plans sealed by an engineer registered in the State of Maryland. I acknowledge that any falsification of information presented may result in revocation of this approval and of the subsequent Shoreline Construction Permit.

Dave Gordon / R. Gordon P.O.A.  
Owner/Applicant's Signature Date:

\*\*\*\*\*

DEPT. USE ONLY:

Notification Distribution Date: 3-12-24 Public Comment Deadline: 3-27-24 (15 calendar days)  
Department Approval Date: \_\_\_\_\_ Expiration: \_\_\_\_\_

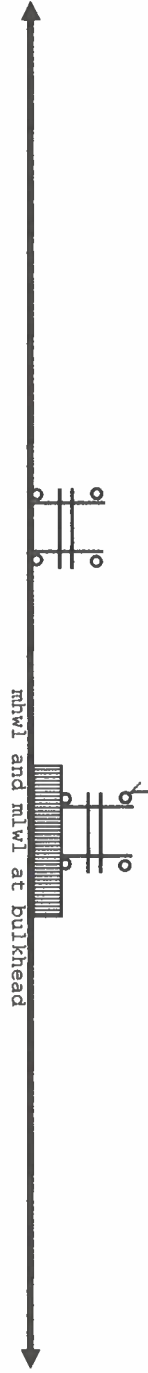
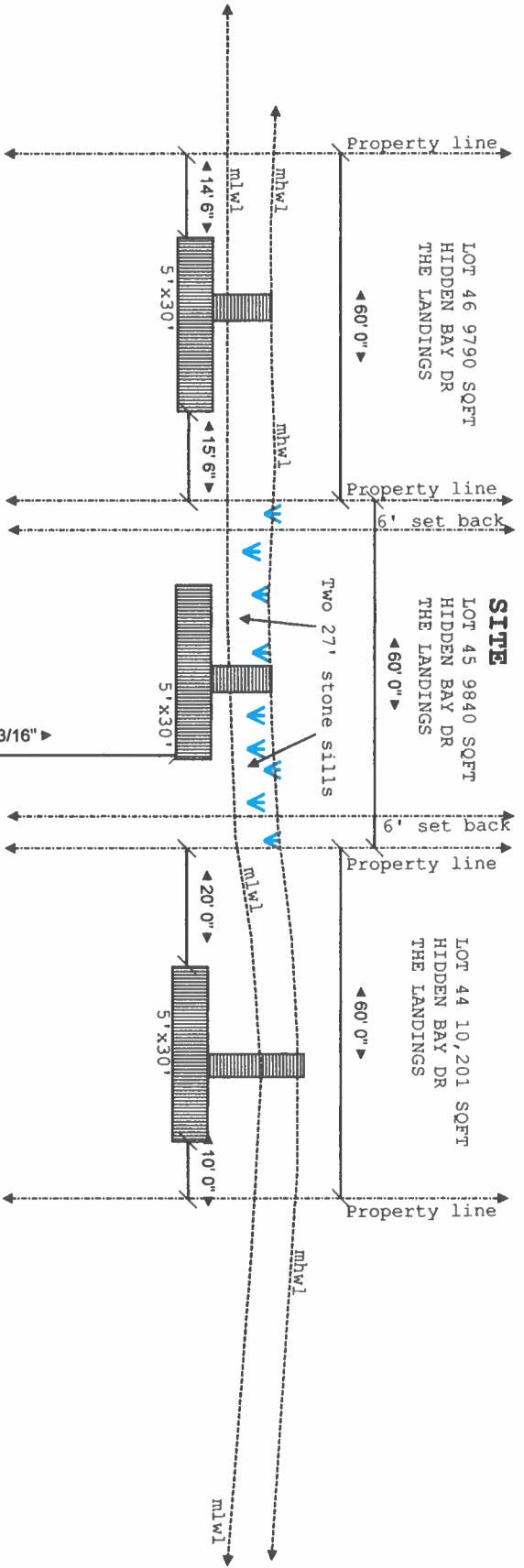

- NOTES**
1. There are no known SAV beds in the area.
  2. The soundings were taken on 06/27/2023.
  3. The maximum channelward extension is 12'.
- SCOPE**
- Install two (2) 27' stone sills. Fill behind the sills with clean sand and plant appropriate marsh grasses. Max channelward extension of 12'.

Site:	12377 Hidden Bay Drive, OC MD	Drawing:	1	Project:	Gordon	Drawn:	Carouge	Notes:	Hidden Oak Farms, LLC
Title:	PROPOSED CONDITIONS	Scale:	1/2"=15'0"	Date:	12/25/2023	Rev:	A		

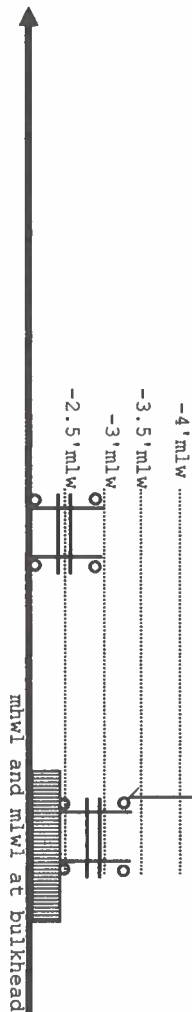

◀ 63' 11 3/16" ▶

To: Sineuxent Bay

1. There are no known SAV beds in the area.
2. The soundings were taken on 06/27/2023.
3. The maximum channelward extension is 12'.

Install two (2) 27' stone sills. Fill behind the sills with clean sand and plant appropriate marsh grasses. Max channelward extension of 12'.

Site:	12377 Hidden Bay Drive, OC MD		Drawing:	1	Project:	Gordon	Drawn:	Carouge	Notes:	Hidden Oak Farms, LLC
Title	DEPTHS		Scale:	1/2"=15'0"	Date:	12/25/2023	Rev:	A		

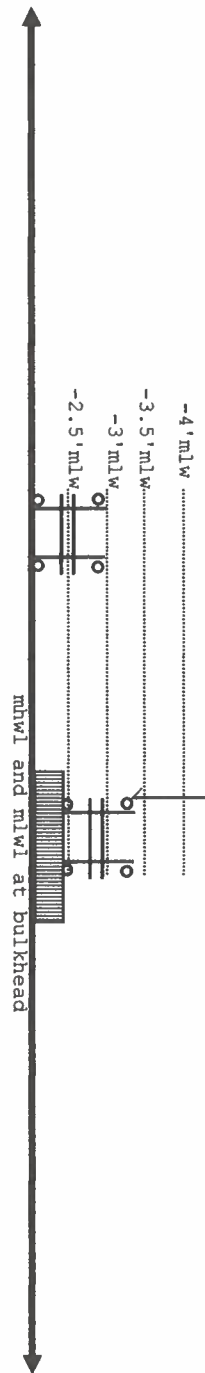
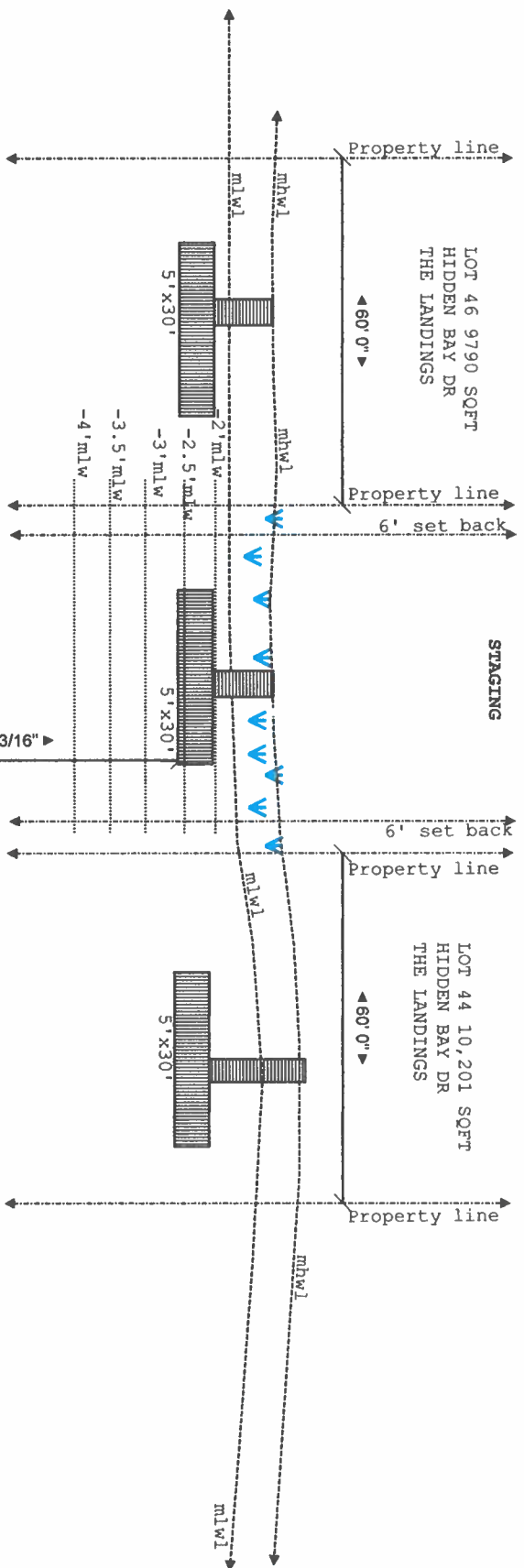

**NOTES**

1. There are no known SAV beds in the area.
2. The soundings were taken on 06/27/2023.
3. The maximum channelward extension is 12'.

**SCOPE**

Install two (2) 27' stone sills. Fill behind the sills with clean sand and plant appropriate marsh grasses. Max channelward extension of 12'.

Site:	12377 Hidden Bay Drive, OC MD	Drawing:	1	Project:	Gordon	Drawn:	Carouge	Notes:	Hidden Oak Farms, LLC
Title:	STAGING AREA	Scale:	1/2"=15'0"	Date:	12/25/2023	Rev:	A		

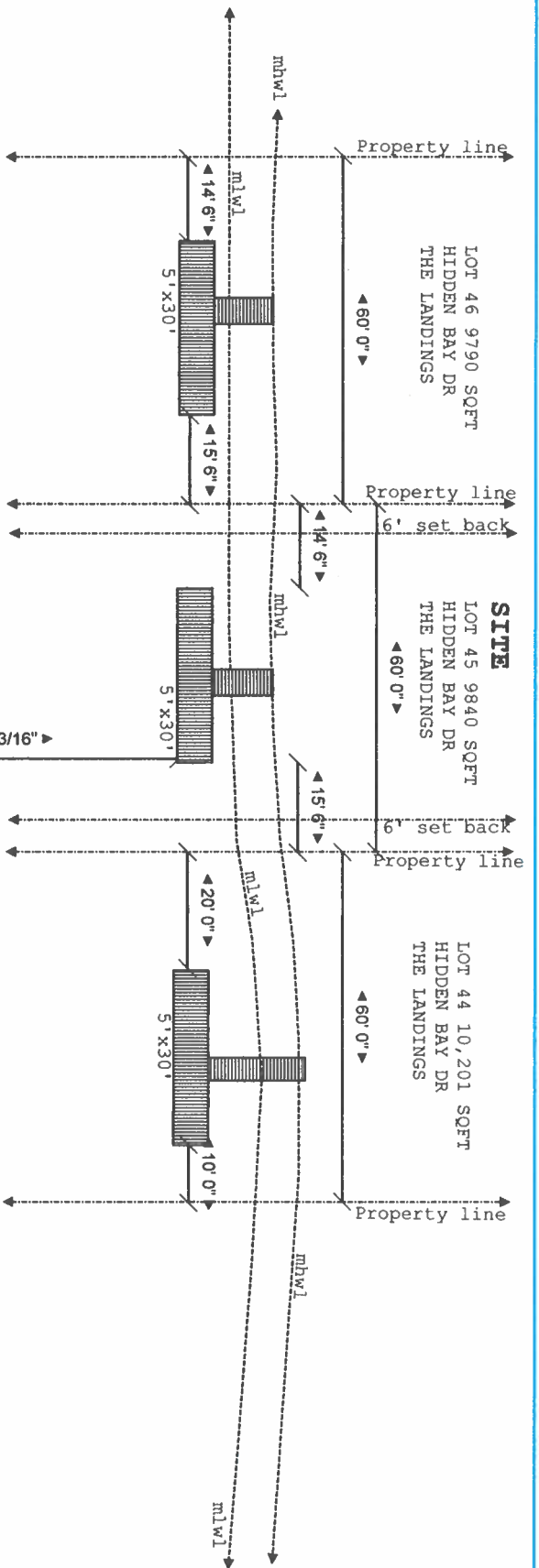

#### NOTES

1. There are no known SAV beds in the area.
2. The soundings were taken on 06/27/2023.
3. The maximum channelward extension is 12'.

#### SCOPE

Install two (2) 27' stone sills. Fill behind the sills with clean sand and plant appropriate marsh grasses. Max channelward extension of 12'.

Site:	12377 Hidden Bay Drive, OC MD	Drawing:	1	Project:	Gordon	Drawn:	Carouge	Notes:	Hidden Oak Farms, LLC
Title:	EXISTING CONDITIONS	Scale:	1/2"=15'0"	Date:	12/25/2023	Rev:	A		

12377 Hidden Bay Drive  
Berlin, MD

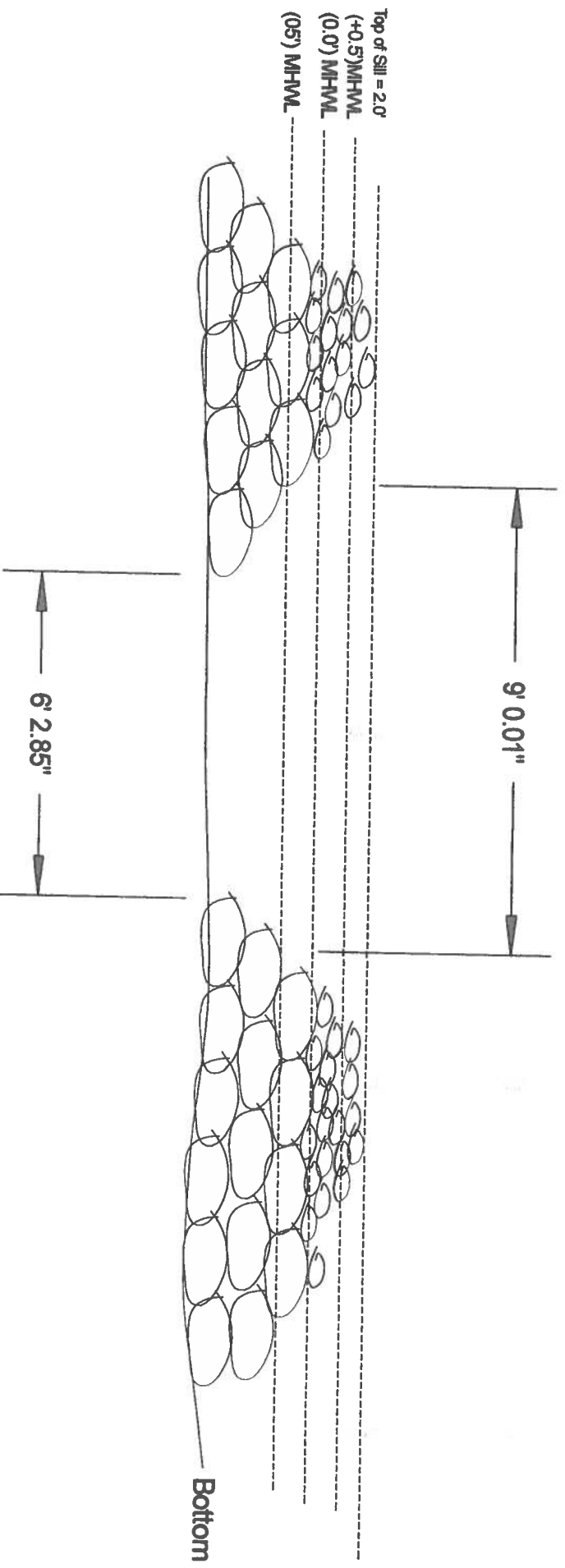

Min. 6' @ MLW

Scale: 1" = 3'

# 12377 Hidden Bay Drive Berlin, MD

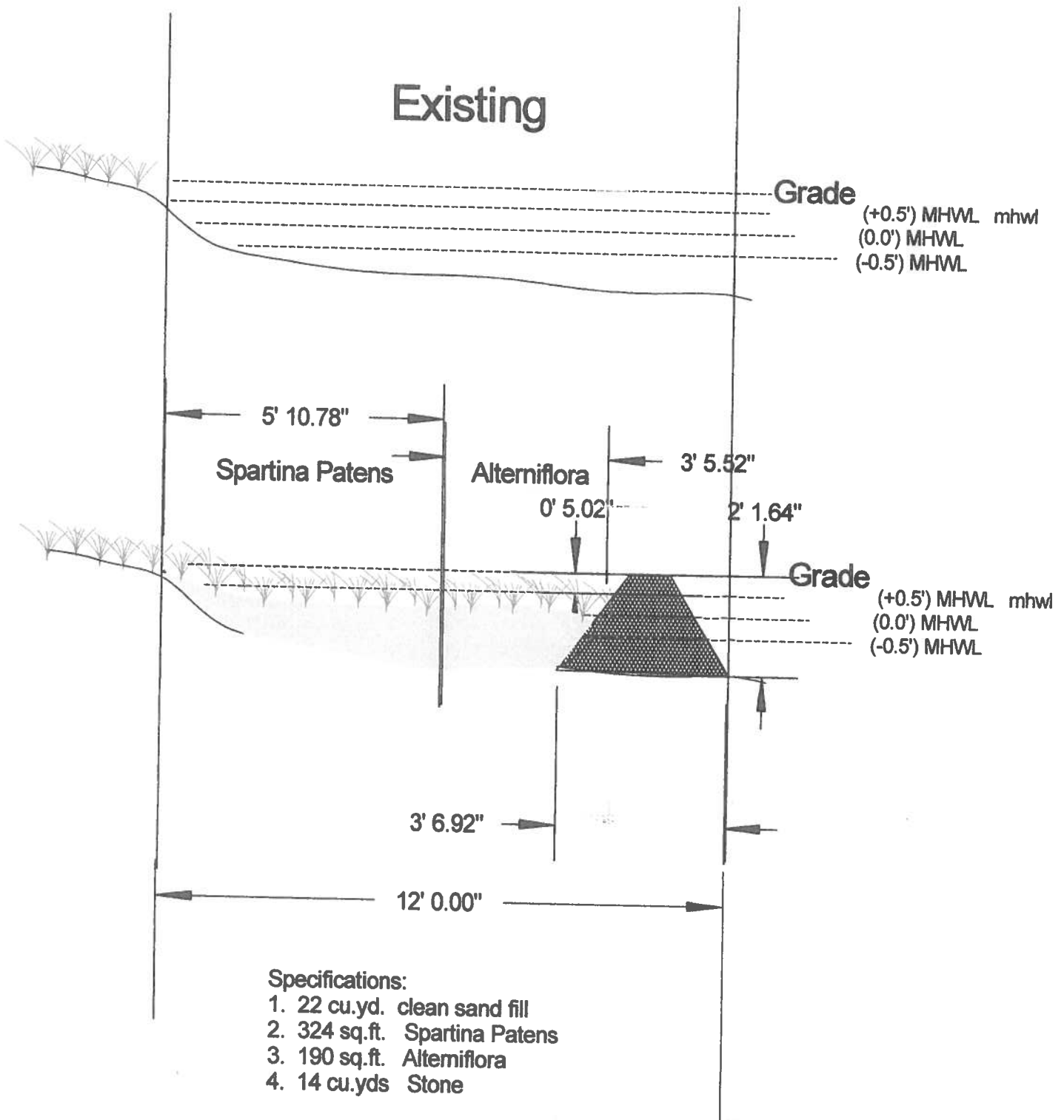

Scale: 1" = 3'





