



DEPARTMENT OF
ENVIRONMENTAL PROGRAMS

Worcester County

GOVERNMENT CENTER
ONE WEST MARKET STREET, ROOM 1306
SNOW HILL, MARYLAND 21863
TEL: 410.632.1220 / FAX: 410.632.2012

LAND PRESERVATION PROGRAM
STORMWATER MANAGEMENT
SEDIMENT AND EROSION CONTROL
SHORELINE CONSTRUCTION
AGRICULTURAL PRESERVATION
ADVISORY BOARD

WELL & SEPTIC
WATER & SEWER PLANNING
PLUMBING & GAS
CRITICAL AREAS/FORESTRY
COMMUNITY HYGIENE

March 12, 2024

This notification is to advise you that the Department has received and is presently reviewing the following request for a shoreline construction project:

Leonard Smith– Request No. 2024-023 - Request to install 90' of replacement vinyl bulkhead. Maximum channelward distance not to exceed 1.5'. This project is located at 536 Yacht Club Dr, Berlin, also known as Tax map 16, Parcel 14, Lot 4. Third Tax District of Worcester County, Maryland.

The Department in considering this application will make specific findings of fact with regard to the environmental impact, navigational impact, recreational potential, commercial benefit to Worcester County, impact of the proposed construction upon the surrounding neighborhood and upon property values therein, and any other pertinent issues. Approval from the Department does not guarantee approval from any other applicable regulatory agencies.

If you have an interest which may be adversely affected by the issuance of this permit, you are requested to notify this Department in writing within fifteen (15) calendar days which will end on March 27, 2024.

Sincerely,

Brandy Whitlock
Environmental Inspector

cc: Interested Parties
Joy S. Birch
File



WORCESTER COUNTY
SHORELINE CONSTRUCTION
APPLICATION

Request No.: 2024-023
Submission Date: 3-12-24

☐ Major Construction (\$300.00)

☒ Minor Construction (\$150.00)

Written Description of Proposed Improvement (include channelward distance):

Install 90' of replacement vinyl bulkhead. Maximum channel ward extension of 1.5'.

Map: 0016 Parcel: 0014 Lot: 4 Section: 18 Block: _____ Tax District: _____
Street Address: 53 Yacht Club Drive, Ocean Pines, MD 21811
Subdivision: 0018
Dwelling on lot: ☒ Dwelling under construction: _____ Vacant: _____ Commercial: _____

Owner: Leonard Smith Phone No. 703-629-836
Mailing Address: 536 Yacht Club Drive, Ocean Pines, MD 21811
E-Mail Address: lensmith@lensmith.net

Contractor: R. G. Murphy Marine Construction Phone No.: 443-497-0271
Mailing Address: 13239 Rollie Road, Bishopville, MD 21813
E-Mail Address: rgmurphy11@comcast.net

Recorded Adjacent Property Owner: Garry Asmus James Byerly
Property Address: 1724722 South Chase St, Berlin, MD 21811
Tax Map: 0016 Parcel: 0108 Lot: 74 73 Section: 4 Block: _____

Recorded Adjacent Property Owner: Ronald Boltz
Property Address: 538 Yacht Club Drive, Berlin, MD 21811
Tax Map: 0016 Parcel: 0014 Lot: 5 Section: 18 Block: _____

As the applicant, I attest that the information presented on this application, site plan and any written documentation attached hereto is known to be accurate. I understand that the proposed shoreline improvement will be constructed to meet or exceed minimum design standards adopted by the Department. Any deviation from these standards will require construction plans sealed by an engineer registered in the State of Maryland. I acknowledge that any falsification of information presented may result in revocation of this approval and of the subsequent Shoreline Construction Permit.

Leonard Smith
Owner/Applicant's Signature Date: 3/5/24

DEPT. USE ONLY:

Notification Distribution Date: 3-12-24 Public Comment Deadline: 3-27-24 (15 calendar days)
Department Approval Date: _____ Expiration: _____

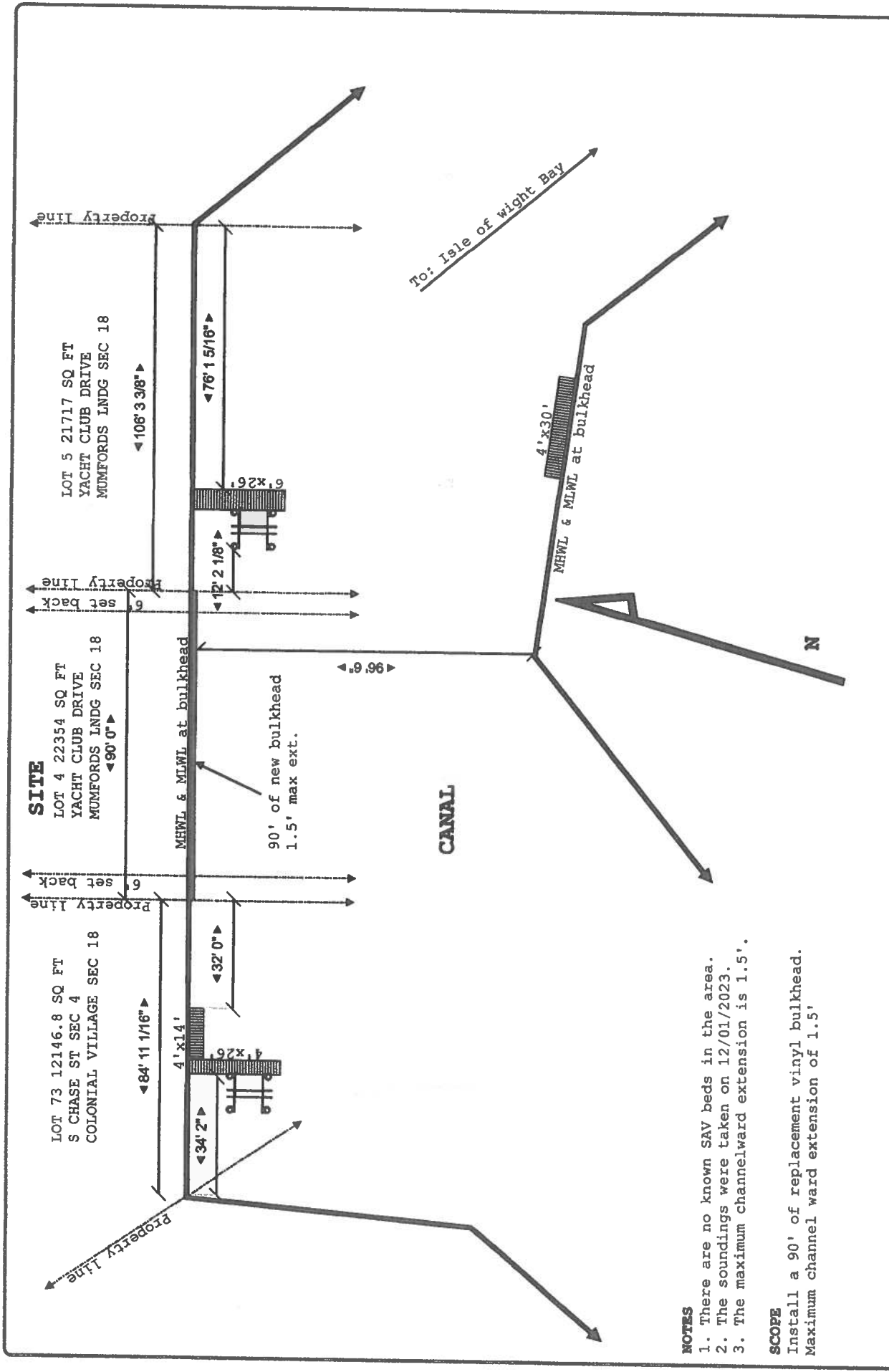

NOTES

1. There are no known SAV beds in the area.
2. The soundings were taken on 12/01/2023.
3. The maximum channelward extension is 1.5'.

SCOPE

Install a 90' of replacement vinyl bulkhead.
Maximum channel ward extension of 1.5'

Site:	536 Yacht Club Drive, OP MD	Project:	Smith	Drawn:	Carouge	Notes:	Hidden Oak Farms, LLC
Title:	PROPOSED CONDITIONS	Scale:	1/4"=10'0"	Date:	12/04/2023	Rev:	A

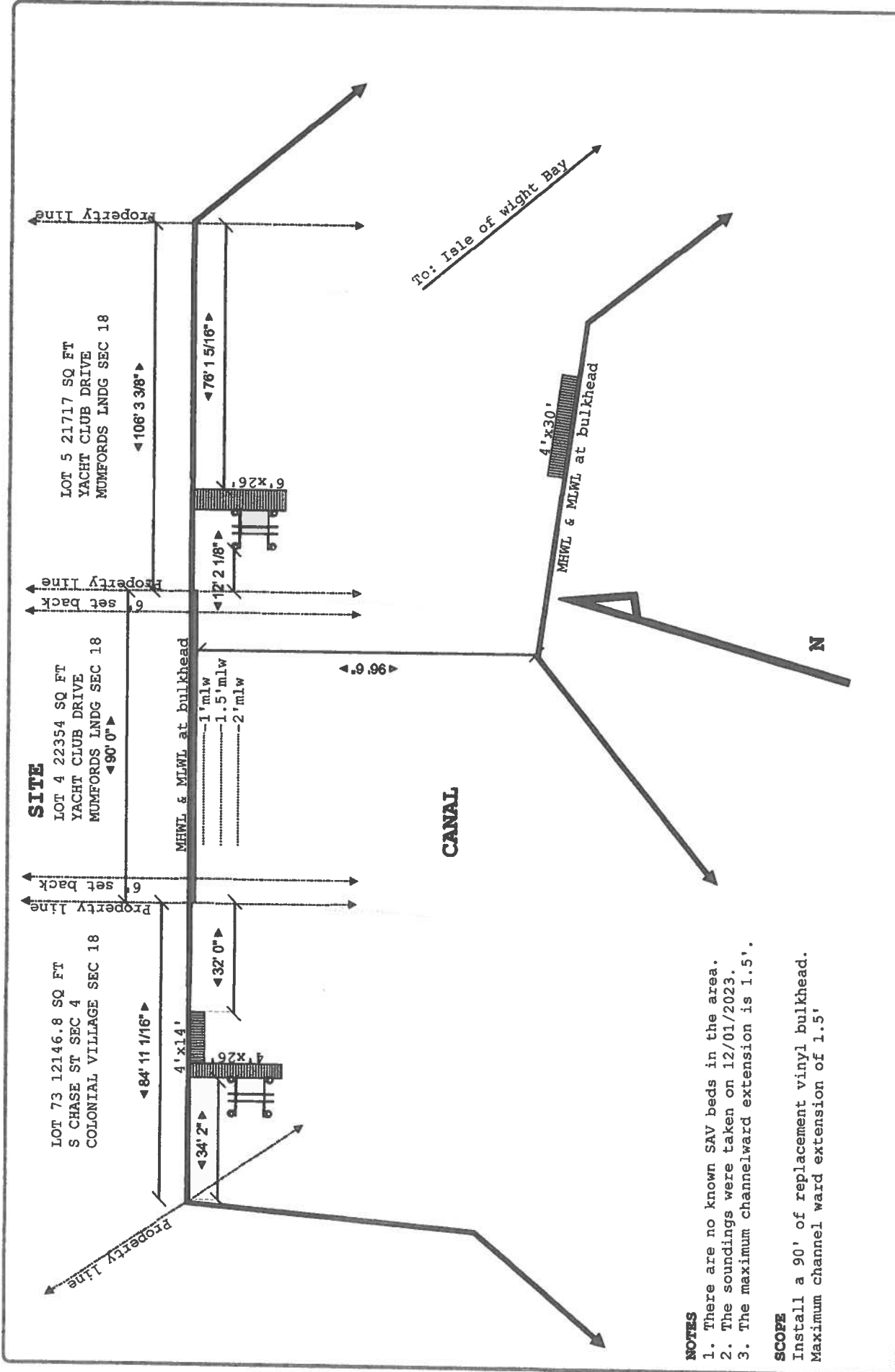

NOTES

1. There are no known SAV beds in the area.
2. The soundings were taken on 12/01/2023.
3. The maximum channelward extension is 1.5'.

SCOPE

Install a 90' of replacement vinyl bulkhead.
Maximum channel ward extension of 1.5'

Site:	536 Yacht Club Drive, OP MD	Drawing:	1	Project:	Smith	Drawn:	Carouge	Notes:	Hidden Oak Farms, LLC
Title:	DEPTHS	Scale:	1/4"=10'0"	Date:	12/04/2023	Rev:	A		



