



DEPARTMENT OF
ENVIRONMENTAL PROGRAMS

Worcester County

GOVERNMENT CENTER
ONE WEST MARKET STREET, ROOM 1306
SNOW HILL, MARYLAND 21863
TEL: 410.632.1220 / FAX: 410.632.2012

LAND PRESERVATION PROGRAM
STORMWATER MANAGEMENT
SEDIMENT AND EROSION CONTROL
SHORELINE CONSTRUCTION
AGRICULTURAL PRESERVATION
ADVISORY BOARD

WELL & SEPTIC
WATER & SEWER PLANNING
PLUMBING & GAS
CRITICAL AREAS/FORESTRY
COMMUNITY HYGIENE

June 22, 2022

This notification is to advise you that the Department has received and is presently reviewing the following request for a shoreline construction project:

James Barbey - Request No. 2022-057 – Request to demo existing platform and install 29' of replacement vinyl bulkhead with two 6' tiebacks, a 4'x18' parallel platform and one boat lift with all associated poles. Also request to install 30' of soft shoreline with a 28' stone sill. Fill behind the sill with clean sand and plant appropriate marsh grasses. Maximum channelward extension of 15.5'. This project is located at Lot 19 Rungate Rd, Ocean City, also known as Tax Map 21, Parcel 8, Section A, Block 7, Lot 19. Tenth Tax District of Worcester County, Maryland.

The Department in considering this application will make specific findings of fact with regard to the environmental impact, navigational impact, recreational potential, commercial benefit to Worcester County, impact of the proposed construction upon the surrounding neighborhood and upon property values therein, and any other pertinent issues. Approval from the Department does not guarantee approval from any other applicable regulatory agencies.

If you have an interest which may be adversely affected by the issuance of this permit, you are requested to notify this Department in writing within fifteen (15) calendar days which will end on July 7, 2022.

Sincerely,

Brandy Whitlock
Environmental Inspector

cc: Interested Parties
David Bradford, Deputy Director
File



WORCESTER COUNTY
SHORELINE CONSTRUCTION
APPLICATION

Request No.: 2022-057
Submission Date: 6-22-22

Major Construction (\$300.00)
Minor Construction (\$150.00)

Written Description of Proposed Improvement (include channelward distance):

Demo and existing platform and install 29' of replacement vinyl bulkhead with two (2) 6' tiebacks, a 4' x 18' parallel platform, and one (1) boat lift with all associated poles. Also install 30' of soft shoreline with a 28" stone sill. Fill behind the sill with clean sand and plant appropriate marsh grasses. Maximum channel ward extension of 15.5'

Property Description:

Map: 0021 Parcel: 0008 Lot: 19 Section: A Block: 7 Tax District:
Street Address: Lot 19, Rumgate Road, Ocean City, MD 21842
Subdivision: 71G3
 Dwelling on lot: Dwelling under construction: Vacant: Commercial:

Owner: James Barbey Phone No. 443-324-3793
Mailing Address: 11713 Jerome Avenue, White Marsh, MD 21162
E-Mail Address: fullservicesportfishing@aol.com

Contractor: To Be Determined Phone No.:
Mailing Address:
E-Mail Address:

Recorded Adjacent Property Owner: Joseph Hofbauer

Property Address: 10414 Keyser Point Road, Ocean City, MD 21842 - 151 Eagle town Rd Honey brook PA 19344
Tax Map: 0021 Parcel: 0008 Lot: 18 Section: A Block: 7

Recorded Adjacent Property Owner: James Barbey + Sharon Spangler

Property Address: 10415 Quay Road, Ocean City, MD 21842 - 9019 Cowenton Ave Perry Hall, MD 2112
Tax Map: 0021 Parcel: 0008 Lot: 20 Section: A Block: 7

As the applicant, I attest that the information presented on this application, site plan and any written documentation attached hereto is known to be accurate. I understand that the proposed shoreline improvement will be constructed to meet or exceed minimum design standards adopted by the Department. Any deviation from these standards will require construction plans sealed by an engineer registered in the State of Maryland. I acknowledge that any falsification of information presented may result in revocation of this approval and of the subsequent Shoreline Construction Permit.

James Barbey/RW Freund POA
Owner/Applicant's Signature Date

DEPT. USE ONLY:

Notification Distribution Date: 6/22/22 Public Comment Deadline: 7-7-22 (15 calendar days)
Department Approval Date: Expiration:

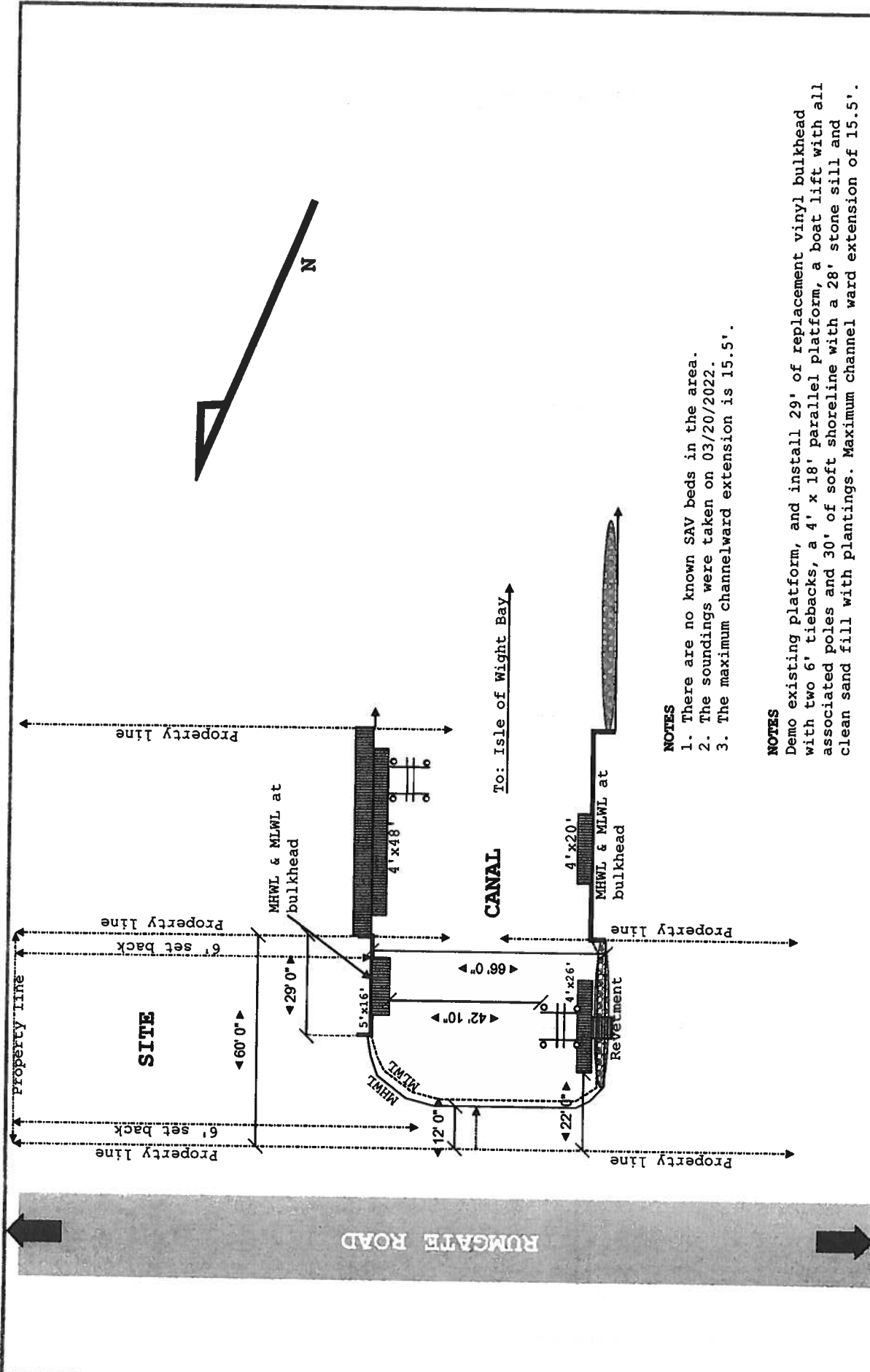

NOTES

1. There are no known SAV beds in the area.
2. The soundings were taken on 03/20/2022.
3. The maximum channelward extension is 15.5'.

NOTES

Demo existing platform, and install 29' of replacement vinyl bulkhead with two 6' tiebacks, a 4' x 18' parallel platform, a boat lift with all associated poles and 30' of soft shoreline with a 28' stone sill and clean sand fill with plantings. Maximum channel ward extension of 15.5'.

Site:	Lot #19, Rumgate Road, OC MD	Drawing:	1	Project:	Barvey	Drawn:	Carouge	Notes:	Hidden Oak Farms, LLC
Title:	EXISTING CONDITIONS	Scale:	1/4" = 10'0"	Date:	03/20/2022	Rev:	A		

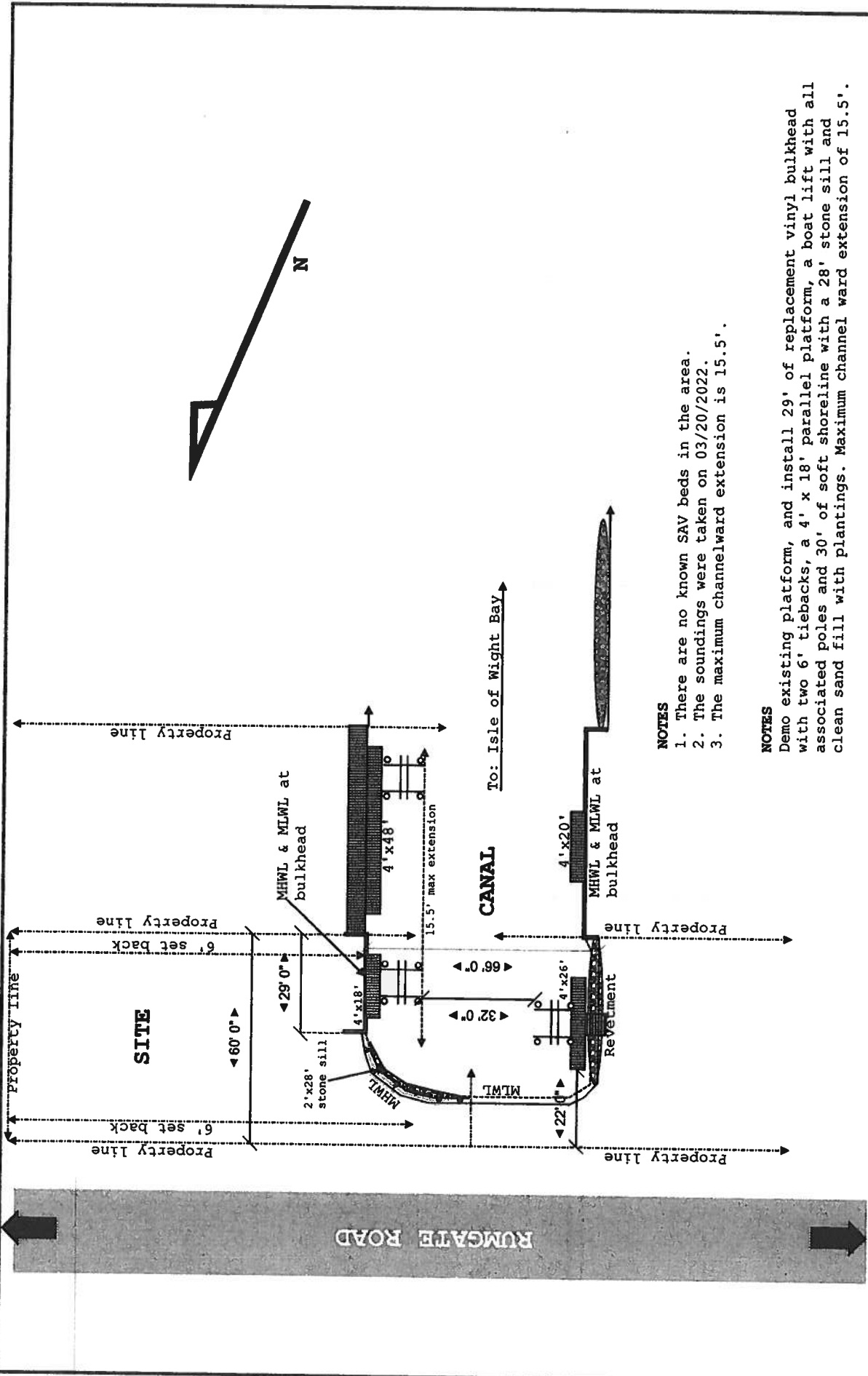

NOTES

1. There are no known SAV beds in the area.
2. The soundings were taken on 03/20/2022.
3. The maximum channelward extension is 15.5'.

NOTES

Demo existing platform, and install 29' of replacement vinyl bulkhead with two 6' tiebacks, a 4' x 18' parallel platform, a boat lift with all associated poles and 30' of soft shoreline with a 28' stone sill and clean sand fill with plantings. Maximum channel ward extension of 15.5'.

Site:	Lot #19 Rumgate Road, OC MD	Drawing:	1	Project:	Barvey	Drawn:	Carouge	Notes:	Hidden Oak Farms, LLC
Title:	PROPOSED CONDITIONS I of II	Scale:	1/4" : 10'0"	Date:	03/20/2022	Rev:	A		

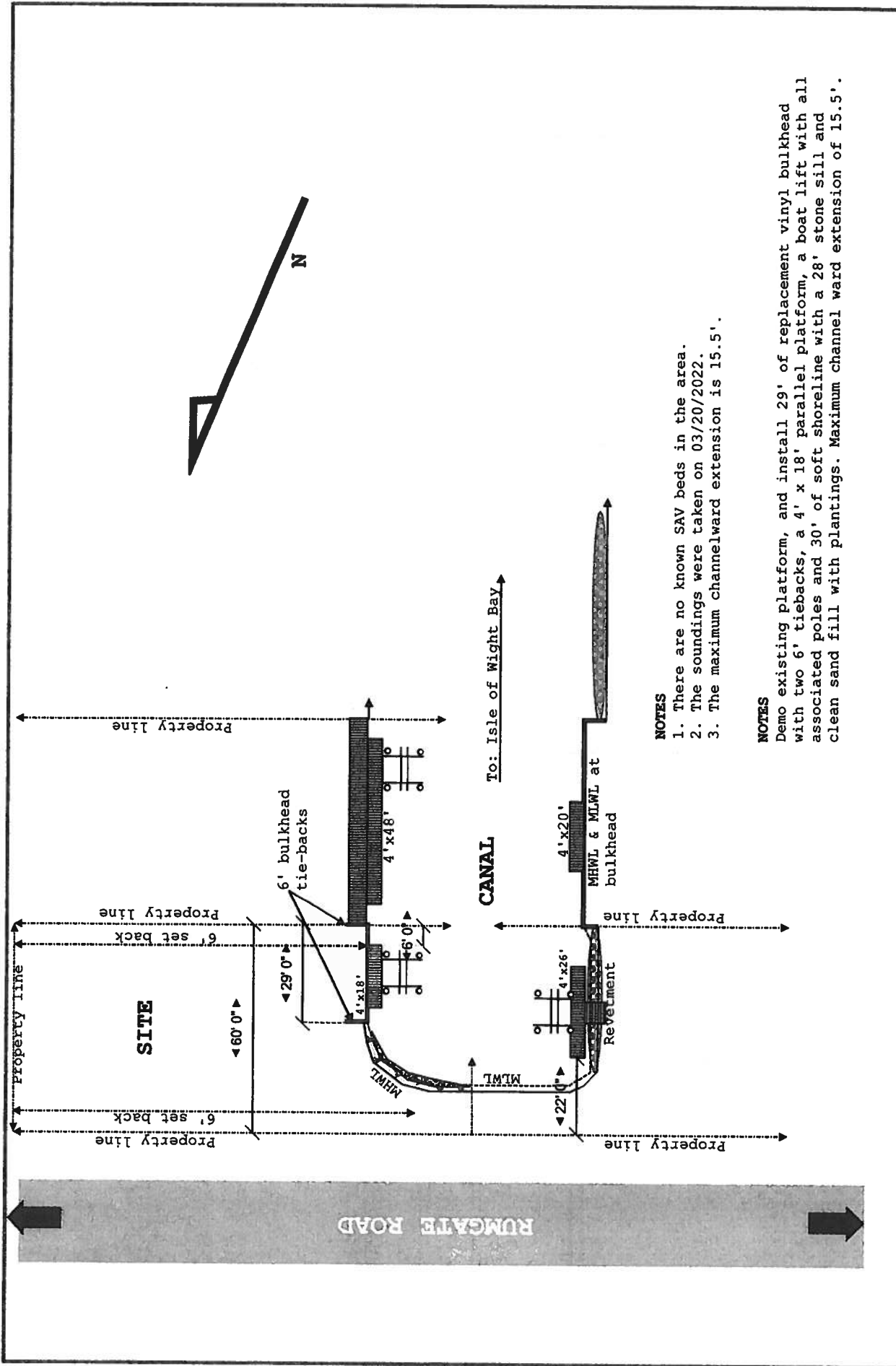

NOTES

1. There are no known SAV beds in the area.
2. The soundings were taken on 03/20/2022.
3. The maximum channelward extension is 15.5'.

NOTES

Demo existing platform, and install 29' of replacement vinyl bulkhead with two 6' tiebacks, a 4' x 18' parallel platform, a boat lift with all associated poles and 30' of soft shoreline with a 28' stone sill and clean sand fill with plantings. Maximum channel ward extension of 15.5'.

Site: Lot #19 Rumgate Road, OC MD	Drawing: 1	Project: Barvey	Drawn: Carouge	Notes:	Hidden Oak Farms, LLC
Title: PROPOSED CONDITIONS II of II	Scale: 1/4" = 10' 0"	Date: 03/20/2022	Rev: A		

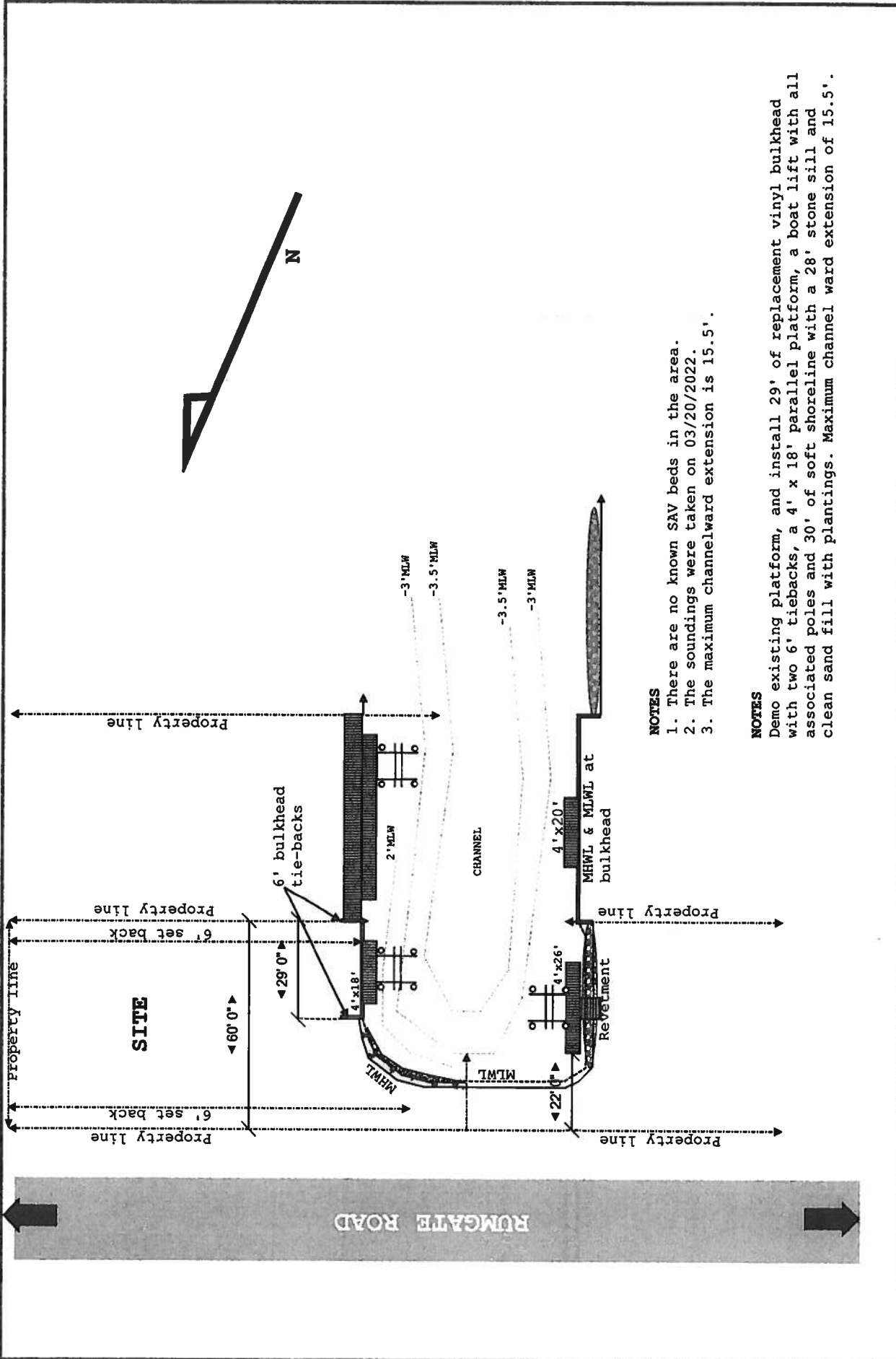

NOTES

1. There are no known SAV beds in the area.
2. The soundings were taken on 03/20/2022.
3. The maximum channelward extension is 15.5'.

NOTES

Demo existing platform, and install 29' of replacement vinyl bulkhead with two 6' tiebacks, a 4' x 18' parallel platform, a boat lift with all associated poles and 30' of soft shoreline with a 28' stone sill and clean sand fill with plantings. Maximum channel ward extension of 15.5'.

Site: Lot #19 Rumgate Road, OC MD	Drawing: 1	Project: Barvey	Drawn: Carouge	Notes:
Title: DEPTHS	Scale: 1/4"=10'0"	Date: 03/20/2022	Rev: A	
Hidden Oak Farms, LLC				

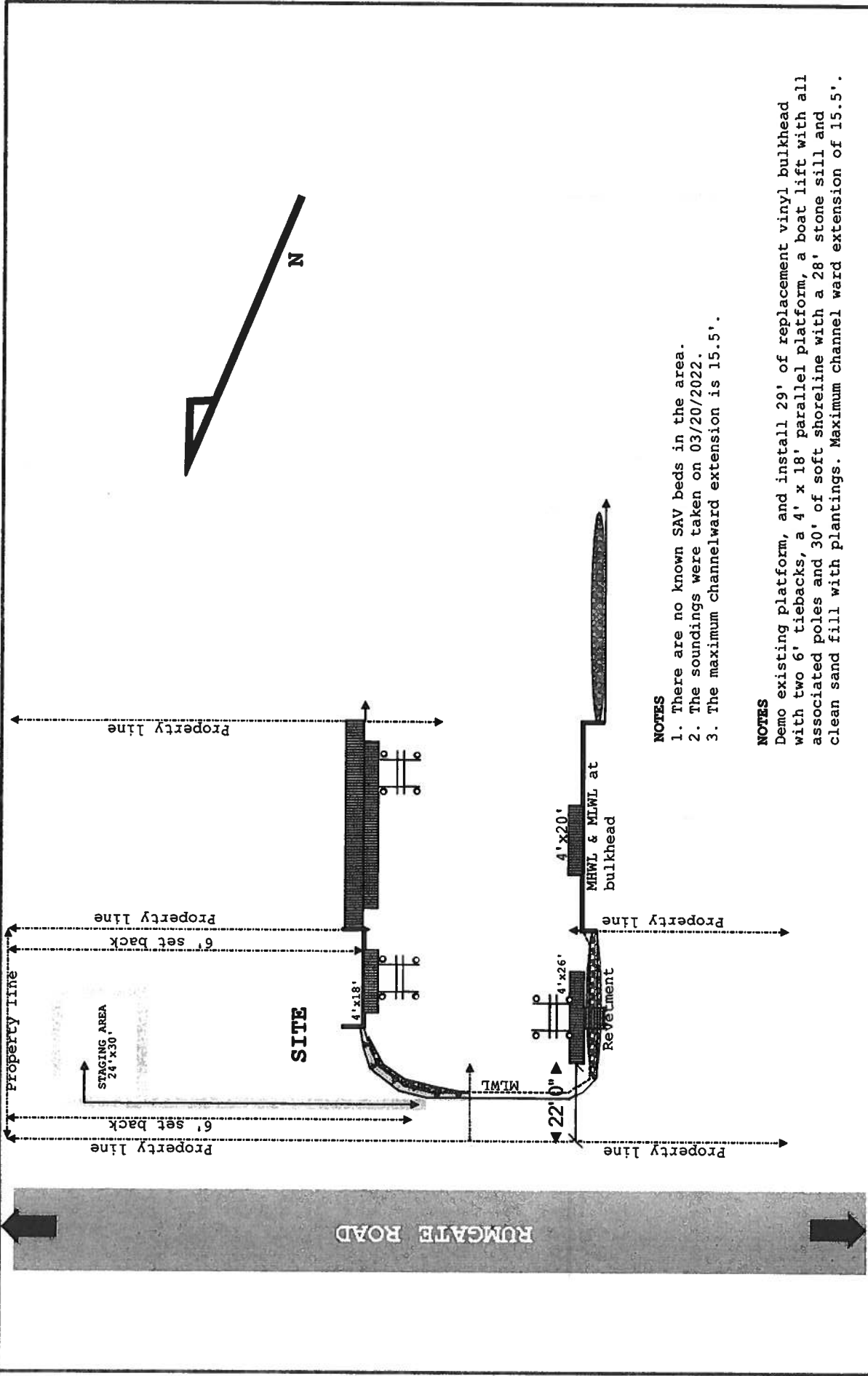

NOTES

1. There are no known SAV beds in the area.
2. The soundings were taken on 03/20/2022.
3. The maximum channelward extension is 15.5'.

NOTES

Demo existing platform, and install 29' of replacement vinyl bulkhead with two 6' tiebacks, a 4' x 18' parallel platform, a boat lift with all associated poles and 30' of soft shoreline with a 28' stone sill and clean sand fill with plantings. Maximum channel ward extension of 15.5'.

Site:	Lot #19 Rumgate Road, OC MD	Notes:	Hidden Oak Farms, LLC
Drawing:	1	Project:	Barvey Carouge
Title:	STAGING AREA	Date:	03/20/2022
Scale:	1/4" = 10' 0"	Rev:	A

Lot 19, Rungate Road Ocean City, MD Tierod Bulkhead System

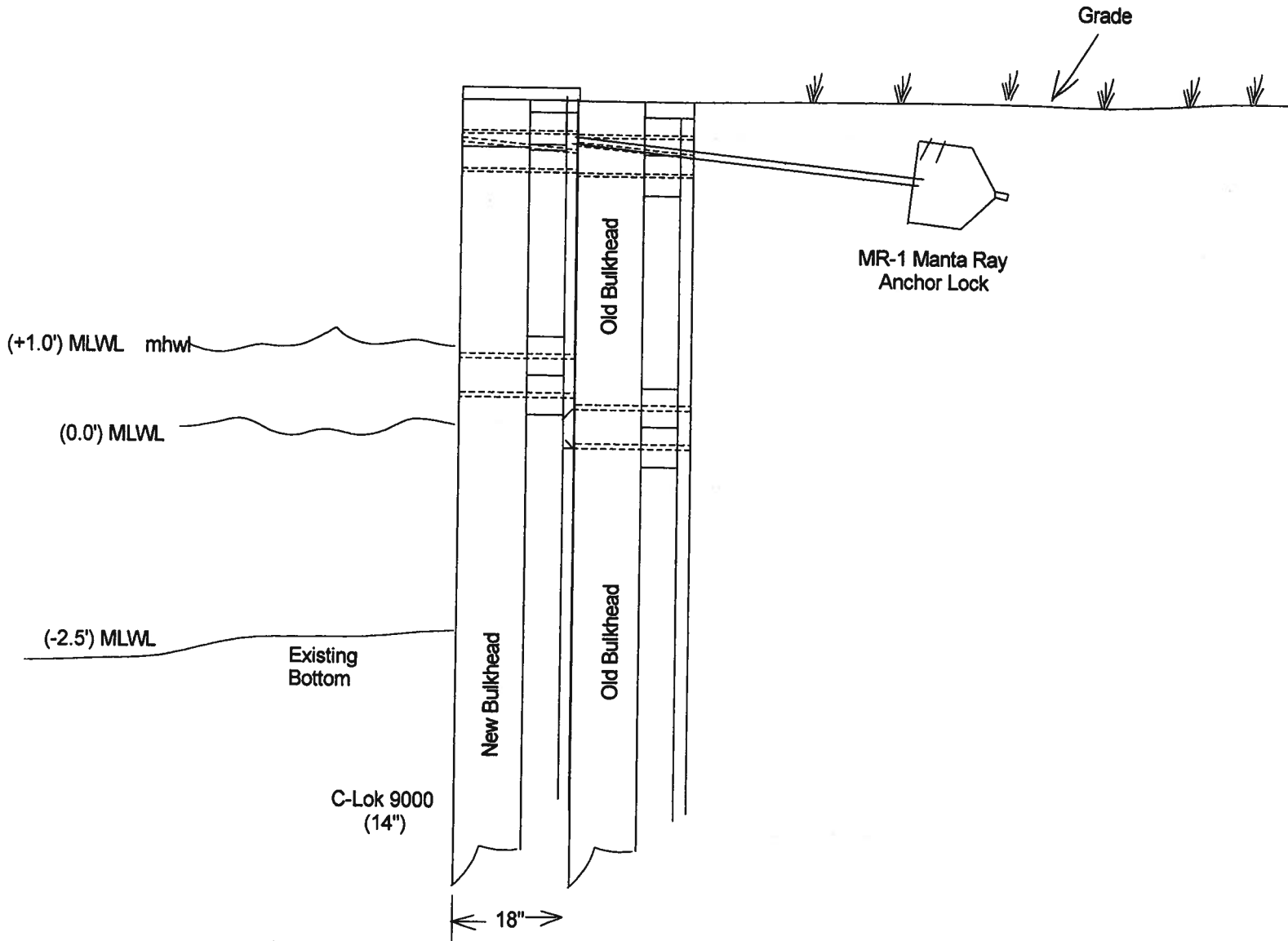

General Notes:

1. Bulkhead design will Meet or exceed Worcester County Specifications and Standards.
2. The tie back system shall be the Manta Ray MR-1 with 1" tierods.
3. The sheathing will be the C-Lok 9000 system.
4. Scale: 1/2" = 1'

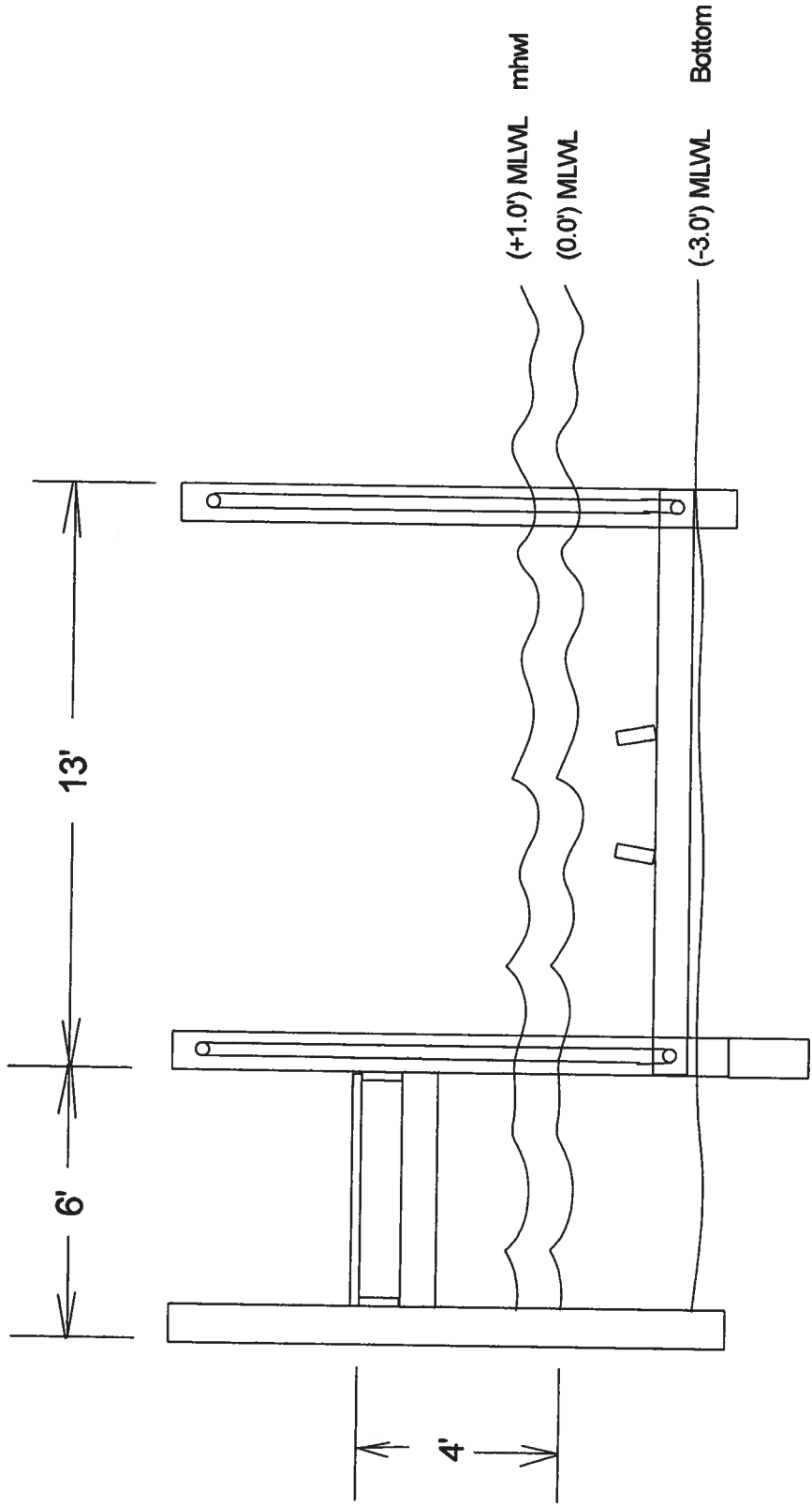

Work Scope: Boat lift and platform cross section for Lot 19, Rumgate road Ocean City, MD 21842			
Scale: 1" = 20'			
Date:			
Owner:		Lot	Blk
T. Map		Parcel	

Lot 19, Rungate Rd Ocean City, MD

Existing

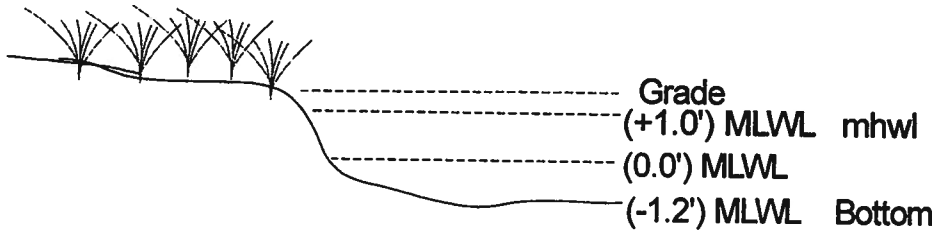

Proposed

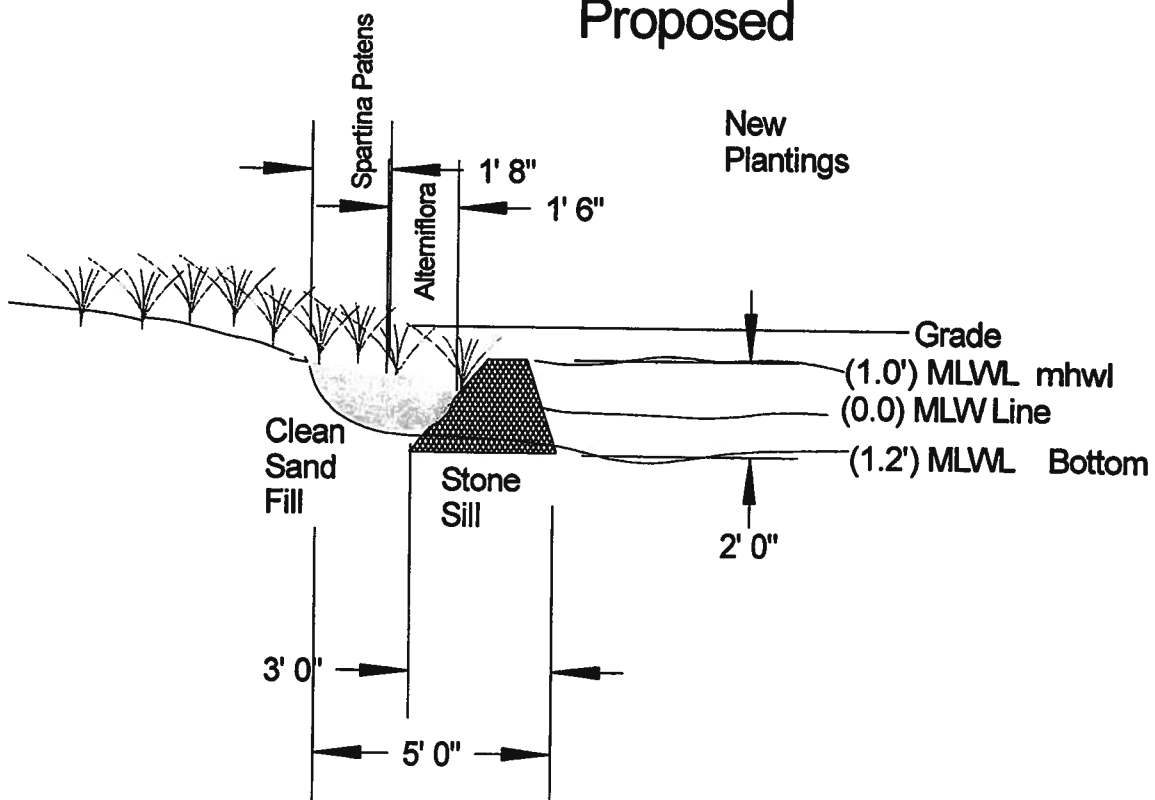

Specifications:

1. 4.2 cu.yd, Clean sand fill
2. Plant 48 sq.ft. of Alterniflora
3. Plant 54 sq.ft of Spartina Patens
4. Low energy area, top of sill even with mhw.

Scale: 1" = 3'

10415 New Quay Road

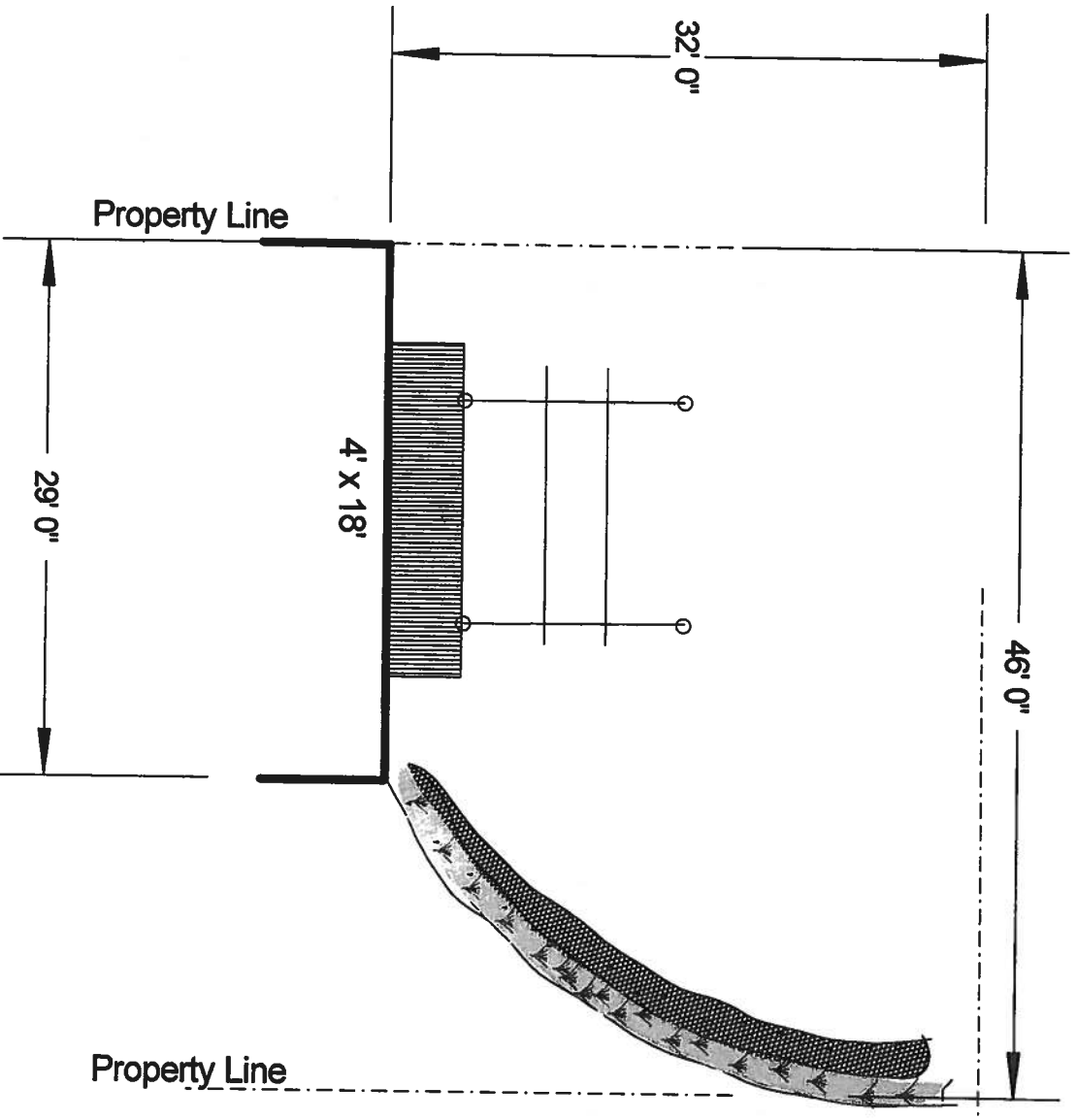

Property Line

Specifications:

1. Install a 2' x 28' stone sill
2. Fill behind the sill with clean sand
3. Plant appropriate marsh grasses on a 1' grid.
4. Install a boat lift
5. bulkhead replacement
6. platform replacement



