



DEPARTMENT OF
ENVIRONMENTAL PROGRAMS

Worcester County

GOVERNMENT CENTER
ONE WEST MARKET STREET, ROOM 1306
SNOW HILL, MARYLAND 21863
TEL:410.632.1220 / FAX: 410.632.2012

LAND PRESERVATION PROGRAM
STORMWATER MANAGEMENT
SEDIMENT AND EROSION CONTROL
SHORELINE CONSTRUCTION
AGRICULTURAL PRESERVATION
ADVISORY BOARD

WELL & SEPTIC
WATER & SEWER PLANNING
PLUMBING & GAS
CRITICAL AREAS/FORESTRY
COMMUNITY HYGIENE

August 31, 2022

This notification is to advise you that the Department has received and is presently reviewing the following request for a shoreline construction project:

Jon & Kourtney Duffie - Request No. 2022-079 – Request to remove existing 5x25 dock and construct new 6x30 pier with 5x40 “L” head and install two boat lifts with associated piles. Max channelward extension 35’ of existing bulkhead/MHW/MLW. This project is located at 13048 North Shore Rd, Ocean City, also known as Tax Map 22, Parcel 367, Lot 14&15.Tenth Tax District of Worcester County, Maryland.

The Department in considering this application will make specific findings of fact with regard to the environmental impact, navigational impact, recreational potential, commercial benefit to Worcester County, impact of the proposed construction upon the surrounding neighborhood and upon property values therein, and any other pertinent issues. Approval from the Department does not guarantee approval from any other applicable regulatory agencies.

If you have an interest which may be adversely affected by the issuance of this permit, you are requested to notify this Department in writing within fifteen (15) calendar days which will end on September 15, 2022.

Sincerely,

Brandy Whitlock
Environmental Inspector

cc: Interested Parties
David Bradford, Deputy Director
File



WORCESTER COUNTY
SHORELINE CONSTRUCTION
APPLICATION

Request No.: 2022-079
Submission Date: 8-31-22

xx Major Construction (\$300.00) _____ Minor Construction (\$150.00)

Written Description of Proposed Improvement (include channelward distance):

REMOVE EXISTING 5x25 DOCK; CONSTRUCT NEW 6x30 PIER WITH 5x40 "L" HEAD & INSTALL TWO (2) BOAT LIFTS WITH ASSOCIATED PILES A MAXIMUM OF 35' CHANNELWARD OF EX. BULKHEAD/MHW/MLW

Property Description:

Map: 22 Parcel: 367 Lot: 14 & 15 Section: _____ Block: _____ Tax District: 10
Street Address: 13048 North Shore Road
Subdivision: Captain's Hill
Dwelling on lot: xx Dwelling under construction: xx Vacant: _____ Commercial: _____

Owner: Jon C. & Kourtney S. Duffie Phone No. _____
Mailing Address: 10413 Golf Course Road, Ocean City, MD 21842
E-Mail Address: _____

Contractor: J. Stacey Hart & Associates, Inc. Phone No.: 410-390-8096
Mailing Address: PO Box 6, Snow Hill, MD 21863
E-Mail Address: stacey@jstaceyhart.com

Recorded Adjacent Property Owner: Eric & Charmie Polansky
Property Address: 13023 North Shore Road, Ocean City, MD 21842 - 96 Red Point Rd Northeast, MD 21901
Tax Map: 22 Parcel: 367 Lot: 12A Section: _____ Block: _____

Recorded Adjacent Property Owner: Mark & Donna Leiner
Property Address: 13044 North Shore Road, Ocean City, MD 21842
Tax Map: 22 Parcel: 367 Lot: 16 Section: _____ Block: _____

As the applicant, I attest that the information presented on this application, site plan and any written documentation attached hereto is known to be accurate. I understand that the proposed shoreline improvement will be constructed to meet or exceed minimum design standards adopted by the Department. Any deviation from these standards will require construction plans sealed by an engineer registered in the State of Maryland. I acknowledge that any falsification of information presented may result in revocation of this approval and of the subsequent Shoreline Construction Permit.

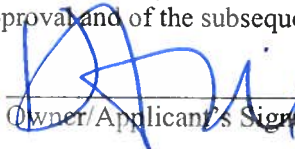
 8/8/22
Owner/Applicant's Signature Date

DEPT. USE ONLY:

Notification Distribution Date: 8/31/22 Public Comment Deadline: 9-15-22 (15 calendar days)
Department Approval Date: _____ Expiration: _____

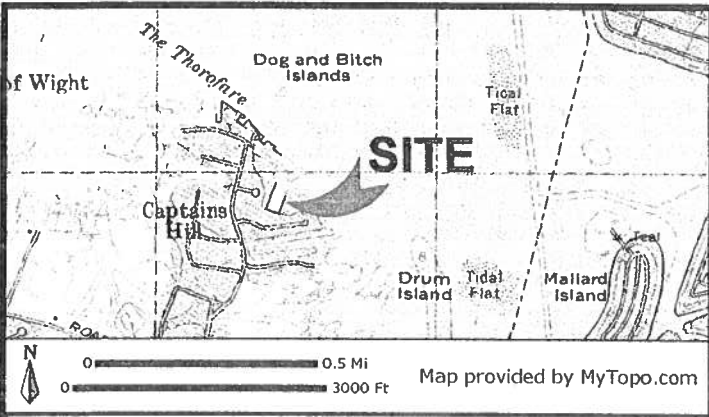

PROJECT DESCRIPTION:

Remove Existing 6x25 dock and construct new 6x30 pier with 5x40 "L" head and install two (2) boat lifts with associated pilings a maximum of 35' channelward of existing bulkhead/MHW/MLW.

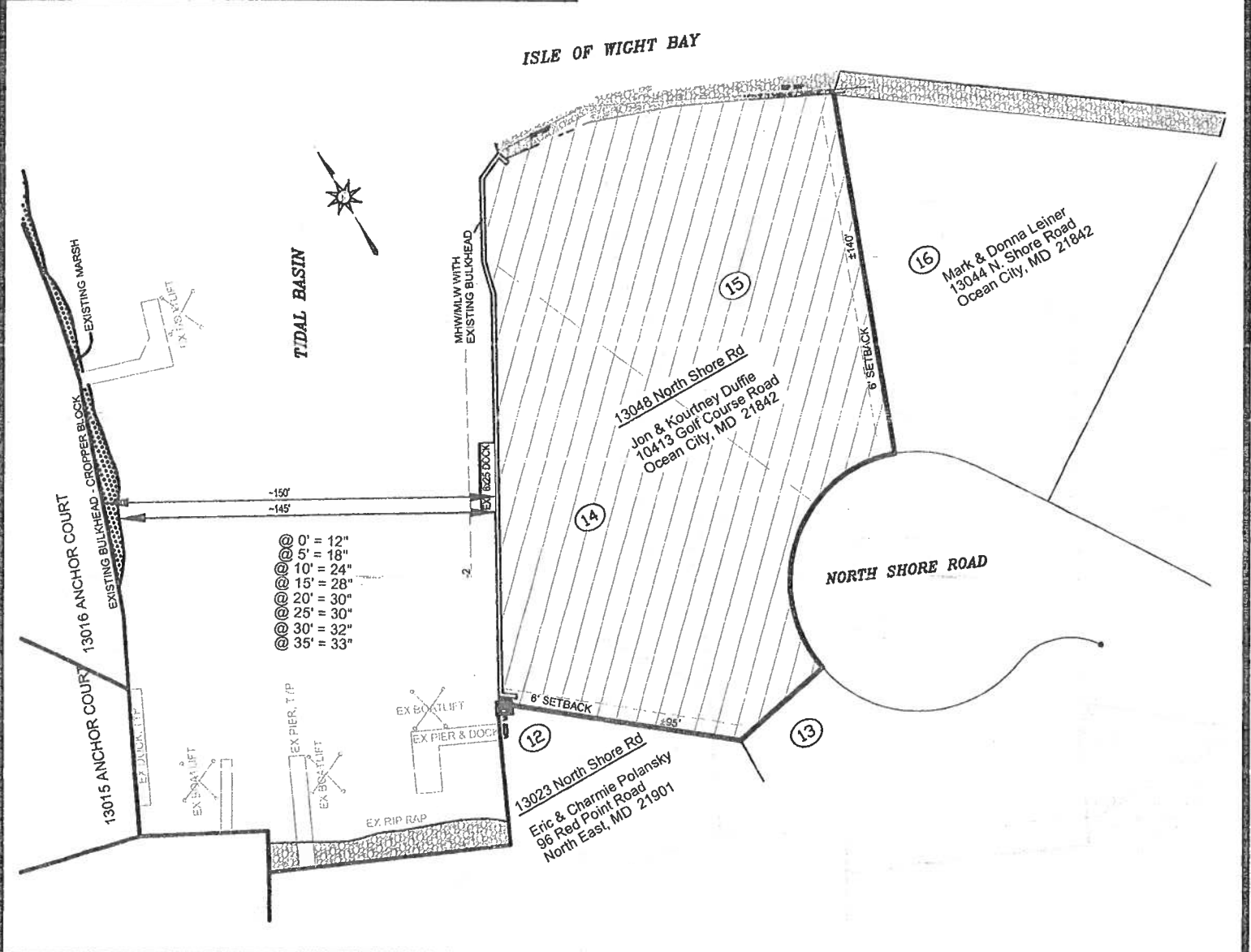

DUFFIE PROPERTY PROPOSED MARINE IMPROVEMENTS 13048 NORTH SHORE ROAD WEST OCEAN CITY, MARYLAND				
LOCATION: CAPTAIN'S HILL		NO SAV'S		
WATERWAY: ISLE OF WIGHT BAY		TAX MAP: 22		
WATER DEPTH MEASUREMENTS: REFERENCED TO MLW		PARCEL: 367		
8/5/2022		LOT: 14 & 15		
9:30 A.M.				
JOB NUMBER: P22-019	SCALE: 1"=60'	SHEET NO: 1 of 4	DATE: 08/30/2022	REVISED: N/A

APPLICANT:
JON & KOURTNEY DUFFIE
10413 GOLF COURSE ROAD
OCEAN CITY, MD 21842

J. STACEY HART & ASSOCIATES, INC.

POST OFFICE BOX 6
SNOW HILL, MD 21863
PHONE: 410-390-8096
EMAIL: stacey@jstaceyhart.com

ISLE OF WIGHT BAY

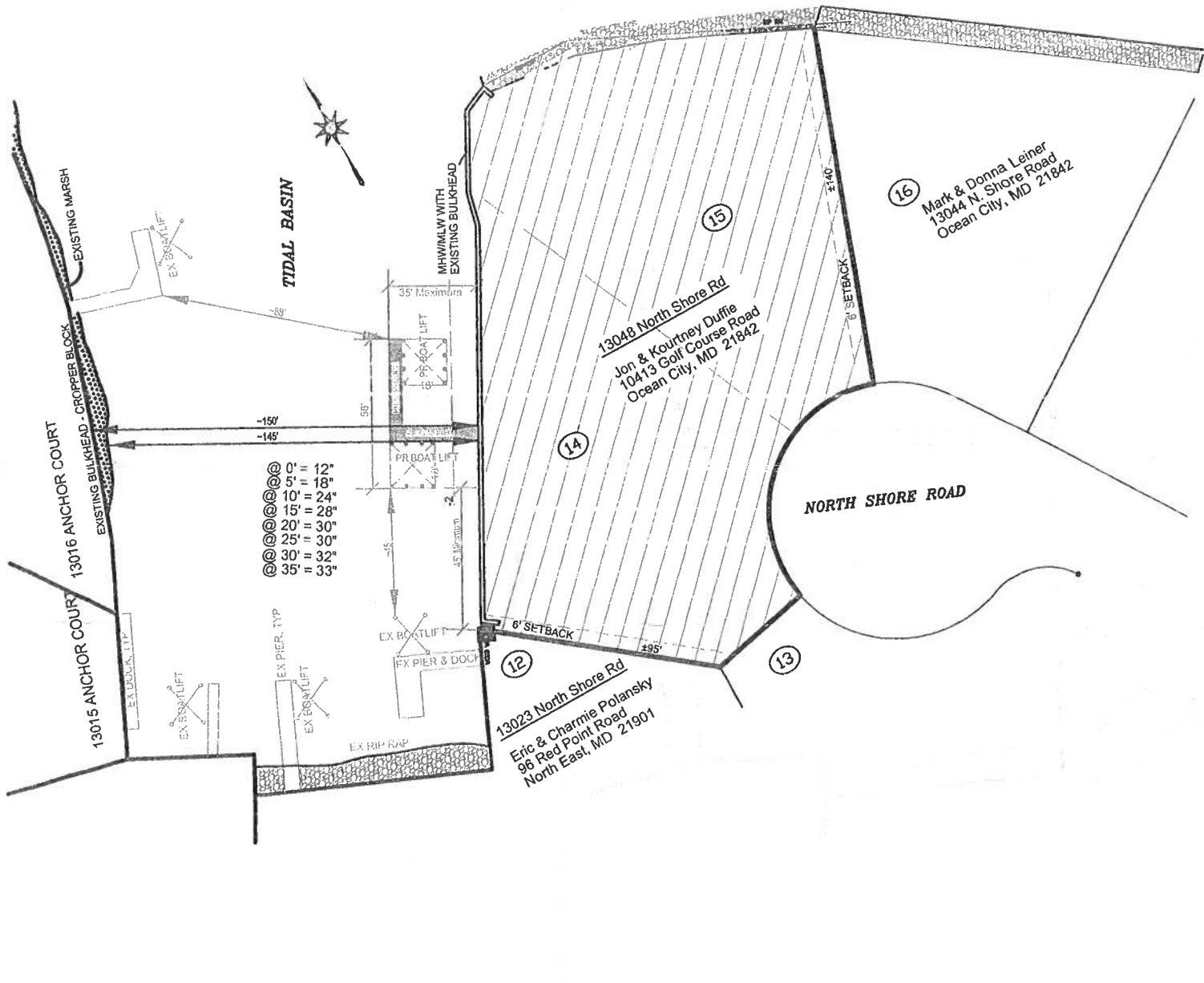

**DUFFIE PROPERTY
PROPOSED MARINE IMPROVEMENTS
13048 NORTH SHORE ROAD
WEST OCEAN CITY, MARYLAND**

APPLICANT:
JON & KOURTNEY DUFFIE
10413 GOLF COURSE ROAD
OCEAN CITY, MD 21842

LOCATION: CAPTAIN'S HILL NO SAV'S
WATERWAY: ISLE OF WIGHT BAY
WATER DEPTH MEASUREMENTS: 8/5/2022
REFERENCED TO MLW 9:30 A.M.
TAX MAP: 22
PARCEL: 367
LOT: 14 & 15

COPYRIGHT © 2022

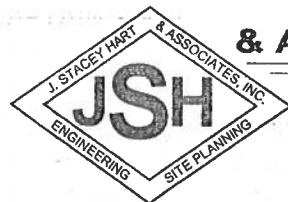

**J. STACEY HART
& ASSOCIATES, INC.**

POST OFFICE BOX 6
SNOW HILL, MD 21863
PHONE: 410-390-8096
EMAIL: stacey@jstaceyhart.com

JOB NUMBER: P22-019	SCALE: 1"=60'	SHEET NO: 2 of 4	DATE: 08/30/2022	REVISED: N/A
------------------------	------------------	---------------------	---------------------	-----------------

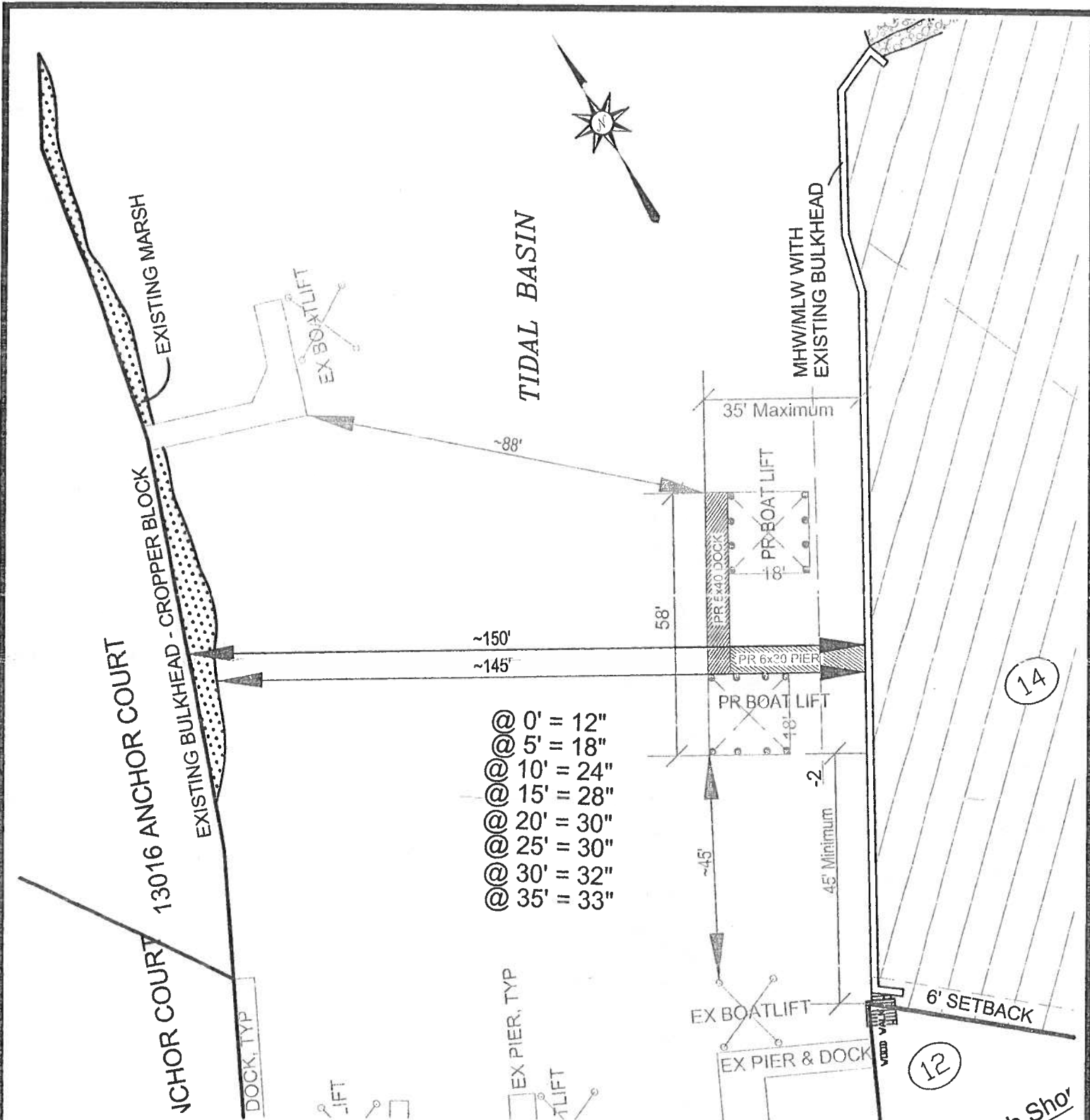

**DUFFIE PROPERTY
PROPOSED MARINE IMPROVEMENTS
13048 NORTH SHORE ROAD
WEST OCEAN CITY, MARYLAND**

APPLICANT:
JON & KOURTNEY DUFFIE
10413 GOLF COURSE ROAD
OCEAN CITY, MD 21842

LOCATION: CAPTAIN'S HILL NO SAV'S
WATERWAY: ISLE OF WIGHT BAY
WATER DEPTH MEASUREMENTS: 8/5/2022
REFERENCED TO MLW 9:30 A.M. TAX MAP: 22
PARCEL: 367
LOT: 14 & 15

J. STACEY HART & ASSOCIATES, INC.
COPYRIGHT © 2022

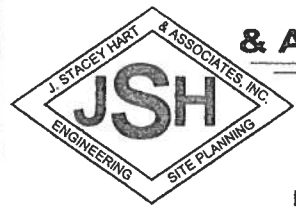

POST OFFICE BOX 6
SNOW HILL, MD 21863
PHONE: 410-390-8096
EMAIL: stacey@jstaceyhart.com

JOB NUMBER: P22-019	SCALE: 1"=30'	SHEET NO: 3 of 4	DATE: 08/30/2022	REVISED: N/A
------------------------	------------------	---------------------	---------------------	-----------------

PIER & DOCK SECTION: NO SCALE

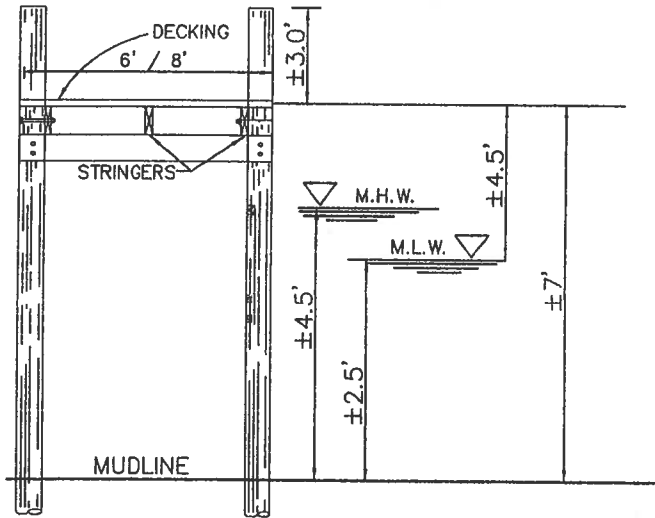

BOAT LIFT SECTION: NO SCALE

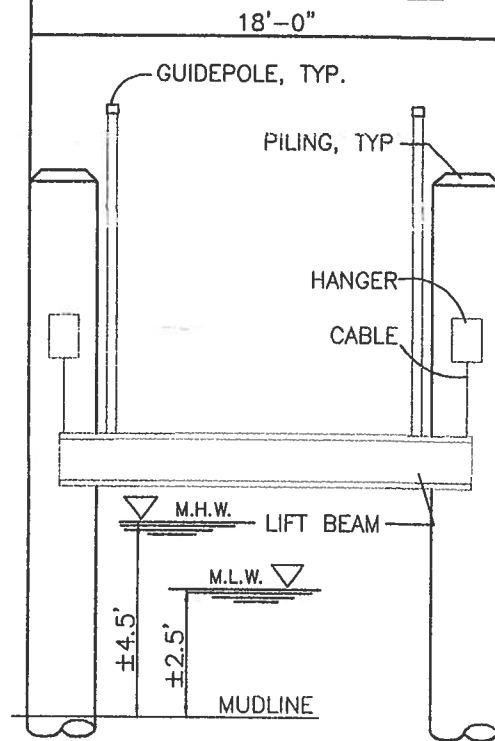

**DUFFIE PROPERTY
PROPOSED MARINE IMPROVEMENTS
13048 NORTH SHORE ROAD
WEST OCEAN CITY, MARYLAND**

APPLICANT:
JON & KOURTNEY DUFFIE
10413 GOLF COURSE ROAD
OCEAN CITY, MD 21842

LOCATION: CAPTAIN'S HILL NO SAV'S
 WATERWAY: ISLE OF WIGHT BAY
 WATER DEPTH MEASUREMENTS: 8/5/2022 TAX MAP: 22
 REFERENCED TO MLW 9:30 A.M. PARCEL: 367
LOT: 14 & 15

COPYRIGHT © 2022

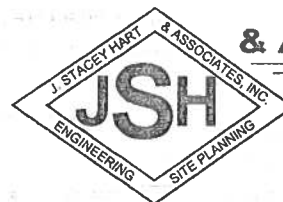

**J. STACEY HART
& ASSOCIATES, INC.**

JOB NUMBER: P22-019	SCALE: NONE	SHEET NO: 4 of 4	DATE: 08/30/2022	REVISED: N/A
------------------------	----------------	---------------------	---------------------	-----------------

POST OFFICE BOX 6
SNOW HILL, MD 21863
PHONE: 410-390-8096
EMAIL: stacey@jstaceyhart.com

