



DEPARTMENT OF
ENVIRONMENTAL PROGRAMS

Worcester County

GOVERNMENT CENTER
ONE WEST MARKET STREET, ROOM 1306
SNOW HILL, MARYLAND 21863
TEL: 410.632.1220 / FAX: 410.632.2012

LAND PRESERVATION PROGRAM
STORMWATER MANAGEMENT
SEDIMENT AND EROSION CONTROL
SHORELINE CONSTRUCTION
AGRICULTURAL PRESERVATION
ADVISORY BOARD

WELL & SEPTIC
WATER & SEWER PLANNING
PLUMBING & GAS
CRITICAL AREAS/FORESTRY
COMMUNITY HYGIENE

February 9, 2023

This notification is to advise you that the Department has received and is presently reviewing the following request for a shoreline construction project:

Alan Ford – Request No. 2023-014 – Request to install one boat lift with all associated poles to an existing platform. Maximum channelward extension of 20.5'. This project is located at 10 Clubhouse Dr, Ocean Pines also known as Tax Map 16, Parcel 41, Lot 425 Third Tax District of Worcester County, Maryland.

The Department in considering this application will make specific findings of fact with regard to the environmental impact, navigational impact, recreational potential, commercial benefit to Worcester County, impact of the proposed construction upon the surrounding neighborhood and upon property values therein, and any other pertinent issues. Approval from the Department does not guarantee approval from any other applicable regulatory agencies.

If you have an interest which may be adversely affected by the issuance of this permit, you are requested to notify this Department in writing within fifteen (15) calendar days which will end on February 24, 2023.

Sincerely,

Brandy Whitlock
Environmental Inspector

cc: Interested Parties
David Bradford, Deputy Director
File



WORCESTER COUNTY
SHORELINE CONSTRUCTION
APPLICATION

Request No.: 2023-014
Submission Date: 2-9-23

Major Construction (\$300.00)
Minor Construction (\$150.00)

Written Description of Proposed Improvement (include channelward distance):

Install one (1) boat lift with all associated poles to an existing platform. Maximum channel ward extension of 20.5'

Property Description:

Map: 0016 Parcel: 0041 Lot: 425 Section: 4 Block: Tax District: 3
Street Address: 10 Clubhouse Drive, Ocean Pines, MD 21811
Subdivision: 0004
Dwelling on lot: Dwelling under construction: Vacant: Commercial:

Owner: Alan Ford Phone No. 301-332-3300
Mailing Address: 10 Clubhouse Drive, Ocean Pines, MD 21811
E-Mail Address: balanef@aol.com

Contractor: Bayshore Marine Construction Phone No.: 410-726-6658
Mailing Address: 9808 Stephen Decatur Hwy, Unit 6, Ocean City, MD 21842
E-Mail Address: bayshoremarine@comcast.net

Recorded Adjacent Property Owner: John Smithmyer

Property Address: 8 Clubhouse Drive, Ocean Pines, MD 21811 - 19 Howes Ln North East, MD 21901
Tax Map: 0016 Parcel: 0041 Lot: 426 Section: 4 Block:

Recorded Adjacent Property Owner: Doris Kramer

Property Address: 12 Clubhouse Drive, Ocean Pines, MD 21811 - APT 9611 707 Maiden Choice Ln Catonsville, MD 21228
Tax Map: 0016 Parcel: 0041 Lot: 424 Section: 4 Block:

As the applicant, I attest that the information presented on this application, site plan and any written documentation attached hereto is known to be accurate. I understand that the proposed shoreline improvement will be constructed to meet or exceed minimum design standards adopted by the Department. Any deviation from these standards will require construction plans sealed by an engineer registered in the State of Maryland. I acknowledge that any falsification of information presented may result in revocation of this approval and of the subsequent Shoreline Construction Permit.

Alan Ford/RW Freund POA

Owner/Applicant's Signature Date

DEPT. USE ONLY:

Notification Distribution Date: 2-9-23 Public Comment Deadline: 2-24-23 (15 calendar days)
Department Approval Date: Expiration:

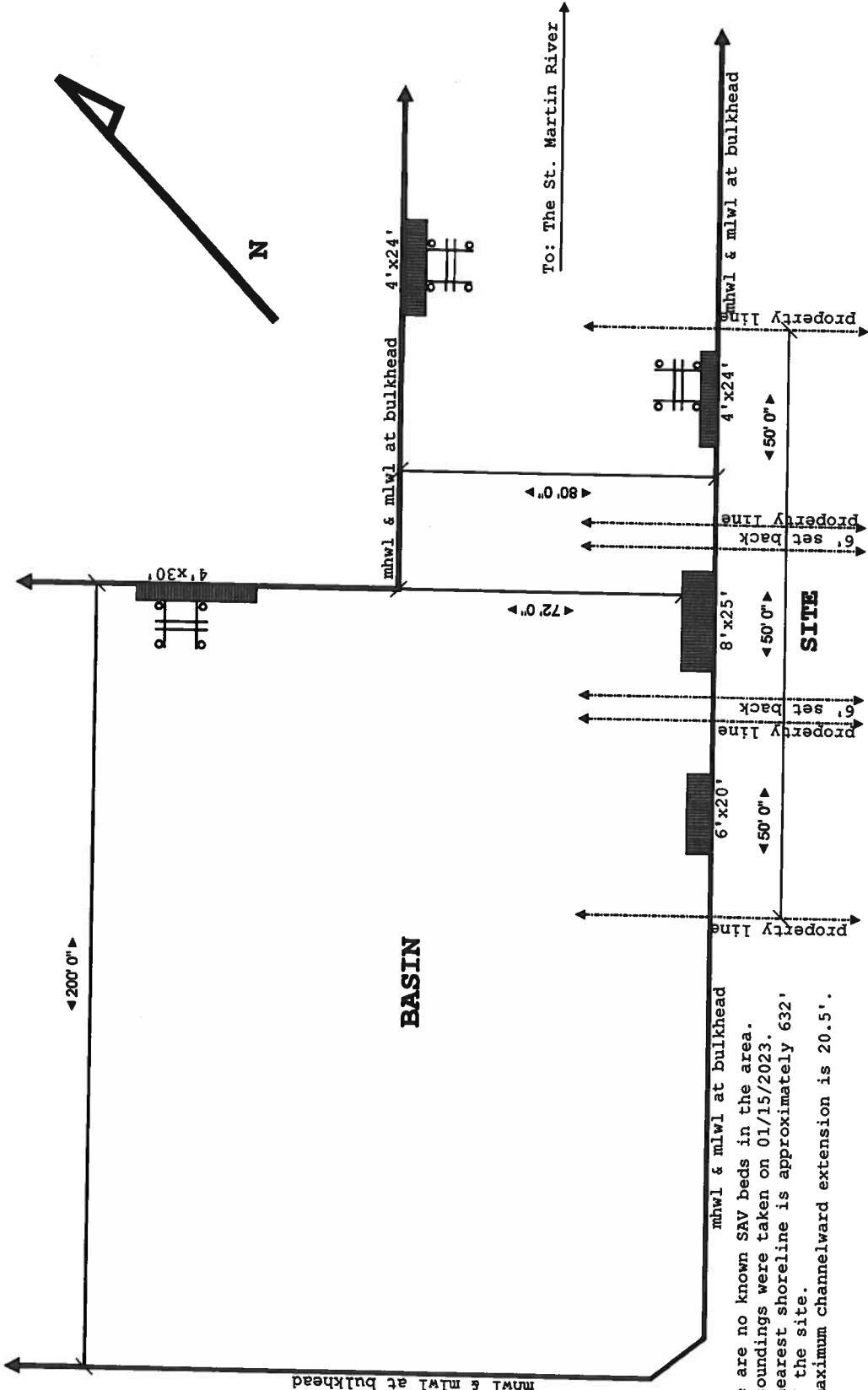

- NOTES**
1. There are no known SAV beds in the area.
 2. The soundings were taken on 01/15/2023.
 3. The nearest shoreline is approximately 632' NW of the site.
 4. The maximum channelward extension is 20.5'.

SCOPE
 Install one (1) boat lift with all associated poles.
 Max channel ward extension of 20.5'

Site:	10 Clubhouse Drive, OP MD	Notes:	HIDDEN OAK FARMS, LLC
Title:	EXISTING CONDITIONS	Project:	FORD
		Drawn:	CAROUGE
		Date:	01/22/2023
		Rev:	A
		Scale:	1/4"=10'0"
		Drawing:	1

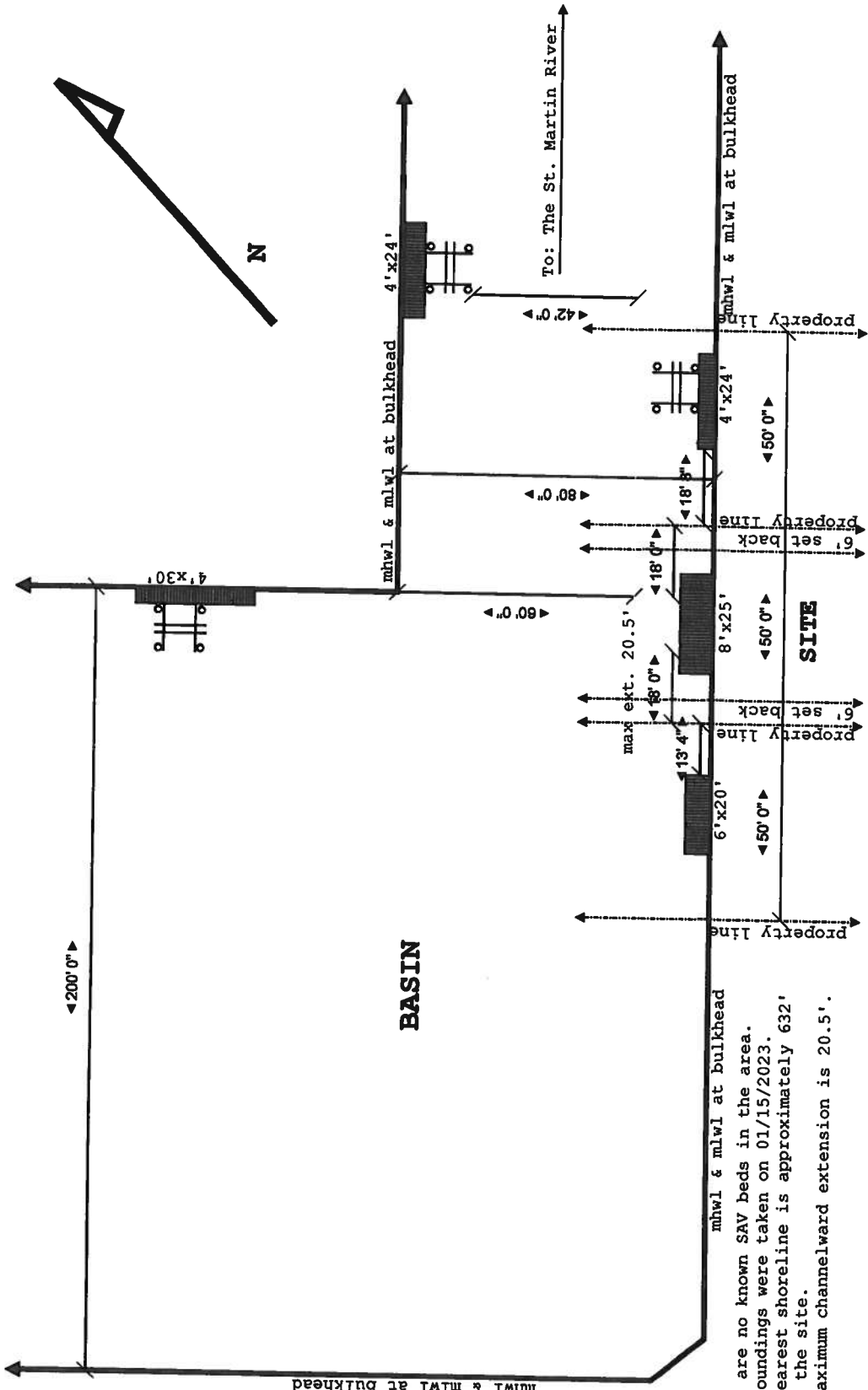

- NOTES**
1. There are no known SAV beds in the area.
 2. The soundings were taken on 01/15/2023.
 3. The nearest shoreline is approximately 632' NW of the site.
 4. The maximum channelward extension is 20.5'.

SCOPE
 Install one (1) boat lift with all associated poles.
 Max channel ward extension of 20.5'

Site:	10 Clubhouse Drive, OP MD	Drawing:	1	Project:	FORD	Drawn:	CAROUGE	Notes:	HIDDEN OAK FARMS, LLC
Title:	PROPOSED CONDITIONS	Scale:	1/4"=10'0"	Date:	01/22/2023	Rev:	A		

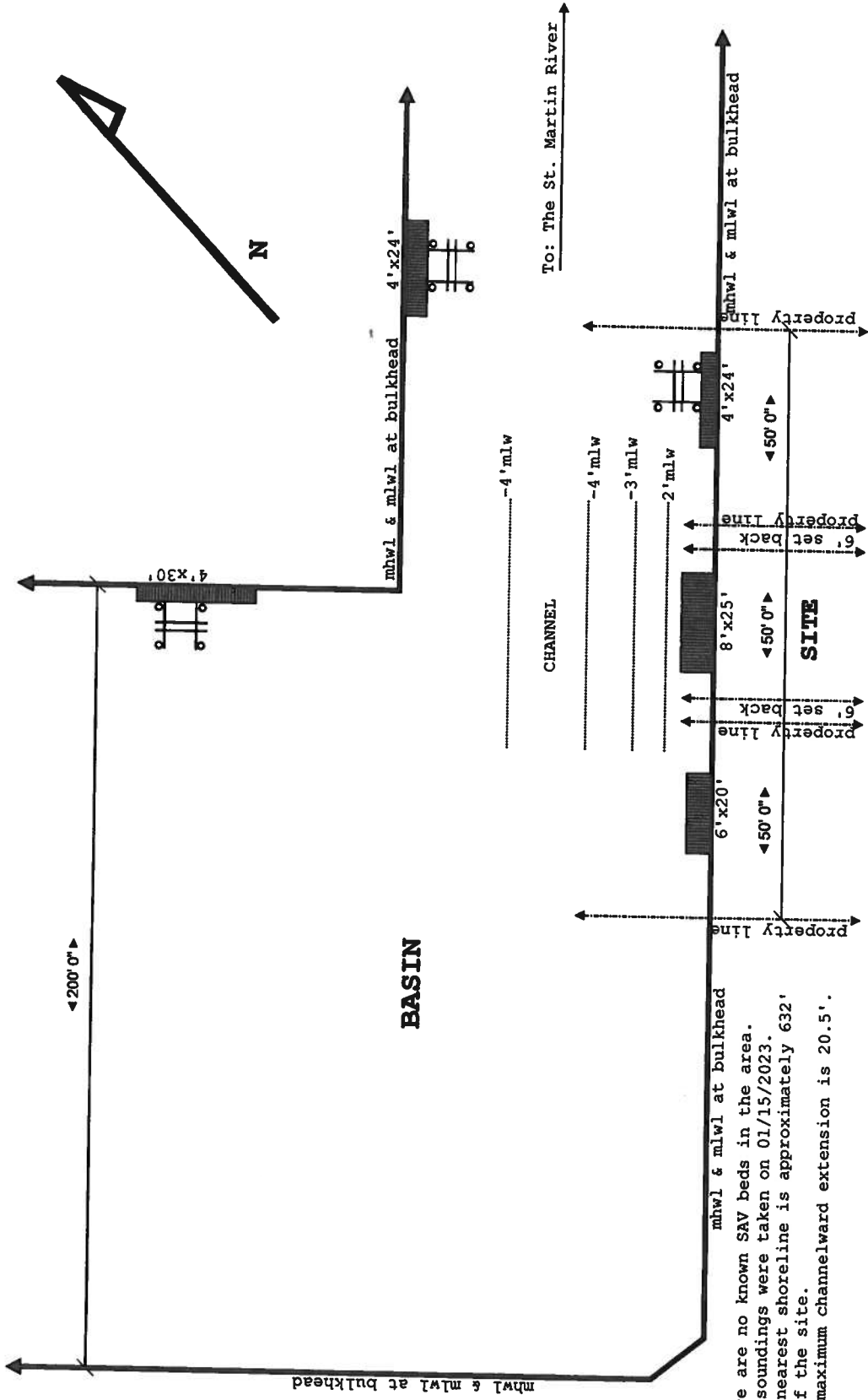

- NOTES**
1. There are no known SAV beds in the area.
 2. The soundings were taken on 01/15/2023.
 3. The nearest shoreline is approximately 632' NW of the site.
 4. The maximum channelward extension is 20.5'.

SCOPE
 Install one (1) boat lift with all associated poles.
 Max channel ward extension of 20.5'

Site:	10 Clubhouse Drive, OP MD	Project:	FORD	Notes:	HIDDEN OAK FARMS, LLC
Title:	DEPTHS	Scale:	1/4"=10'0"	Drawn:	CAROUGE
		Drawing:	1	Rev:	A
		Date:	01/22/2023		

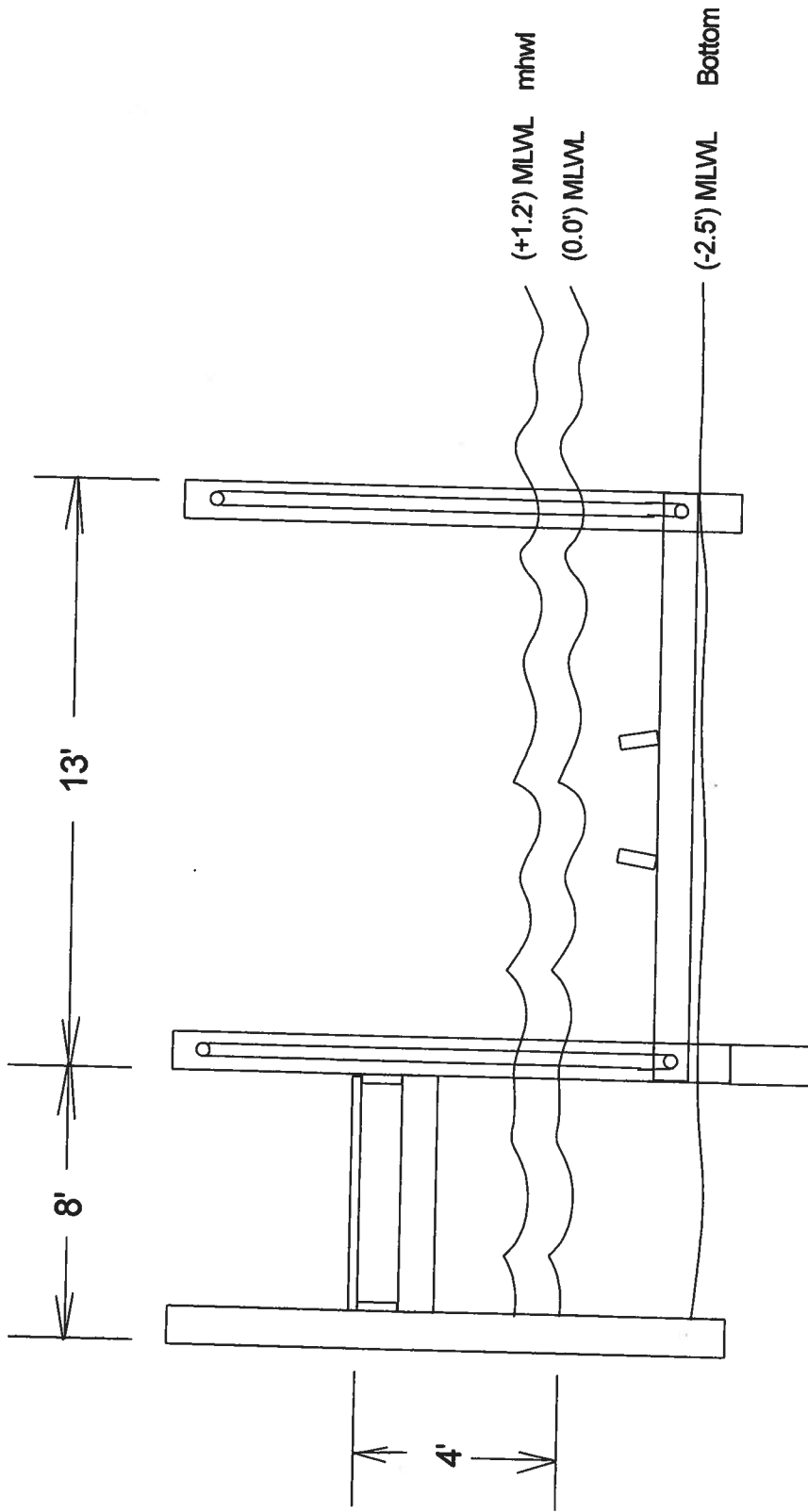

Work Scope: Boat lift and platform cross section for 10 Clubhouse Drive
 Ocean Pines, MD

Scale: 1" = 20'

Date:

Owner:

Lot

Blk

T. Map

Parcel



