



DEPARTMENT OF  
ENVIRONMENTAL PROGRAMS

## Worcester County

GOVERNMENT CENTER  
ONE WEST MARKET STREET, ROOM 1306  
SNOW HILL, MARYLAND 21863  
TEL: 410.632.1220 / FAX: 410.632.2012

LAND PRESERVATION PROGRAM  
STORMWATER MANAGEMENT  
SEDIMENT AND EROSION CONTROL  
SHORELINE CONSTRUCTION  
AGRICULTURAL PRESERVATION  
ADVISORY BOARD

WELL & SEPTIC  
WATER & SEWER PLANNING  
PLUMBING & GAS  
CRITICAL AREAS/FORESTRY  
COMMUNITY HYGIENE

February 9, 2023

This notification is to advise you that the Department has received and is presently reviewing the following request for a shoreline construction project:

Kevin & Jacqueline Murray – Request No. 2023-015 – Request to maintenance/spot dredge a 35x40 (1400 sq ft) area immediately under an existing boat lift and existing double PWC float and remove approx. 95 cubic yards of spoil in watertight trucks to an approved upland site. This project is located at 12628 Sheffield Rd, Ocean City also known as Tax Map 21, Parcel 8, Sec A, Blk 11, Lot 16 Tenth Tax District of Worcester County, Maryland.

The Department in considering this application will make specific findings of fact with regard to the environmental impact, navigational impact, recreational potential, commercial benefit to Worcester County, impact of the proposed construction upon the surrounding neighborhood and upon property values therein, and any other pertinent issues. Approval from the Department does not guarantee approval from any other applicable regulatory agencies.

**If you have an interest which may be adversely affected by the issuance of this permit, you are requested to notify this Department in writing within fifteen (15) calendar days which will end on February 24, 2023.**

Sincerely,

Brandy Whitlock  
Environmental Inspector

cc: Interested Parties  
David Bradford, Deputy Director  
File



WORCESTER COUNTY
SHORELINE CONSTRUCTION
APPLICATION

Request No.: 2023-015
Submission Date: 2-9-23

xx Major Construction (\$300.00) Minor Construction (\$150.00)

Written Description of Proposed Improvement (include channelward distance):
maintenance / spot dredge a 35x40 (1,400 sf) area immediately under an existing boat lift
and existing double PWC float; remove ~95 c.y. of spoil in watertight trucks to an approved
upland site

Property Description:
Map: 21 Parcel: 8 Lot: 16 Section: A Block: 11 Tax District: 10
Street Address: 12628 Sheffield Road
Subdivision: Cape Isle of Wight
Dwelling on lot: xx Dwelling under construction: Vacant: Commercial:

Owner: Kevin & Jacqueline Murray Phone No. 410-365-4049
Mailing Address: 11215 Gentle Rolling Drive, Marriottsville, MD 21104
E-Mail Address: kmmcfs@gmail.com

Contractor: J. Stacey Hart & Associates, Inc. Phone No.: 410-390-8096
Mailing Address: PO Box 6, Snow Hill, MD 21863
E-Mail Address: stacey@jstaceyhart.com

Recorded Adjacent Property Owner: James & Susan Latour
Property Address: 12622 Sheffield Road, Ocean City, MD 21842
Tax Map: 21 Parcel: 8 Lot: 15 Section: A Block: 11

Recorded Adjacent Property Owner: Leighton W. Moore, Jr.
Property Address: 12637 Sheffield Road, Ocean City, MD 21842
Tax Map: 22 Parcel: 405 Lot: Section: Block:

As the applicant, I attest that the information presented on this application, site plan and any written documentation
attached hereto is known to be accurate. I understand that the proposed shoreline improvement will be constructed to
meet or exceed minimum design standards adopted by the Department. Any deviation from these standards will require
construction plans sealed by an engineer registered in the State of Maryland. I acknowledge that any falsification of
information presented may result in revocation of this approval and of the subsequent Shoreline Construction Permit.

[Handwritten Signature] 10-11-22
Owner/Applicant's Signature Date

DEPT. USE ONLY:
Notification Distribution Date: 2-9-23 Public Comment Deadline: 2-24-23 (15 calendar days)
Department Approval Date: Expiration:

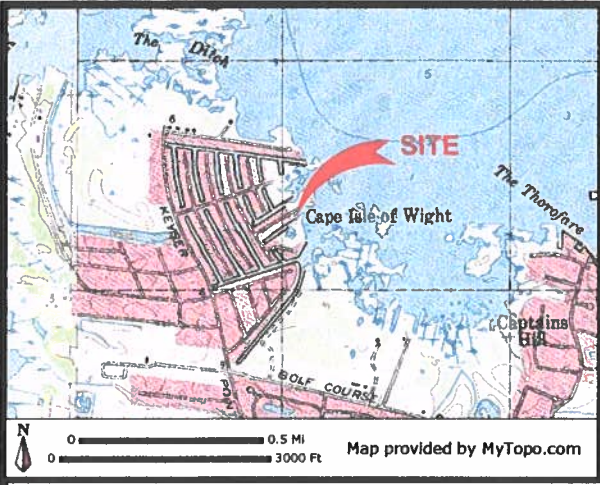

**PROJECT DESCRIPTION:**  
 MAINTENANCE/SPOT DREDGE A 35x40 (1,400 SF) AREA UNDER AN EXISTING BOAT LIFT AND DOUBLE PWC FLOAT TO A -3.0 MLW AND TRANSPORT ~95 C.Y. OF SPOIL IN WATERTIGHT TRUCKS TO AN APPROVED UPLAND SPOIL SITE.

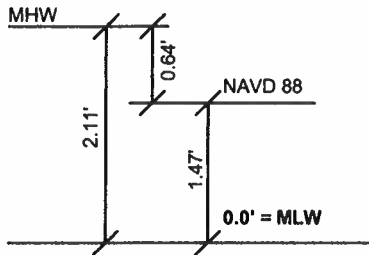

**DATUM COMPARISONS**  
 SCALE: NONE

DATUM COMPARISONS WERE OBTAINED FROM NATIONAL OCEANIC AND ATMOSPHERIC ADMINISTRATION (NOAA) INFORMATION INTERPOLATED FROM STATION ID# 8570283 - PID: HU0267.

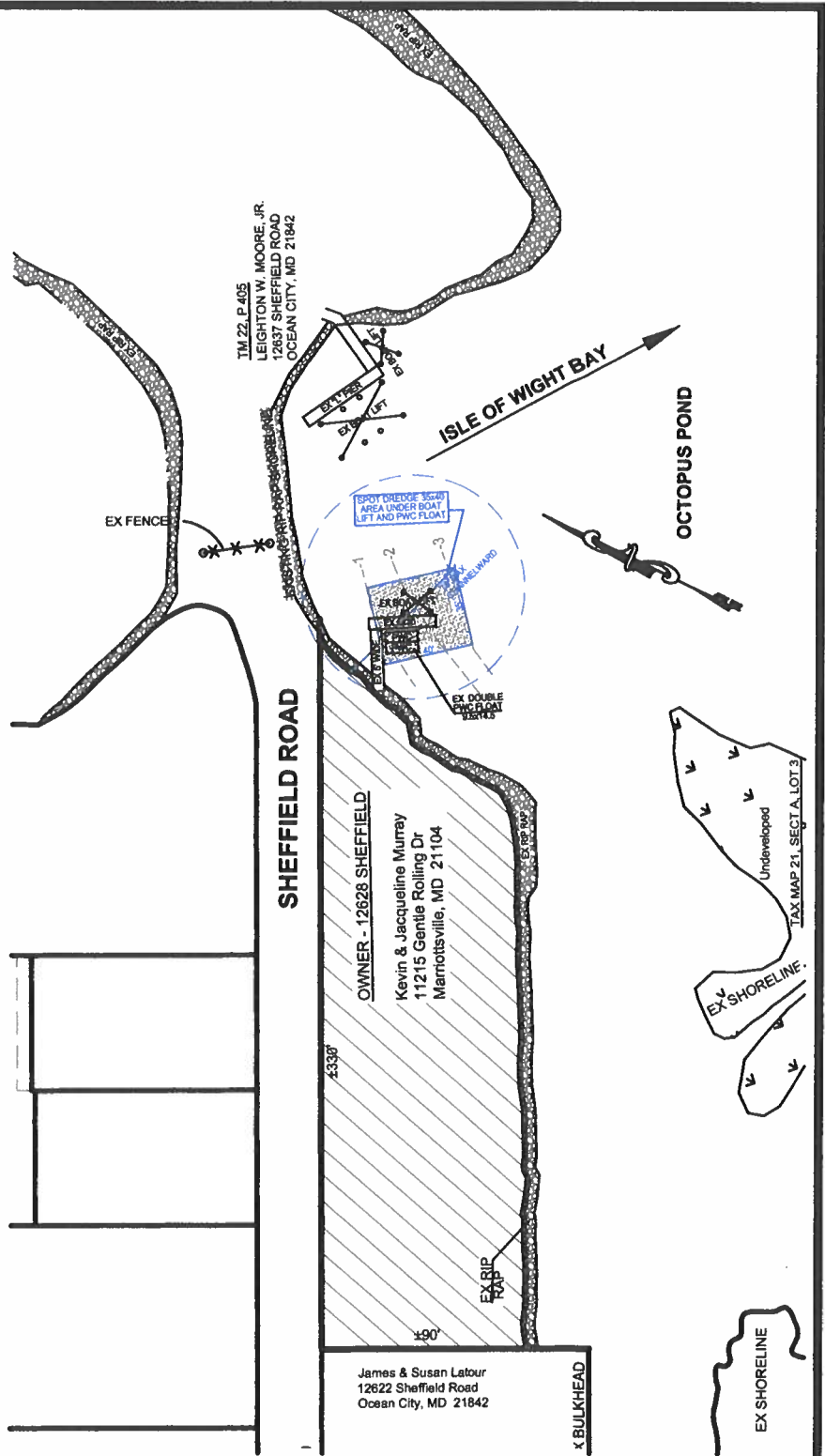

**MURRAY RESIDENCE  
 PROPOSED MAINTENANCE DREDGING  
 12628 SHEFFIELD ROAD  
 WEST OCEAN CITY**

**APPLICANT:**  
 MICHAEL T. KARSNITZ  
 12620 SHEFFIELD ROAD  
 WEST OCEAN CITY, MD 21842

LOCATION: CAPE ISLE OF WIGHT  
 WATERWAY: UNNAMED CANAL ON CAPE ISLE OF WIGHT  
 WATER DEPTH MEASUREMENTS: 11/14/2022  
 REFERENCED TO MLW 11:45 a.m.

NO SAV'S  
 TAX MAP: 21  
 PARCEL: 8  
 SECTION: A  
 BLOCK: 11  
 LOT: 16

COPYRIGHT © 2022

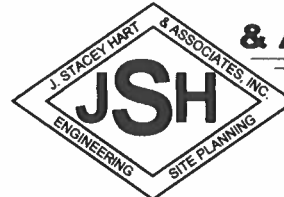

**J. STACEY HART  
 & ASSOCIATES, INC.**

JOB NUMBER: P22-032	SCALE: 1"=80'	SHEET NO: 1 of 3	DATE: 12/2022	REVISED: 2/6/2023
------------------------	------------------	---------------------	------------------	----------------------

POST OFFICE BOX 6  
 SNOW HILL, MD 21863  
 PHONE: 410-390-8096  
 EMAIL: [stacey@jstaceyhart.com](mailto:stacey@jstaceyhart.com)

TM 22, P. 405  
 LEIGHTON W. MOORE, JR.  
 12637 SHEFFIELD ROAD  
 OCEAN CITY, MD 21842

ISLE OF WIGHT BAY

OCTOPUS POND

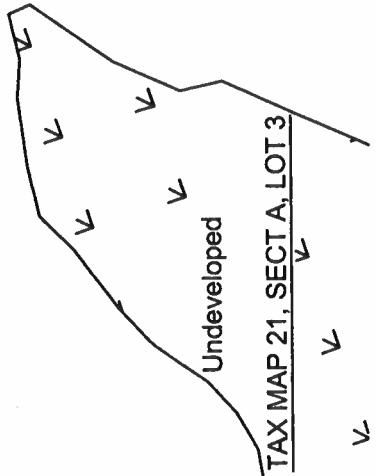
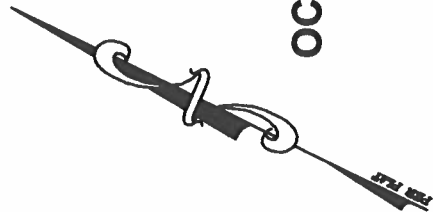
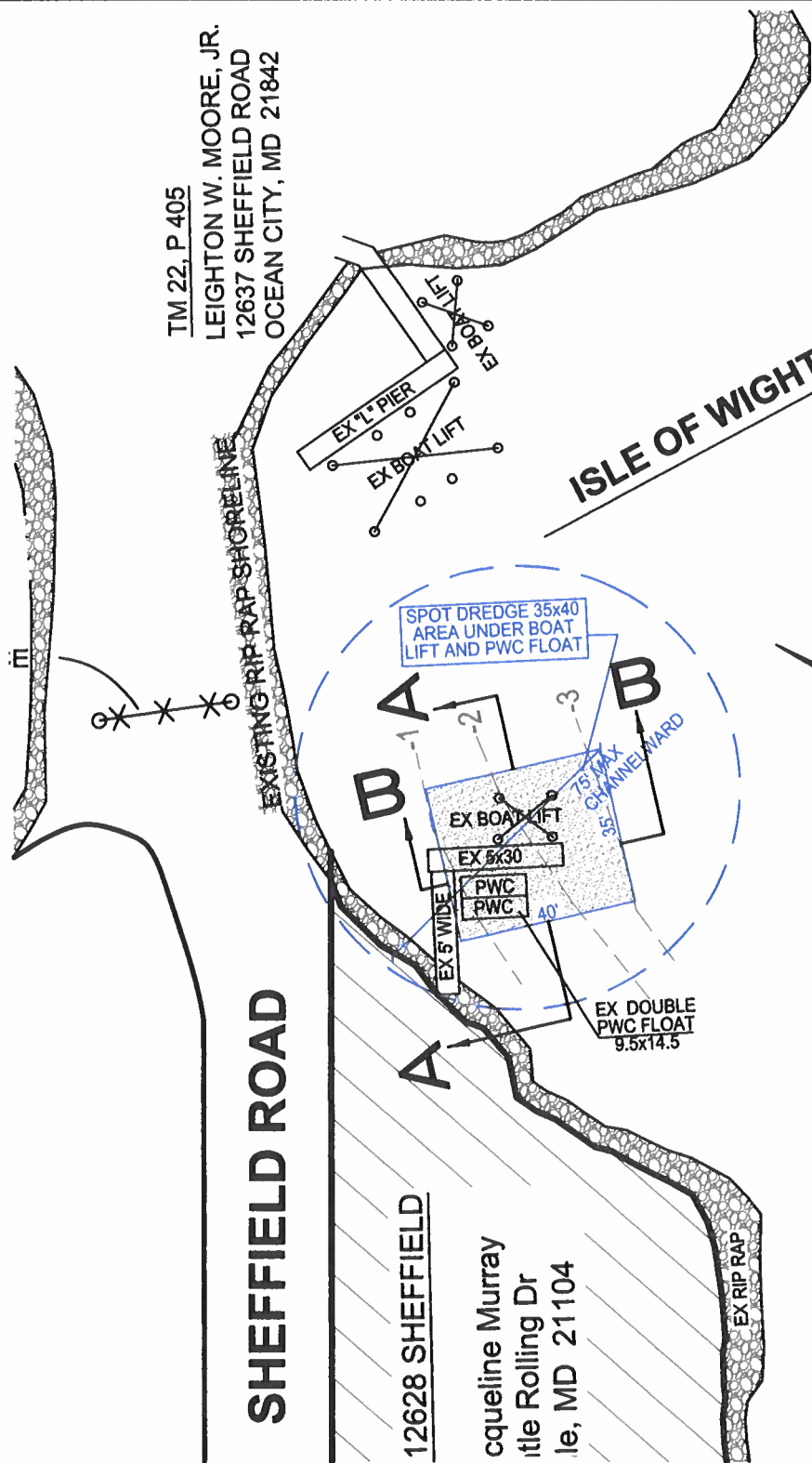

**SHEFFIELD ROAD**

12628 SHEFFIELD

acqueline Murray  
 tile Rolling Dr  
 le, MD 21104

EX RIP RAP

**MURRAY RESIDENCE  
 PROPOSED MAINTENANCE DREDGING  
 12628 SHEFFIELD ROAD  
 WEST OCEAN CITY**

APPLICANT:  
 MICHAEL T. KARSNITZ  
 12620 SHEFFIELD ROAD  
 WEST OCEAN CITY, MD 21842

LOCATION: CAPE ISLE OF WIGHT  
 WATERWAY: UNNAMED CANAL ON CAPE ISLE OF WIGHT  
 WATER DEPTH MEASUREMENTS: 11/14/2022  
 REFERENCED TO MLW 11:45 a.m.

NO SAV'S  
 TAX MAP: 21  
 PARCEL: 8  
 SECTION: A  
 BLOCK: 11  
 LOT: 16

JOB NUMBER: P22-032	SCALE: 1"=40'	SHEET NO: 2 of 3	DATE: 12/2022	REVISED: 2/6/2023
------------------------	------------------	---------------------	------------------	----------------------

COPYRIGHT © 2022

**J. STACEY HART & ASSOCIATES, INC.**

POST OFFICE BOX 6  
 SNOW HILL, MD 21863  
 PHONE: 410-390-8096  
 EMAIL: stacey@jstaceyhart.com

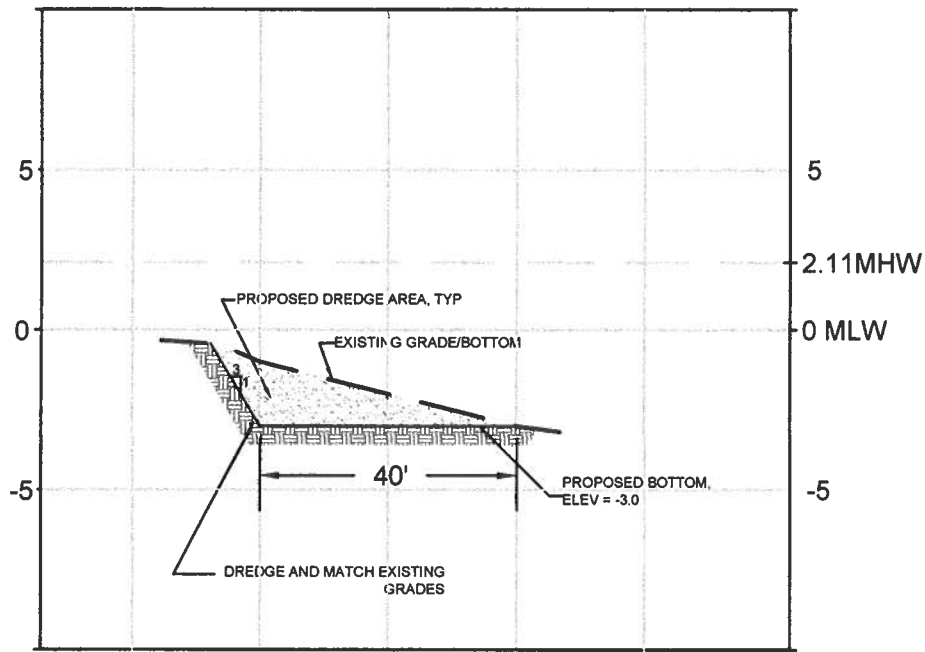

SECTION A-A

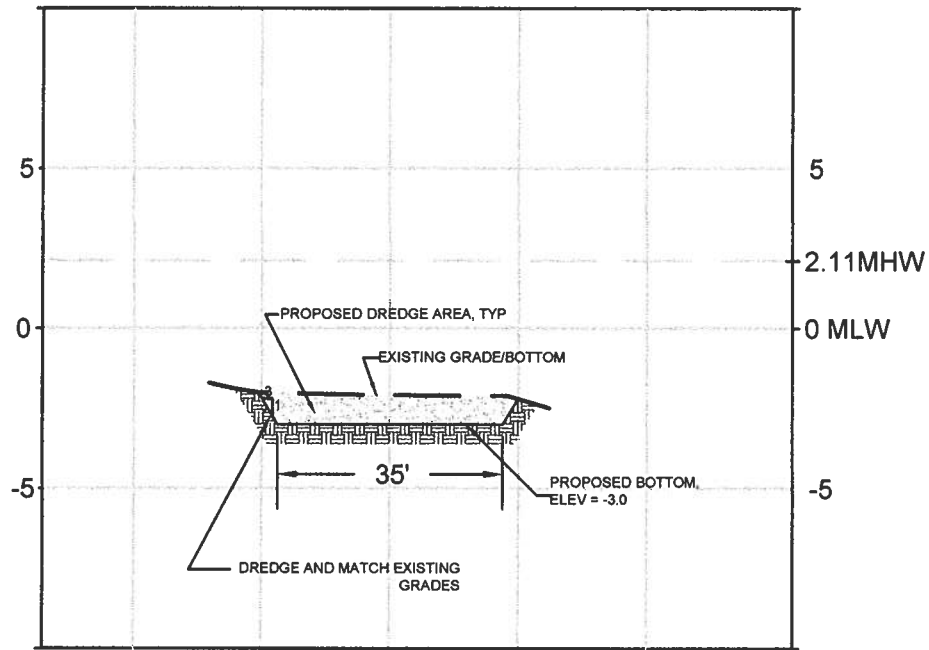

SECTION B-B

SCALE: H: 1"=30'  
V: 1"=6'

**MURRAY RESIDENCE  
PROPOSED MAINTENANCE DREDGING  
12628 SHEFFIELD ROAD  
WEST OCEAN CITY**

APPLICANT:  
MICHAEL T. KARSNITZ  
12620 SHEFFIELD ROAD  
WEST OCEAN CITY, MD 21842

LOCATION: CAPE ISLE OF WIGHT  
WATERWAY: UNNAMED CANAL ON CAPE ISLE OF WIGHT  
WATER DEPTH MEASUREMENTS: 11/14/2022  
REFERENCED TO MLW 11:45 a.m.

NO SAV'S  
TAX MAP: 21  
PARCEL: 8  
SECTION: A  
BLOCK: 11  
LOT: 16

COPYRIGHT © 2022

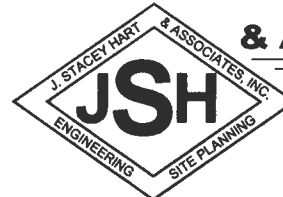

**J. STACEY HART  
& ASSOCIATES, INC.**

POST OFFICE BOX 6  
SNOW HILL, MD 21863  
PHONE: 410-390-8096  
EMAIL: [stacey@jstaceyhart.com](mailto:stacey@jstaceyhart.com)

JOB NUMBER: P22-032	SCALE: AS NOTED	SHEET NO: 3 of 3	DATE: 12/2022	REVISED: n/a
------------------------	--------------------	---------------------	------------------	-----------------



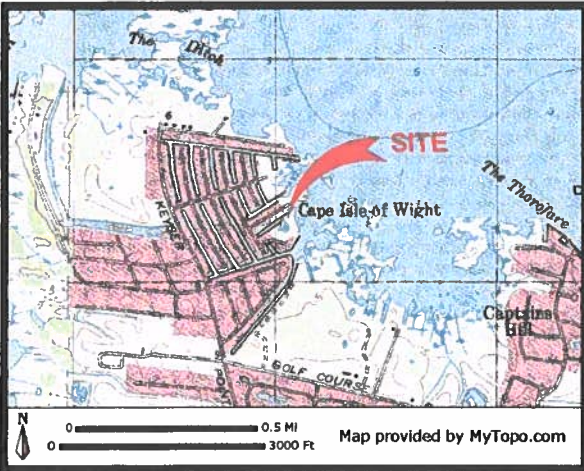

**PROJECT DESCRIPTION:**  
 MAINTENANCE/SPOT DREDGE A 35x40 (1,400 SF) AREA UNDER AN EXISTING BOAT LIFT AND DOUBLE PWC FLOAT TO A -3.0 MLW AND TRANSPORT ~95 C.Y. OF SPOIL IN WATERTIGHT TRUCKS TO AN APPROVED UPLAND SPOIL SITE.

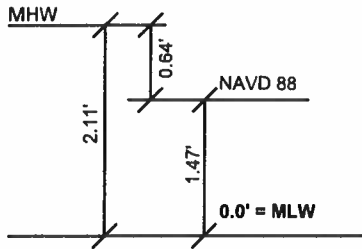

**DATUM COMPARISONS**  
 SCALE: NONE

DATUM COMPARISONS WERE OBTAINED FROM NATIONAL OCEANIC AND ATMOSPHERIC ADMINISTRATION (NOAA) INFORMATION INTERPOLATED FROM STATION ID# 8570283 - PID: HU0267.

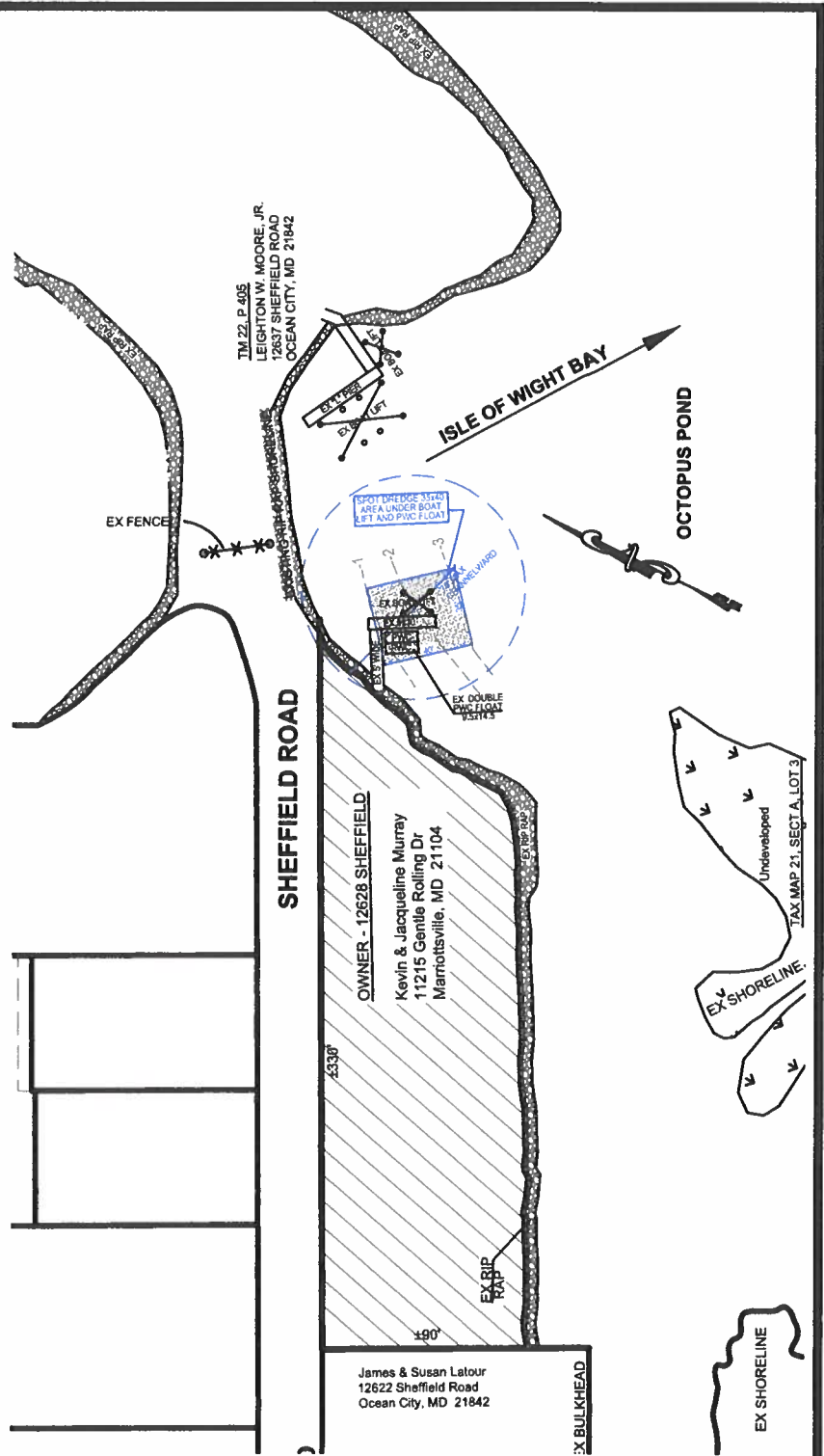

**MURRAY RESIDENCE  
 PROPOSED MAINTENANCE DREDGING  
 12628 SHEFFIELD ROAD  
 WEST OCEAN CITY**

**APPLICANT:**  
 MICHAEL T. KARSNITZ  
 12620 SHEFFIELD ROAD  
 WEST OCEAN CITY, MD 21842

**LOCATION:** CAPE ISLE OF WIGHT  
**WATERWAY:** UNNAMED CANAL ON CAPE ISLE OF WIGHT  
**WATER DEPTH MEASUREMENTS:** 11/14/2022  
 REFERENCED TO MLW 11:45 a.m.

NO SAVS

TAX MAP: 21  
 PARCEL: 8  
 SECTION: A  
 BLOCK: 11  
 LOT: 16

<b>JOB NUMBER:</b> P22-032	<b>SCALE:</b> 1"=80'	<b>SHEET NO.:</b> 1 of 3	<b>DATE:</b> 12/2022	<b>REVISED:</b> 2/6/2023
-------------------------------	-------------------------	-----------------------------	-------------------------	-----------------------------

COPYRIGHT © 2022

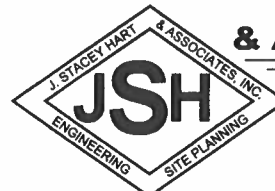

**J. STACEY HART & ASSOCIATES, INC.**

POST OFFICE BOX 6  
 SNOW HILL, MD 21863  
 PHONE: 410-390-8096  
 EMAIL: [stacey@jstaceyhart.com](mailto:stacey@jstaceyhart.com)

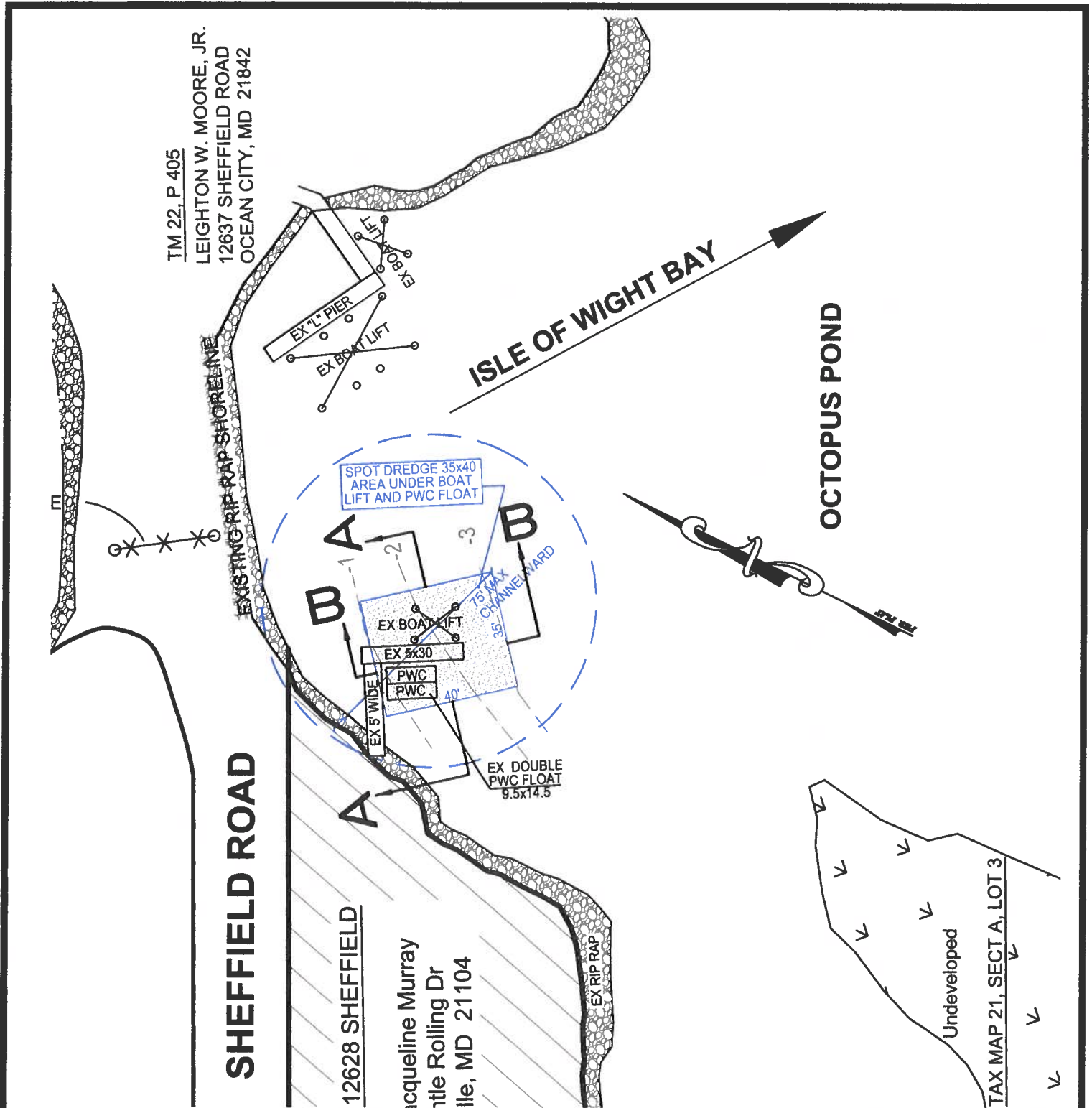

TM 22, P 405  
 LEIGHTON W. MOORE, JR.  
 12637 SHEFFIELD ROAD  
 OCEAN CITY, MD 21842

ISLE OF WIGHT BAY

OCTOPUS POND

SHEFFIELD ROAD

12628 SHEFFIELD

acqueline Murray  
 tle Rolling Dr  
 ile, MD 21104

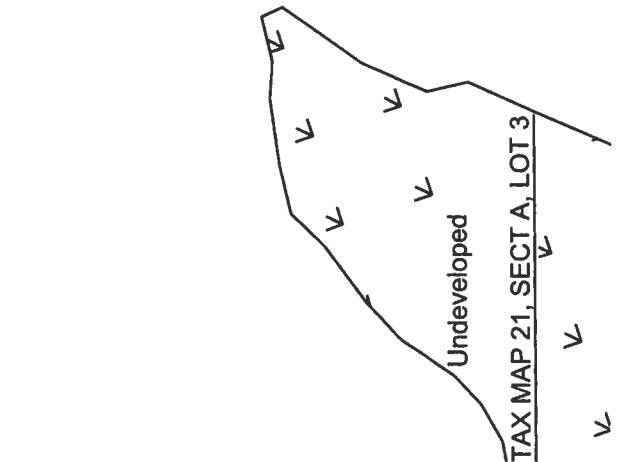

**MURRAY RESIDENCE  
 PROPOSED MAINTENANCE DREDGING  
 12628 SHEFFIELD ROAD  
 WEST OCEAN CITY**

APPLICANT:  
 MICHAEL T. KARSNITZ  
 12620 SHEFFIELD ROAD  
 WEST OCEAN CITY, MD 21842

LOCATION: CAPE ISLE OF WIGHT  
 WATERWAY: UNNAMED CANAL ON CAPE ISLE OF WIGHT  
 WATER DEPTH MEASUREMENTS: 11/14/2022  
 REFERENCED TO MLW 11:45 a.m.

NO SAV'S

TAX MAP: 21  
 PARCEL: 8  
 SECTION: A  
 BLOCK: 11  
 LOT: 16

JOB NUMBER: P22-032	SCALE: 1"=40'	SHEET NO: 2 of 3	DATE: 12/2022	REVISED: 2/6/2023
------------------------	------------------	---------------------	------------------	----------------------

COPYRIGHT © 2022

**J. STACEY HART & ASSOCIATES, INC.**

POST OFFICE BOX 6  
 SNOW HILL, MD 21863  
 PHONE: 410-390-8096  
 EMAIL: [stacey@jstaceyhart.com](mailto:stacey@jstaceyhart.com)

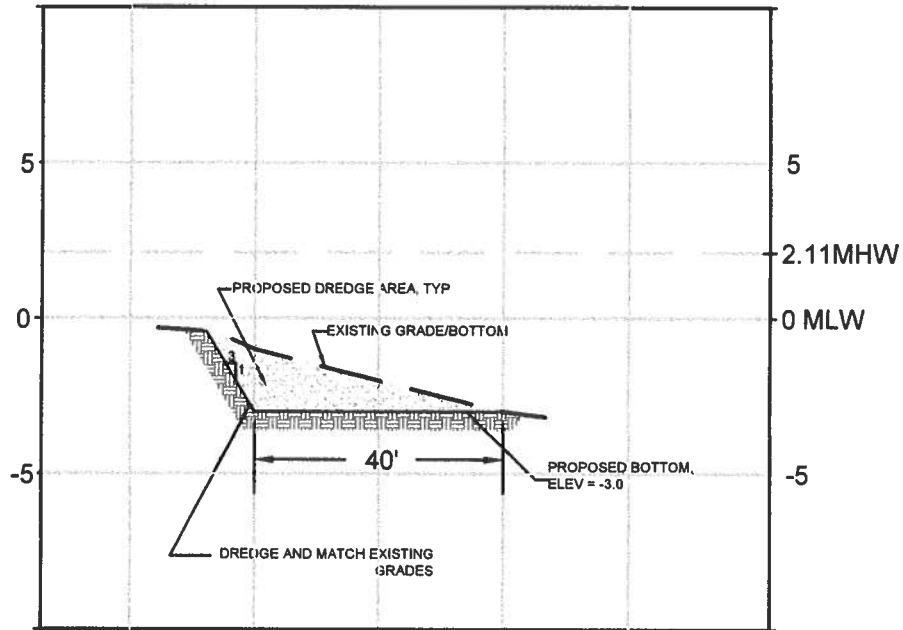

SECTION A-A

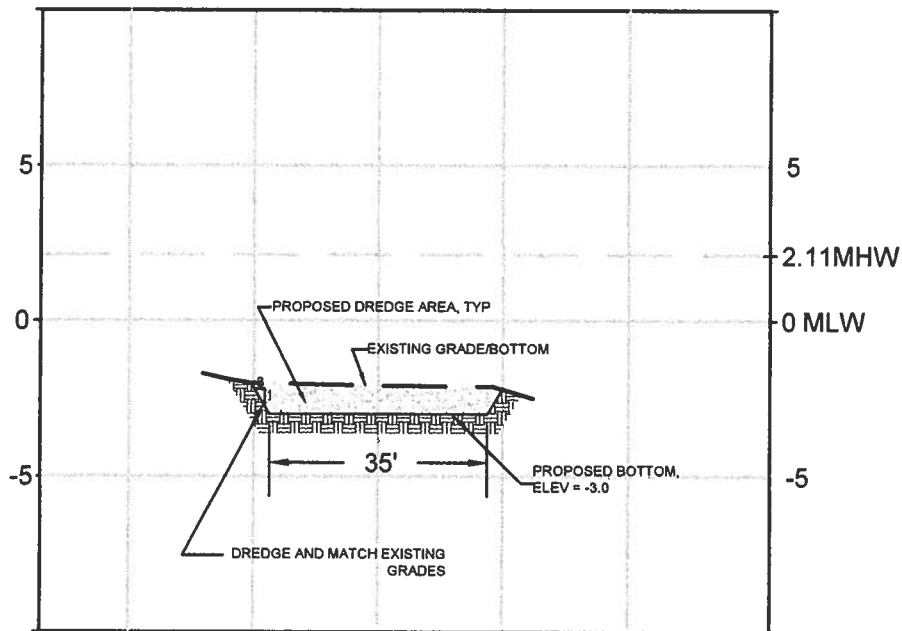

SECTION B-B

SCALE: H: 1"=30'  
V: 1"=6'

**MURRAY RESIDENCE  
PROPOSED MAINTENANCE DREDGING  
12628 SHEFFIELD ROAD  
WEST OCEAN CITY**

APPLICANT:  
MICHAEL T. KARSNITZ  
12620 SHEFFIELD ROAD  
WEST OCEAN CITY, MD 21842

LOCATION: CAPE ISLE OF WIGHT  
WATERWAY: UNNAMED CANAL ON CAPE ISLE OF WIGHT  
WATER DEPTH MEASUREMENTS: 11/14/2022  
REFERENCED TO MLW 11:45 a.m.

NO SAV'S

TAX MAP: 21  
PARCEL: 8  
SECTION: A  
BLOCK: 11  
LOT: 18

COPYRIGHT © 2022

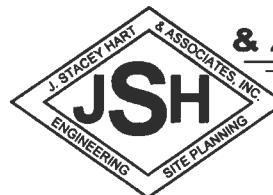

**J. STACEY HART  
& ASSOCIATES, INC.**

POST OFFICE BOX 6  
SNOW HILL, MD 21863  
PHONE: 410-390-8096  
EMAIL: [stacey@jstaceyhart.com](mailto:stacey@jstaceyhart.com)

JOB NUMBER: P22-032	SCALE: AS NOTED	SHEET NO: 3 of 3	DATE: 12/2022	REVISED: n/a
------------------------	--------------------	---------------------	------------------	-----------------



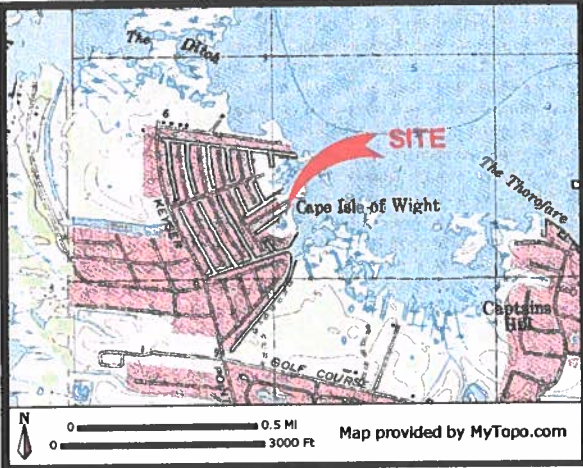

**PROJECT DESCRIPTION:**  
 MAINTENANCE/SPOT DREDGE A 35x40 (1,400 SF) AREA UNDER AN EXISTING BOAT LIFT AND DOUBLE PWC FLOAT TO A -3.0 MLW AND TRANSPORT ~95 C.Y. OF SPOIL IN WATERTIGHT TRUCKS TO AN APPROVED UPLAND SPOIL SITE.

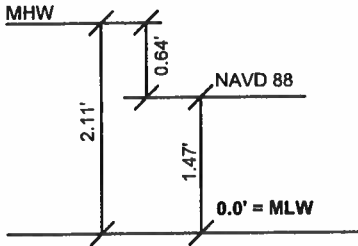

**DATUM COMPARISONS**  
 SCALE: NONE

DATUM COMPARISONS WERE OBTAINED FROM NATIONAL OCEANIC AND ATMOSPHERIC ADMINISTRATION (NOAA) INFORMATION INTERPOLATED FROM STATION ID# 8570283 - PID: HU0267.

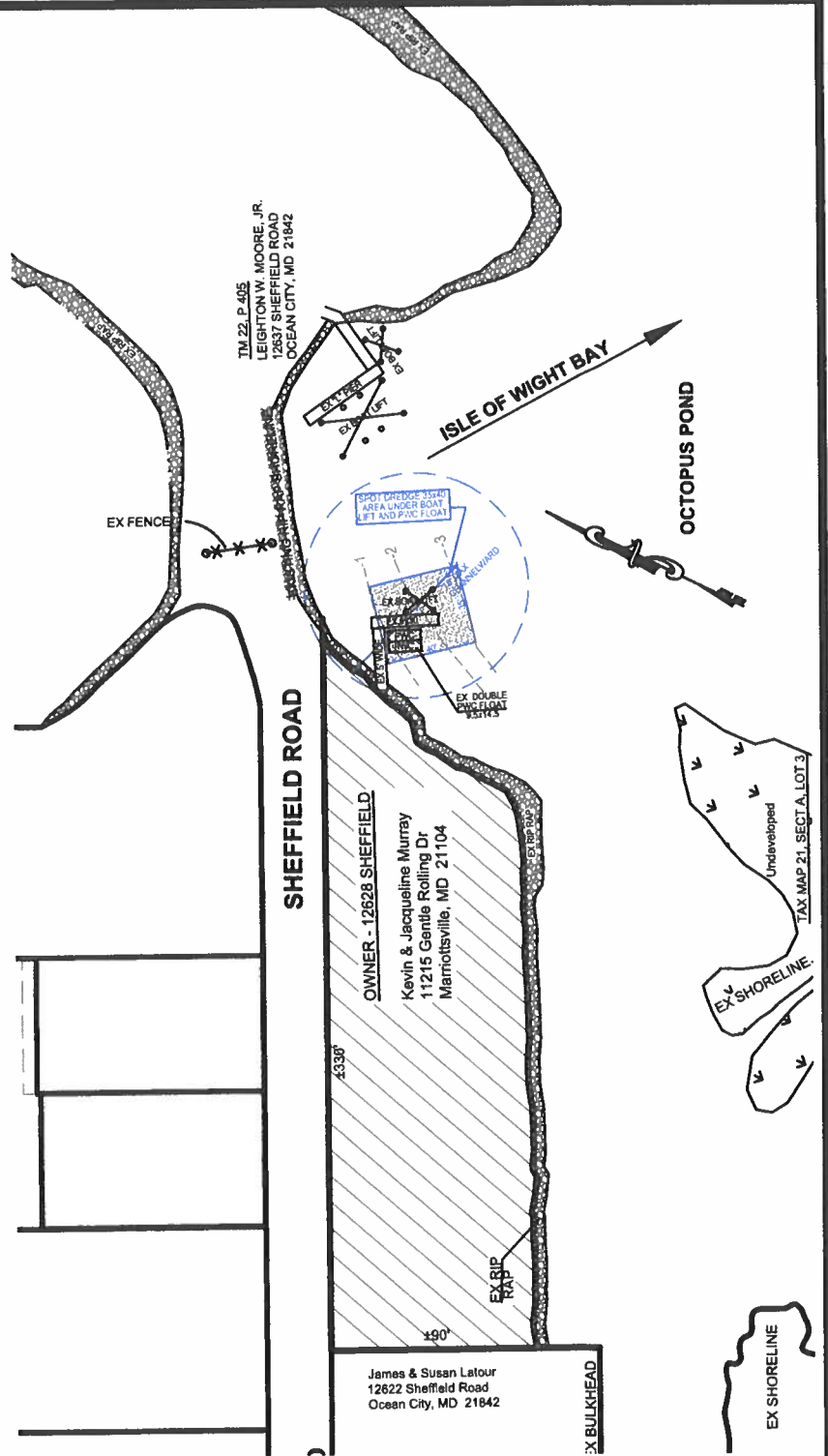

**MURRAY RESIDENCE  
 PROPOSED MAINTENANCE DREDGING  
 12628 SHEFFIELD ROAD  
 WEST OCEAN CITY**

**APPLICANT:**  
 MICHAEL T. KARSNITZ  
 12620 SHEFFIELD ROAD  
 WEST OCEAN CITY, MD 21842

**LOCATION:** CAPE ISLE OF WIGHT  
**WATERWAY:** UNNAMED CANAL ON CAPE ISLE OF WIGHT  
**WATER DEPTH MEASUREMENTS:** 11/14/2022  
 REFERENCED TO MLW 11:45 a.m.

**NO SAVS**

**TAX MAP:** 21  
**PARCEL:** 8  
**SECTION:** A  
**BLOCK:** 11  
**LOT:** 16

COPYRIGHT © 2022



**J. STACEY HART  
 & ASSOCIATES, INC.**

<b>JOB NUMBER:</b> P22-032	<b>SCALE:</b> 1"=80'	<b>SHEET NO.:</b> 1 of 3	<b>DATE:</b> 12/2022	<b>REVISED:</b> 2/6/2023
-------------------------------	-------------------------	-----------------------------	-------------------------	-----------------------------

**POST OFFICE BOX 6  
 SNOW HILL, MD 21863  
 PHONE: 410-390-8096  
 EMAIL: stacey@jstaceyhart.com**

TM 22, P 405  
 LEIGHTON W. MOORE, JR.  
 12637 SHEFFIELD ROAD  
 OCEAN CITY, MD 21842

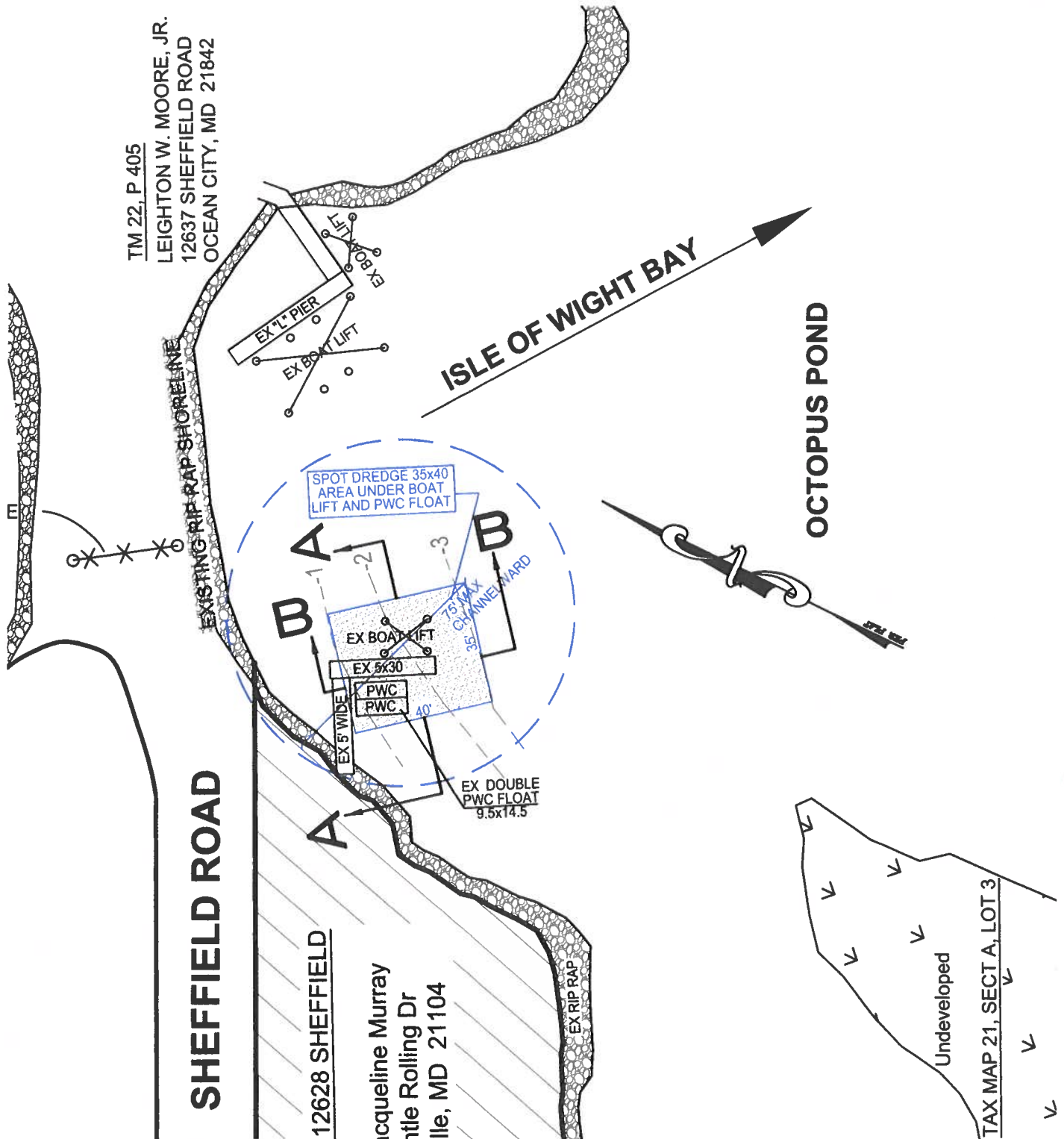

**MURRAY RESIDENCE  
 PROPOSED MAINTENANCE DREDGING  
 12628 SHEFFIELD ROAD  
 WEST OCEAN CITY**

APPLICANT:  
 MICHAEL T. KARSNITZ  
 12620 SHEFFIELD ROAD  
 WEST OCEAN CITY, MD 21842

LOCATION: CAPE ISLE OF WIGHT  
 WATERWAY: UNNAMED CANAL ON CAPE ISLE OF WIGHT  
 WATER DEPTH MEASUREMENTS: 11/14/2022  
 REFERENCED TO MLW 11:45 a.m.

NO SAV'S  
 TAX MAP: 21  
 PARCEL: 8  
 SECTION: A  
 BLOCK: 11  
 LOT: 16

JOB NUMBER: P22-032	SCALE: 1"=40'	SHEET NO: 2 of 3	DATE: 12/2022	REVISED: 2/6/2023
------------------------	------------------	---------------------	------------------	----------------------

COPYRIGHT © 2022

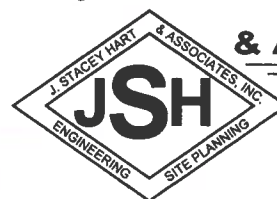

**J. STACEY HART  
 & ASSOCIATES, INC.**

POST OFFICE BOX 6  
 SNOW HILL, MD 21863  
 PHONE: 410-390-8096  
 EMAIL: [stacey@jstaceyhart.com](mailto:stacey@jstaceyhart.com)

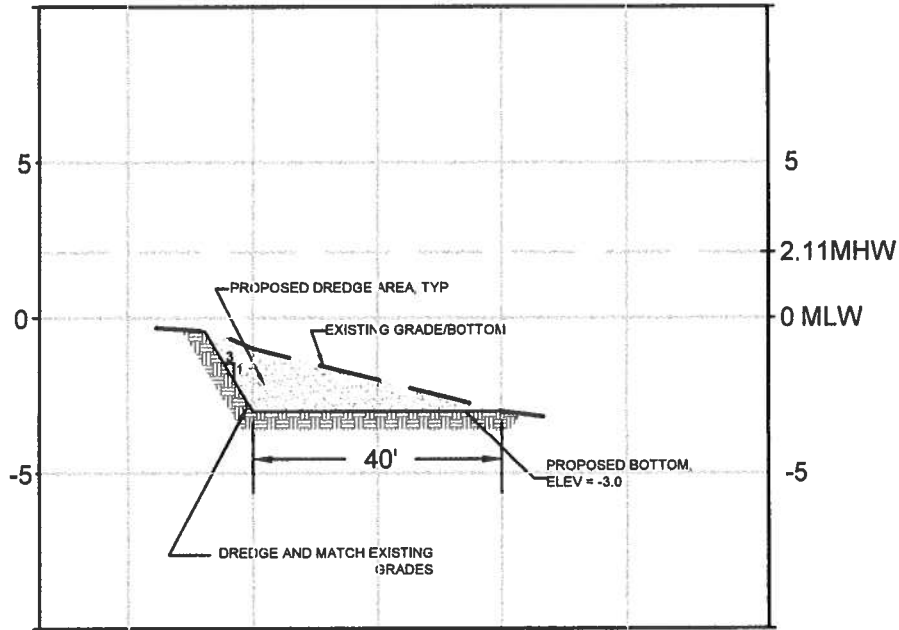

SECTION A-A

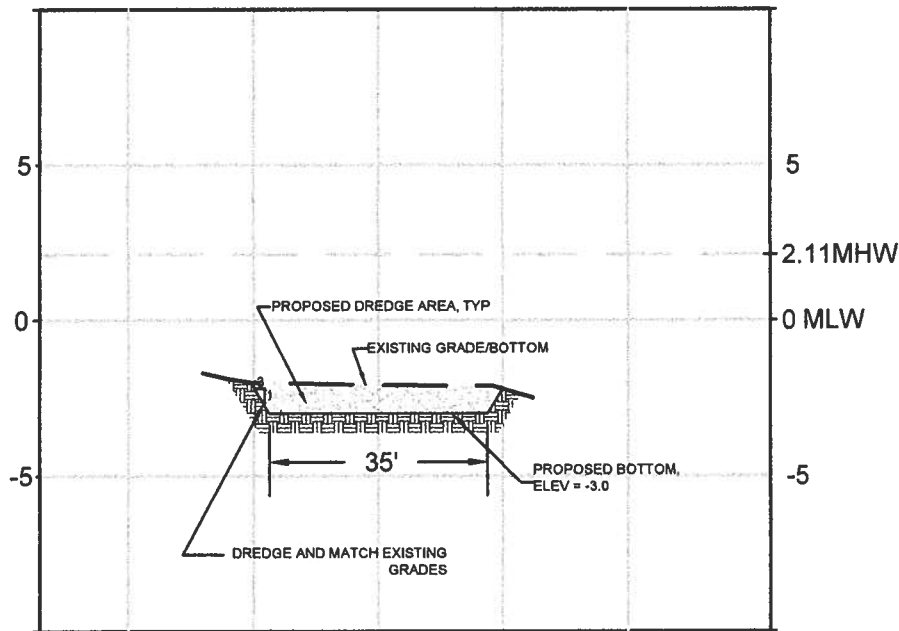

SECTION B-B

SCALE: H: 1"=30'  
V: 1"=6'

**MURRAY RESIDENCE  
PROPOSED MAINTENANCE DREDGING  
12628 SHEFFIELD ROAD  
WEST OCEAN CITY**

APPLICANT:  
MICHAEL T. KARSNITZ  
12620 SHEFFIELD ROAD  
WEST OCEAN CITY, MD 21842

LOCATION: CAPE ISLE OF WIGHT  
WATERWAY: UNNAMED CANAL ON CAPE ISLE OF WIGHT  
WATER DEPTH MEASUREMENTS: 11/14/2022  
REFERENCED TO MLW 11:45 a.m.

NO SAV'S

TAX MAP: 21  
PARCEL: 8  
SECTION: A  
BLOCK: 11  
LOT: 16

COPYRIGHT © 2022

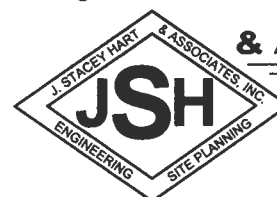

**J. STACEY HART  
& ASSOCIATES, INC.**

POST OFFICE BOX 6  
SNOW HILL, MD 21863  
PHONE: 410-390-8096  
EMAIL: [stacey@jstaceyhart.com](mailto:stacey@jstaceyhart.com)

JOB NUMBER: P22-032	SCALE: AS NOTED	SHEET NO: 3 of 3	DATE: 12/2022	REVISED: n/a
------------------------	--------------------	---------------------	------------------	-----------------



