



DEPARTMENT OF  
ENVIRONMENTAL PROGRAMS

## Worcester County

GOVERNMENT CENTER  
ONE WEST MARKET STREET, ROOM 1306  
SNOW HILL, MARYLAND 21863  
TEL: 410.632.1220 / FAX: 410.632.2012

LAND PRESERVATION PROGRAM  
STORMWATER MANAGEMENT  
SEDIMENT AND EROSION CONTROL  
SHORELINE CONSTRUCTION  
AGRICULTURAL PRESERVATION  
ADVISORY BOARD

WELL & SEPTIC  
WATER & SEWER PLANNING  
PLUMBING & GAS  
CRITICAL AREAS/FORESTRY  
COMMUNITY HYGIENE

May 18, 2023

This notification is to advise you that the Department has received and is presently reviewing the following request for a shoreline construction project:

John & Starla Hudacheck – Request No. 2023-054 – Request to install one boat lift and two PWC lifts with associated pilings. Maximum channelward extension of 21'. This project is located at 6 Harlan Trace, Berlin, also known as Tax Map 16, Parcel 96, Lot 7. Third Tax District of Worcester County, Maryland.

The Department in considering this application will make specific findings of fact with regard to the environmental impact, navigational impact, recreational potential, commercial benefit to Worcester County, impact of the proposed construction upon the surrounding neighborhood and upon property values therein, and any other pertinent issues. Approval from the Department does not guarantee approval from any other applicable regulatory agencies.

**If you have an interest which may be adversely affected by the issuance of this permit, you are requested to notify this Department in writing within fifteen (15) calendar days which will end on June 2, 2023.**

Sincerely,

Brandy Whitlock  
Environmental Inspector

cc: Interested Parties  
David Bradford, Deputy Director  
File



WORCESTER COUNTY  
SHORELINE CONSTRUCTION  
APPLICATION

Request No.: 2023-054  
Submission Date: 5-18-23

XX Major Construction (\$300.00)

Minor Construction (\$150.00)

**Written Description of Proposed Improvement (include channelward distance):**

install one (1) boat lift and two (2) PWC lifts with associated pilings a maximum of 21' channelward of  
existing bulkhead/MHW/MLW

**Property Description:**

Map: 16 Parcel: 96 Lot: 7 Section: 14B Block: \_\_\_\_\_ Tax District: 3

Street Address: 6 Harlan Trace

Subdivision: Ocean Pines

Dwelling on lot: XX Dwelling under construction: \_\_\_\_\_ Vacant: \_\_\_\_\_ Commercial: \_\_\_\_\_

Owner: John & Starla Hudacheck Phone No. 410-292-4094

Mailing Address: 6 Harlan Trace, Ocean Pines, MD 21811

E-Mail Address: jhudacheck@hotmail.com

Contractor: J. Stacey Hart & Associates, Inc. Phone No.: 410-390-8096

Mailing Address: PO Box 6, Snow Hill, MD 21863

E-Mail Address: stacey@jstaceyhart.com

**Recorded Adjacent Property Owner: Jeffrey & Susan Adkins**

Property Address: 4 Harlan Trace, Ocean Pines, MD 21811

Tax Map: 16 Parcel: 96 Lot: 6 Section: 14B Block: \_\_\_\_\_

**Recorded Adjacent Property Owner: Laya Kahnamaui & Behrad Ashayeri**

Property Address: 8 Harlan Trace, Ocean Pines, MD 21811 -10113 New London Dr. Potomac, MD  
Tax Map: 16 Parcel: 96 Lot: 8 Section: 14B Block: \_\_\_\_\_ 20854

As the applicant, I attest that the information presented on this application, site plan and any written documentation attached hereto is known to be accurate. I understand that the proposed shoreline improvement will be constructed to meet or exceed minimum design standards adopted by the Department. Any deviation from these standards will require construction plans sealed by an engineer registered in the State of Maryland. I acknowledge that any falsification of information presented may result in revocation of this approval and of the subsequent Shoreline Construction Permit.

John Hudacheck 5/5/2023  
\_\_\_\_\_  
Owner/Applicant's Signature Date

\*\*\*\*\*

**DEPT. USE ONLY:**

Notification Distribution Date: 5-18-23 Public Comment Deadline: 6-2-23 (15 calendar days)

Department Approval Date: \_\_\_\_\_ Expiration: \_\_\_\_\_



**PROPOSED**

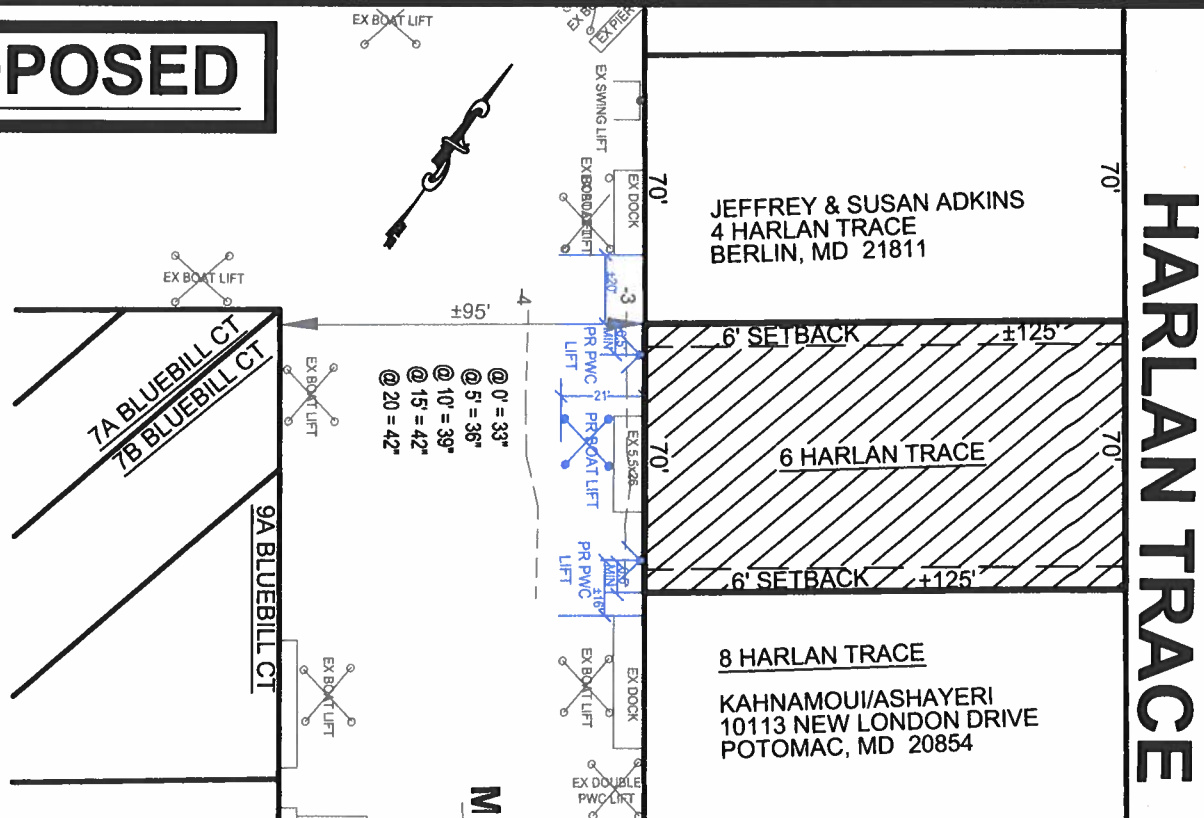

LIFT SECTION: NO SCALE

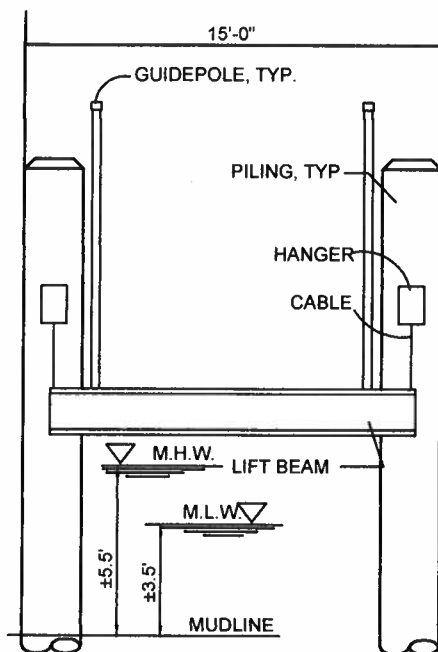

PWC LIFT SECTION: NO SCALE

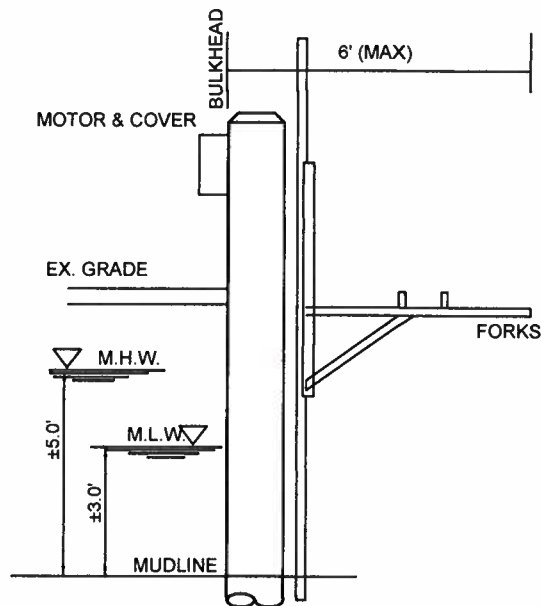

HUDACHEK RESIDENCE  
PROPOSED MARINE IMPROVEMENTS  
6 HARLAN TRACE  
OCEAN PINES

**APPLICANT:** John & Starla Hudachek  
6 Harlan Trace  
Ocean Pines, MD 21811  
jhudachek@hotmail.com  
410-292-4094

LOCATION: 4 HARLAN TRACE - SECTION 14B

WATERWAY: MANKLIN CREEK

WATER DEPTH MEASUREMENTS: 10/17/2017  
REFERENCED TO MLW 4:40 P.M.

NO SAV'S

TAX MAP: 16  
PARCEL: 96  
SECTION: 14B  
LOT: 7

JOB NUMBER:  
P17-046

SCALE:  
1"=50'

SHEET NO:  
2 of 2

DATE:  
05/2023

REVISED:  
N/A

COPYRIGHT © 2023

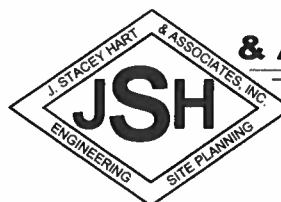

**J. STACEY HART  
& ASSOCIATES, INC.**

POST OFFICE BOX 6  
SNOW HILL, MD 21863  
PHONE: 410-390-8096  
EMAIL: [stacey@jstaceyhart.com](mailto:stacey@jstaceyhart.com)



