



DEPARTMENT OF  
ENVIRONMENTAL PROGRAMS

**Worcester County**

GOVERNMENT CENTER  
ONE WEST MARKET STREET, ROOM 1306  
SNOW HILL, MARYLAND 21863  
TEL: 410.632.1220 / FAX: 410.632.2012

LAND PRESERVATION PROGRAM  
STORMWATER MANAGEMENT  
SEDIMENT AND EROSION CONTROL  
SHORELINE CONSTRUCTION  
AGRICULTURAL PRESERVATION  
ADVISORY BOARD

WELL & SEPTIC  
WATER & SEWER PLANNING  
PLUMBING & GAS  
CRITICAL AREAS/FORESTRY  
COMMUNITY HYGIENE

June 10, 2024

This notification is to advise you that the Department has received and is presently reviewing the following request for a shoreline construction project:

Lori Disney– Request No. 2024-053 - Request to install one boat lift with associated pilings and one 12x16 float within deeded boatslip. Maximum channelward extension 65' This project is located at 12 Marsh Harbour, Ocean City, also known as Tax map 27, Parcel 654, Slip 12. Tenth Tax District of Worcester County, Maryland.

The Department in considering this application will make specific findings of fact with regard to the environmental impact, navigational impact, recreational potential, commercial benefit to Worcester County, impact of the proposed construction upon the surrounding neighborhood and upon property values therein, and any other pertinent issues. Approval from the Department does not guarantee approval from any other applicable regulatory agencies.

**If you have an interest which may be adversely affected by the issuance of this permit, you are requested to notify this Department in writing within fifteen (15) calendar days which will end on June 25, 2024.**

Sincerely,

Brandy Whitlock  
Environmental Inspector

cc: Interested Parties  
David Bradford, Deputy Director  
File



WORCESTER COUNTY
SHORELINE CONSTRUCTION
APPLICATION

Request No.: 2024-053
Submission Date: 6-10-24

X Major Construction (\$300.00) Minor Construction (\$150.00)

Written Description of Proposed Improvement (include channelward distance):

install one (1) boat lift with associated pilings and one (1) 12x16 float within the deeded boat slip a maximum of 65' channelward of existing MHW; boat lift will not exceed existing pier

Property Description:

Map: 27 Parcel: 654 Lot: 12 Section: Block: Tax District: 10
Street Address: 12 Marsh Harbour
Subdivision: Marsh Harbour Marina
 Dwelling on lot: Dwelling under construction: Vacant: Commercial: X

Owner: Lori R. Disney Phone No. 410-430-8360
Mailing Address: 1916 Kipling Drive, Salisbury, MD 21801
E-Mail Address: disneyprop@gmail.com

Contractor: J. Stacey Hart & Associates, Inc. Phone No.: 410-390-8096
Mailing Address: PO Box 6, Snow Hill, MD 21863
E-Mail Address: stacey@jstaceyhart.com

Recorded Adjacent Property Owner: Bryan & Tracy Tilghman - slip 11
Property Address: 12818 West Hopetown Lane, A14, West OC, MD 21842
Tax Map: 27 Parcel: 654 Lot: 11 Section: Block:

Recorded Adjacent Property Owner: Reese F. Cropper, III - slip 13
Property Address: 9501 Abaco Lane, Ocean City, MD 21842
Tax Map: 27 Parcel: 654 Lot: 13 Section: Block:

As the applicant, I attest that the information presented on this application, site plan and any written documentation attached hereto is known to be accurate. I understand that the proposed shoreline improvement will be constructed to meet or exceed minimum design standards adopted by the Department. Any deviation from these standards will require construction plans sealed by an engineer registered in the State of Maryland. I acknowledge that any falsification of information presented may result in revocation of this approval and of the subsequent Shoreline Construction Permit.

Handwritten signature of Lori R. Disney and date 5/10/24 with a red arrow pointing to the signature line.

\*\*\*\*\*

DEPT. USE ONLY:

Notification Distribution Date: 6-10-24 Public Comment Deadline: 6-25-24 (15 calendar days)
Department Approval Date: Expiration:

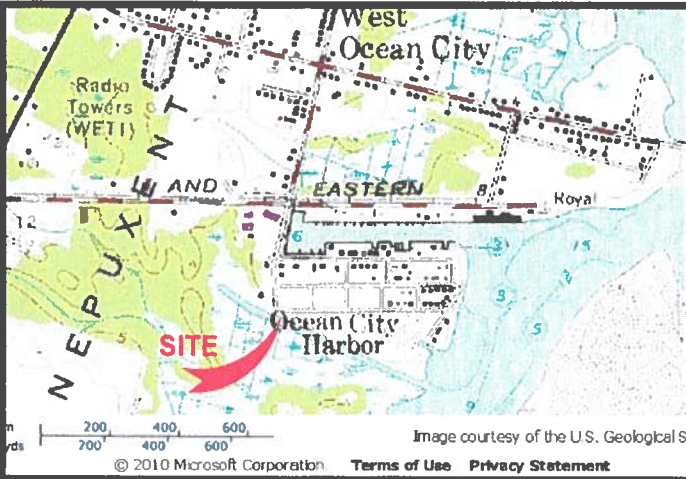

**PROJECT DESCRIPTION:**

Install one (1) boat lift with associated pilings and install one (1) 12x16 (200 sf max) float within the deeded slip a maximum of 65 feet channelward of approximate MHW. Boat lift not to extend past existing pier.

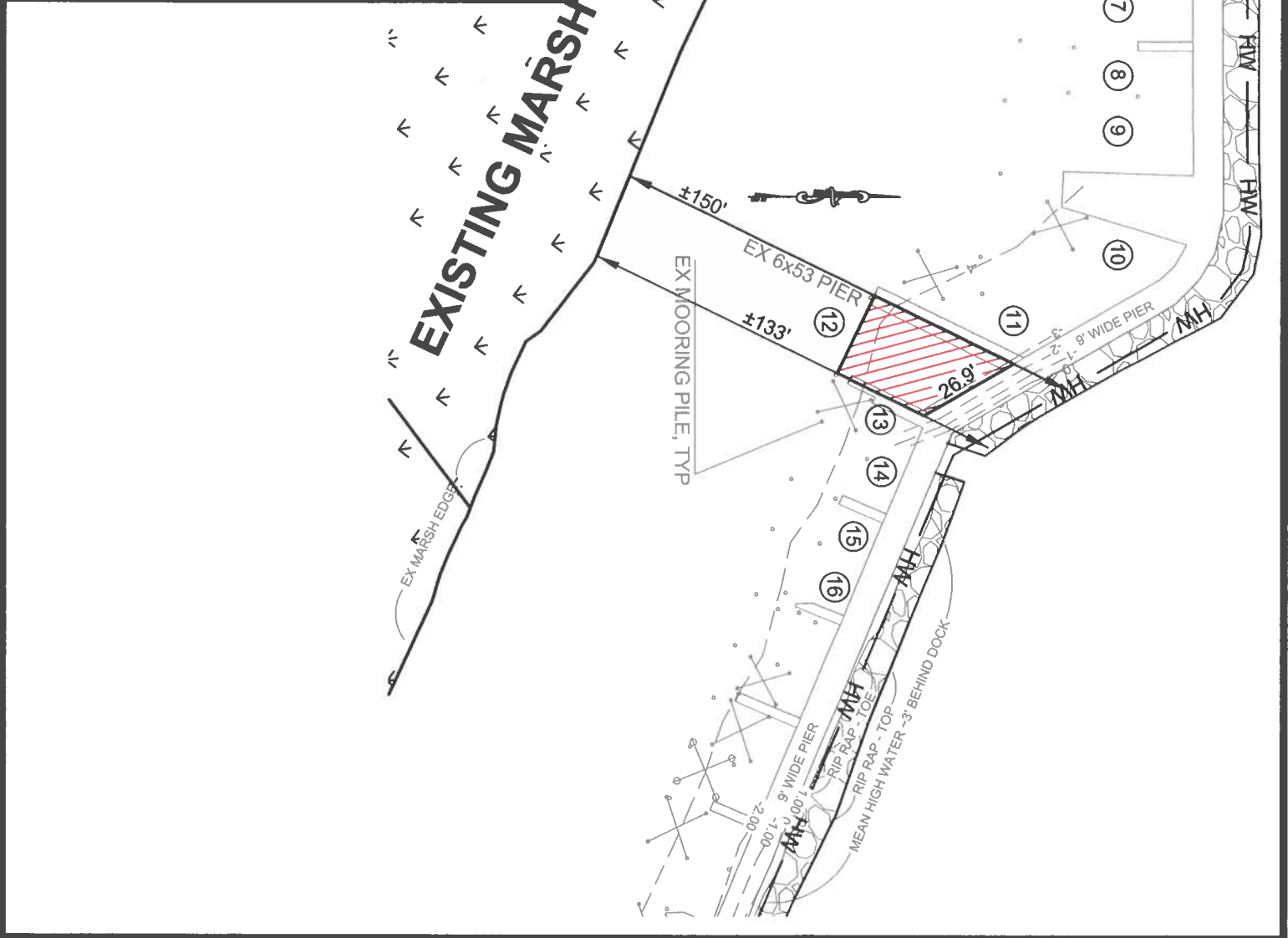

**DISNEY BOAT SLIP #12  
PROPOSED BOAT LIFT & FLOAT  
MARSH HARBOUR  
WEST OCEAN CITY**

**APPLICANT:**  
Lori R. Disney  
1916 Kipling Drive  
Salisbury, MD 21801  
disneyprop@gmail.com  
410-430-8360

**LOCATION:** MARSH HARBOUR MARINA  
**WATERWAY:** SINEPUXENT BAY  
**WATER DEPTH MEASUREMENTS:** 5/17/2024  
REFERENCED TO MLW 11:00 A.M.

NO SAVS

TAX MAP: 27  
GRID: 14  
PARCEL: 654  
SLIP: 12

COPYRIGHT © 2024

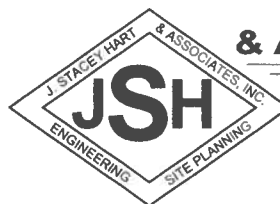

**J. STACEY HART  
& ASSOCIATES, INC.**

POST OFFICE BOX 6  
SNOW HILL, MD 21863  
PHONE: 410-390-8096  
EMAIL: stacey@jstaceyhart.com

<b>JOB NUMBER:</b> P24-023	<b>SCALE:</b> 1"=50'	<b>SHEET NO.:</b> 1 of 2	<b>DATE:</b> 6/3/2024	<b>REVISED:</b> N/A
-------------------------------	-------------------------	-----------------------------	--------------------------	------------------------

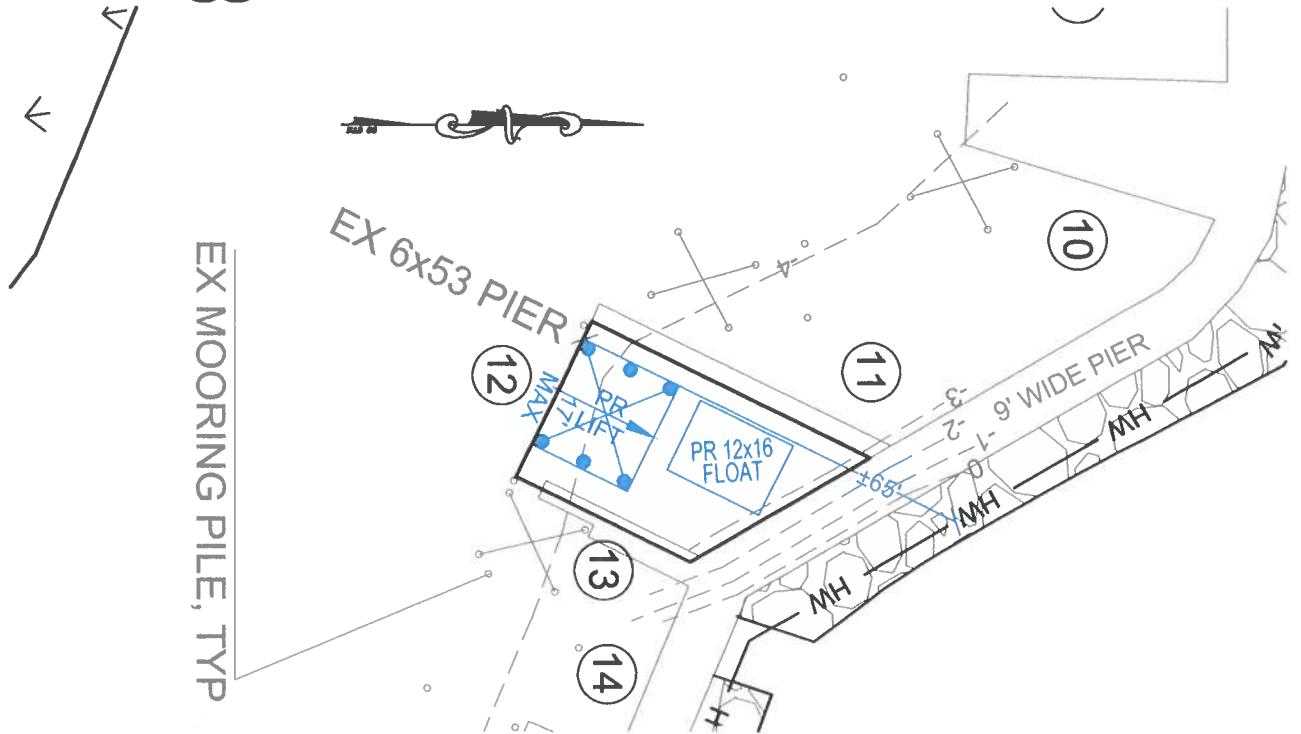
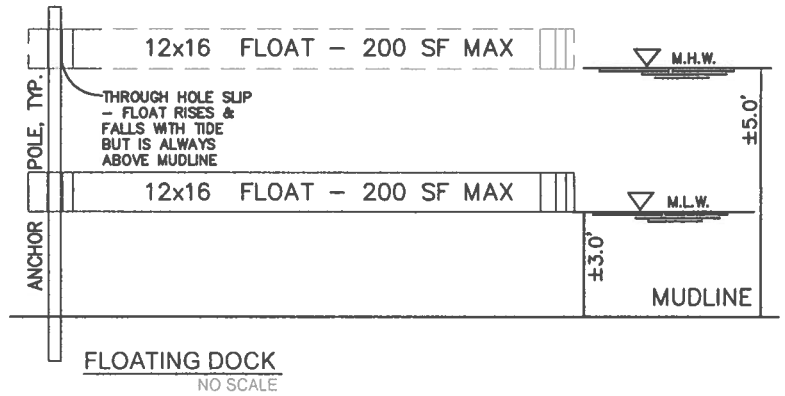
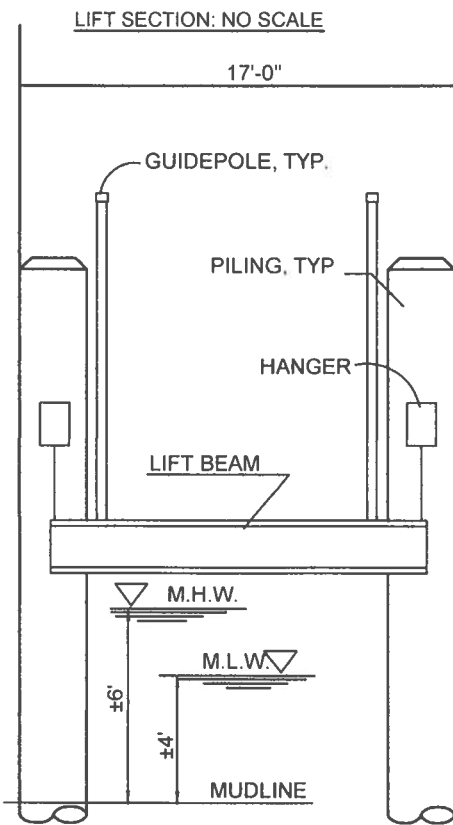

**DISNEY BOAT SLIP #12  
PROPOSED BOAT LIFT & FLOAT  
MARSH HARBOUR  
WEST OCEAN CITY**

**APPLICANT:**  
Lori R. Disney  
1916 Kipling Drive  
Salisbury, MD 21801  
disneyprop@gmail.com  
410-430-8360

**LOCATION:** MARSH HARBOUR MARINA  
**WATERWAY:** SINEPUXENT BAY  
**WATER DEPTH MEASUREMENTS:** 5/17/2024  
REFERENCED TO MLW 11:00 A.M.

NO SAV'S

TAX MAP: 27  
GRID: 14  
PARCEL: 654  
SLIP: 12

COPYRIGHT © 2024

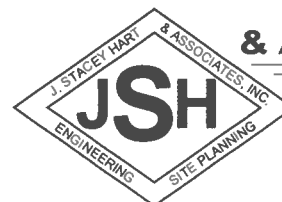

**J. STACEY HART  
& ASSOCIATES, INC.**

POST OFFICE BOX 6  
SNOW HILL, MD 21863  
PHONE: 410-390-8096  
EMAIL: [stacey@jstaceyhart.com](mailto:stacey@jstaceyhart.com)

<b>JOB NUMBER:</b> P24-023	<b>SCALE:</b> 1"=30'	<b>SHEET NO.:</b> 2 of 2	<b>DATE:</b> 6/3/2024	<b>REVISED:</b> N/A
-------------------------------	-------------------------	-----------------------------	--------------------------	------------------------

